

VICOR CONFIDENTIAL

THIS DOCUMENT AND THE DATA DISCLOSED HEREIN OR HEREWITH IS NOT TO BE REPRODUCED, USED, OR DISCLOSED IN WHOLE OR IN PART TO ANYONE WITHOUT PERMISSION OF VICOR CORP.

REV.	DESCRIPTION	DATE	APPROVED
03	REVSD & REDWN PER E950112 DPK	4/5/95	RCM

## ELECTRICAL CHARACTERISTICS

RATED VOLTAGE:	250 VAC, 50/60 Hz
CAPACITANCE TOLERANCE:	± 10%
DISSIPATION FACTOR:	< 1% MEASURED AT 1 KHZ
MAXIMUM PULSE RISE TIME:	ACCORDING TO VDE 0565 PART 1 du/dt 100V / μSEC
DIELECTRIC:	POLYESTER-FILM
TEST VOLTAGE:	(ELECTRODE/ELECTRODE) 1075 V-, 2 SEC. (SELF HEALINGS ARE ALLOWED TO OCCUR)
INSULATION RESISTANCE:	FOR C ≤ .33μF 15000 MEGOHM MINIMUM VALUE
COATING:	PLASTIC CAN, EPOXY RESIN SEALED, FLAME RETARDANT

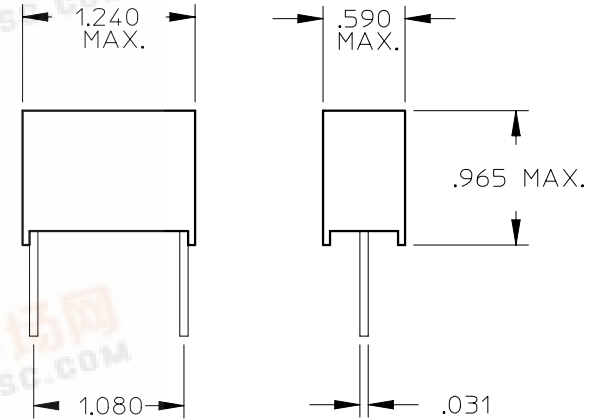

NOTES:

1. APPROVALS INCLUDE VDE, SEV, DEMKO, SEMKO, NEMKO, SETI, UL, IMQ, OVE.
2. LEADS ARE TINNED COPPER WIRE.

UNLESS OTHERWISE SPECIFIED DIMENSIONS ARE IN INCHES TOLERANCES ARE:

FRACTIONS	DECIMALS	ANGLES
± 1/64	.XX ± .01	± 1°
	.XXX ± .005	

THIRD ANGLE PROJECTION

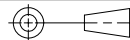

DO NOT SCALE DRAWING

APPROVALS	DATE				
DRAWN: D.P. KELLY	4/95				CAP, FLM, AXIAL, 1μF, ±10%/250V
		SIZE	FSCM NO.	DWG. NO.	REV.
		B	67131	02573	03
SCALE FULL				SHEET 1 OF 1	

