

REV.	ECH. NO.	REVISIONS	DRW. CKD.	APP.	DATE
A					
B					
C					
D		REDRAWN WITH CHANGES - NEW HSG AND LEAD POSITION CHARACTERISTIC 6-9 - CHANGE LED CHARACTERISTIC		YY	NO 3-7-94
E		ADDED HI. GREEN AND ALL INGP YELLOW AND CHANGE TO ANOTHER AIGAS REVERSE CHANGE NOTE 8		AV DC	NO 3-8-00
F		ADD .280 (BLUE) CORRECT HI.EFF. LED SPEC		AV DC	NO 10-10-00
G		ADDED NOTE 10		YIS JMC	10-14-03
H		UPDATED LED SPEC. FOR HI.EFF. RED, GREEN & YELLOW		YIS	

591-2001-002 供应商

捷多邦, 专业PCB打样工厂 24小时加急出货

LED COLOR = RED (AIGAS) GREEN (HI. INT.) YELLOW (ALL INGP)						
OPERATING CHARACTERISTICS AT 25°C AMBIENT						
CHARACTERISTICS	AIGAS RED	HI. INT. GREEN	ALL INGP YELLOW	MIN	TYP	MAX
LUMINOUS INTENSITY	23.9	9.1	33.6			mc/d
FORWARD VOLTAGE	1.8	2.4	2.1	2.6	V	I F = 20 mA
REVERSE VOLTAGE	5	5	5			V
DOMINANT WAVELENGTH	638	569	595			nm

LED COLOR = RED (AIGAS) GREEN (HI. INT.) YELLOW (ALL INGP)						
ABSOLUTE MAXIMUM RATING AT 25°C AMBIENT						
POWER DISSIPATION	R-G-Y	UNITS				
DERATE LINEARLY FROM 25°C	AIGAS RED	100				
	HI. INT. GREEN	0.8				
	ALL INGP YELLOW	0.6				
CONTINUOUS FORWARD CURRENT	AIGAS RED	40				
	HI. INT. GREEN	30				
	ALL INGP YELLOW	50				
PEAK FORWARD CURRENT (1/10 DUTY CYCLE, 0.1 ms PULSE WIDTH)	AIGAS RED	200				
	HI. INT. GREEN	120				
	ALL INGP YELLOW	160				
OPERATING TEMPERATURE	R-G-Y	-55 TO 100 °C				
STORAGE TEMPERATURE	R-G-Y	-55 TO 100 °C				
INFRARED REFLOW SOLDERING	R-G-Y	260°C FOR 5 SEC				
VAPOR PHASE SOLDERING	R-G-Y	215°C FOR 3 MIN				

LED COLOR = RED - GREEN - YELLOW						
OPERATING CHARACTERISTICS AT 25°C AMBIENT						
CHARACTERISTICS	RED	GREEN	YELLOW	MIN	TYP	MAX
LUMINOUS INTENSITY	5.6	9.8	14.0			14.0
FORWARD VOLTAGE	2.0	2.5	2.0	2.5	V	I F = 10 mA
REVERSE VOLTAGE	5	5	5			V
PEAK WAVELENGTH	635	572	586			nm
DOMINANT WAVELENGTH	622	628	634			nm

LED COLOR = HI. EFF. / RED - GREEN - YELLOW						
ABSOLUTE MAXIMUM RATING AT 25°C AMBIENT						
POWER DISSIPATION	RED	GREEN	YELLOW	UNITS		
	95	95	95	mW		
CONTINUOUS FORWARD CURRENT	30	30	30	mA		
OPERATING TEMPERATURE	R-G-Y	-40 TO 100		°C		
STORAGE TEMPERATURE	R-G-Y	-40 TO 100		°C		

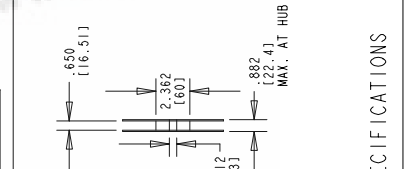
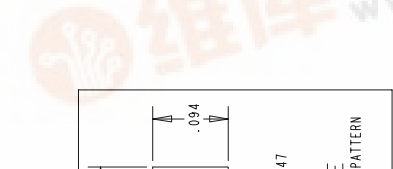
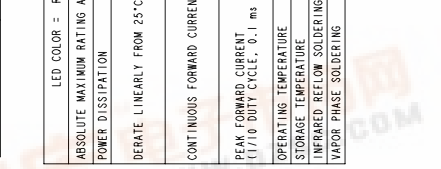
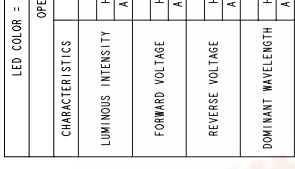
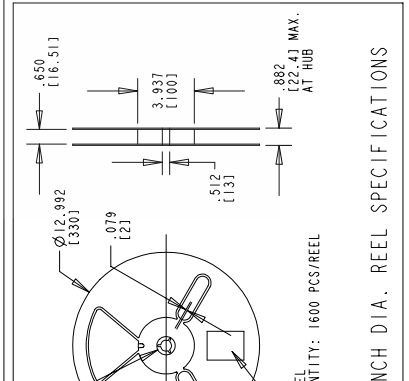
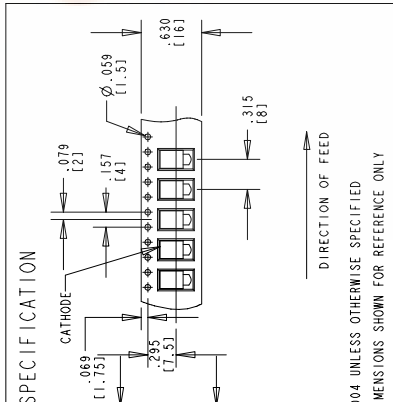

LED COLOR = BLUE						
OPERATING CHARACTERISTICS AT 25°C AMBIENT						
CHARACTERISTICS	MIN	TYP	MAX	UNITS	TEST CONDITIONS	
LUMINOUS INTENSITY	6.0	mc/d			I F = 10 mA	
FORWARD VOLTAGE	3.5	4.2	V		I F = 10 mA	
REVERSE CURRENT	0.01	TO	µA		V R = 5 V	

LED COLOR = BLUE						
ABSOLUTE MAXIMUM RATING AT 25°C AMBIENT						
POWER DISSIPATION	UNITS					
DERATE LINEARLY FROM 55°C	100					
CONTINUOUS FORWARD CURRENT	20					
OPERATING TEMPERATURE	-40 TO 100 °C					
STORAGE TEMPERATURE	-40 TO 100 °C					

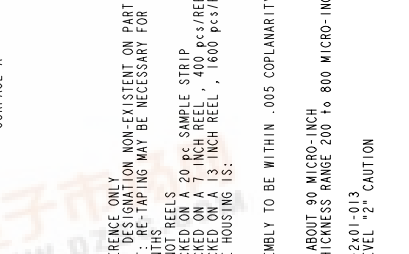
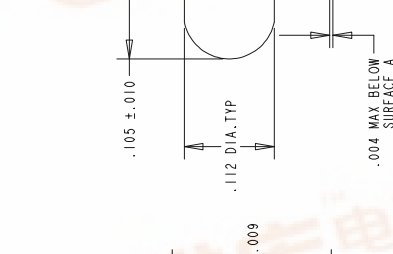

- NOTES :
- 1- MILLIMETER DIMENSIONS SHOWN FOR REFERENCE ONLY
  - 2- PAD NUMBERS ARE FOR REFERENCE ONLY. DESIGNATION NON-EXISTENT ON PART
  - 3- STORAGE CONDITIONS FOR TAPED PRODUCT - RE-TAPING MAY BE NECESSARY FOR PRODUCTS STORED MORE THAN TWELVE MONTHS
  - 4- ORDER QUANTITY IS LED ASSEMBLIES, NOT REELS
  - 5- ...002 SUFFIX X MEANS PARTS ARE PACKED ON A 20 pc SAMPLE STRIP
  - 6- ...013 SUFFIX Y MEANS PARTS ARE PACKED ON A 7 INCH REEL, 400 PCS/REEL
  - 7- LENS VERTICAL HORIZONTALITY TO THE HOUSING IS:
    - .007" T.I.R. VERTICALLY
    - .007" T.I.R. HORIZONTALLY
  - 8- FRONT AND REAR TERMINALS OF THE ASSEMBLY TO BE WITHIN .005 COPLANARITY
  - 9- LED LEAD FRAME MATERIAL: CORE MATERIAL = COPPER 2nd PLATING = Ag-100% THICKNESS ABOUT 90 MICRO-INCH
  - 10- ALL OTHER PART NUMBERS 2101-007, 501-2901-013 LABEL APPLIED AS PER JEDEC STD. 033

REV	DRAWING NUMBER	TITLE	MATERIAL
H	C-15636	SURFACE MOUNT CBI - ROUND LENS	DECIMALS (.XXX) - E.915 DECIMALS (.XXXX) - MATERIAL

REV	DRAWING NUMBER	TITLE	MATERIAL
H	C-15636	SURFACE MOUNT CBI - ROUND LENS	DECIMALS (.XXX) - E.915 DECIMALS (.XXXX) - MATERIAL

REV	DRAWING NUMBER	TITLE	MATERIAL
H	C-15636	SURFACE MOUNT CBI - ROUND LENS	DECIMALS (.XXX) - E.915 DECIMALS (.XXXX) - MATERIAL

REV	DRAWING NUMBER	TITLE	MATERIAL
H	C-15636	SURFACE MOUNT CBI - ROUND LENS	DECIMALS (.XXX) - E.915 DECIMALS (.XXXX) - MATERIAL

1501 ROUTE 34 SOUTH FARMINGDALE, N.J. 07127