

AD6C211-L



1 Form A
Solid State Relay

DESCRIPTION

The AD6C211-L is a bi-directional, single-pole, single-throw, normally open multipurpose solid-state relay. It is designed to replace electromechanical relays in general purpose switching applications. The relay consists of an integrated circuit that drives two rugged source-to-source enhancement type DMOS transistors - optically coupled to a light emitting diode. This device also includes current-limiting circuitry. During increased load currents or transient current spikes, this circuitry acts to limit load current, thereby protecting the device as well as downstream components.

FEATURES

- Current limiting
- Low input control power consumption (2.5mA TYP)
- 140mA maximum continuous load current
- 25 ohms maximum on-resistance
- High input-to-output isolation
- Long life/high reliability

OPTIONS/SUFFIXES*

- -S Surface Mount Leadform Option
- -TR Tape and Reel Option

NOTE: Suffixes listed above are not included in marking on device for part number identification.

SCHEMATIC DIAGRAM

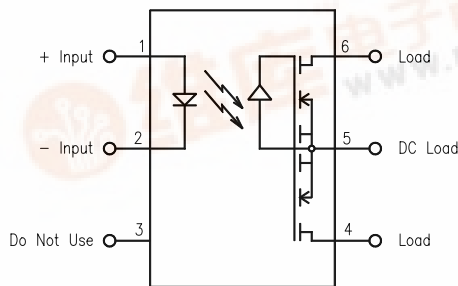

APPLICATIONS

- Reed relay replacement
- Meter reading systems
- Medical equipment
- Battery monitoring
- Multiplexers

ABSOLUTE MAXIMUM RATINGS*

| PARAMETER | UNIT | MIN | TYP | MAX |
|-------------------------------|------|-----|-----|-----|
| Storage Temperature | °C | -55 | | 125 |
| Operating Temperature | °C | -40 | | 85 |
| Continuous Input Current | mA | | | 40 |
| Transient Input Current | mA | | | 400 |
| Reverse Input Control Voltage | V | 6 | | |
| Output Power Dissipation | mW | | | 800 |

*The values indicated are absolute stress ratings. Functional operation of the device is not implied at these or any conditions in excess of those defined in electrical characteristics section of this document. Exposure to Absolute Ratings may cause permanent damage to the device and may adversely affect reliability.

APPROVALS

- BAPT CERTIFICATE #607836:
BS EN 60950, BS EN 41003, BS EN 60065
- CSA CERTIFICATE #LR111581-1
- UL FILE #E90096

ELECTRICAL CHARACTERISTICS - 25°C

| PARAMETER | UNIT | MIN | TYP | MAX | TEST CONDITIONS |
|-------------------------------|---------|------|------|-----|----------------------|
| INPUT SPECIFICATIONS | | | | | |
| LED Forward Voltage | V | | 1.2 | 1.5 | If = 10mA |
| LED Reverse Voltage | V | 6 | 12 | | Ir = 10uA |
| Turn-On Current | m A | | 2.5 | 5 | Io = 140mA |
| Turn-Off Current | m A | | 0.5 | | |
| OUTPUT SPECIFICATIONS | | | | | |
| Continuous Load Current | m A | | | 140 | If = 5mA |
| Current Limit | m A | 180 | 220 | 250 | If = 5mA |
| On-Resistance | Ω | | 18 | 25 | Io = 140mA |
| Leakage Current | μ A | | 0.2 | 1 | Vo = 400V |
| Blocking Voltage | V | 400 | | | Io = 1uA |
| Output Capacitance | p F | | 25 | 50 | Vo = 25V, f = 1.0MHz |
| Offset Voltage | m V | | | 0.2 | If = 5mA |
| COUPLED SPECIFICATIONS | | | | | |
| Isolation Voltage | V | 2500 | | | T = 1 minute |
| -H Suffix | V | 3750 | | | T = 1 minute |
| Turn-on Time | m s | | 1 | 2 | If = 5mA, Io = 140mA |
| Turn-off Time | m s | | 0.5 | 1 | if = 5mA, Io = 140mA |
| Isolation Resistance | G Ω | 100 | | | |
| Coupled Capacitance | p F | | 3 | | |
| Contact Transient Ratio | V / μ s | 2000 | 7000 | | dV = 50V |

PERFORMANCE DATA

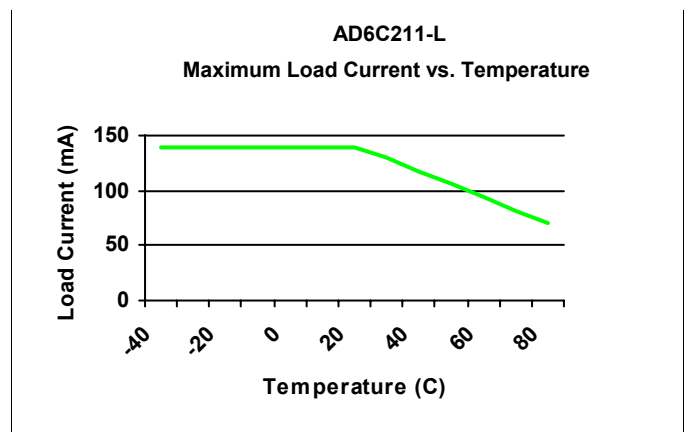
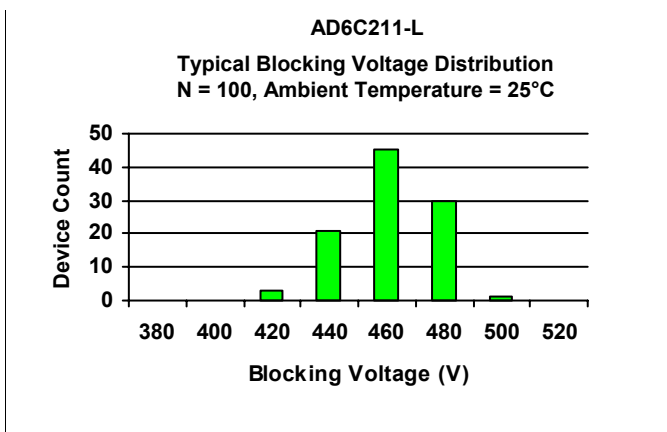
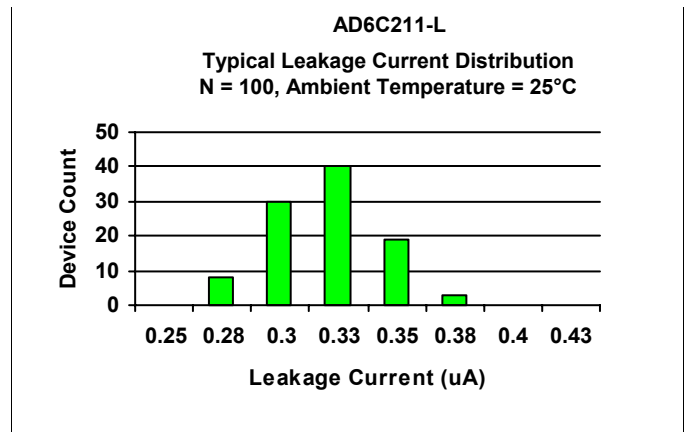
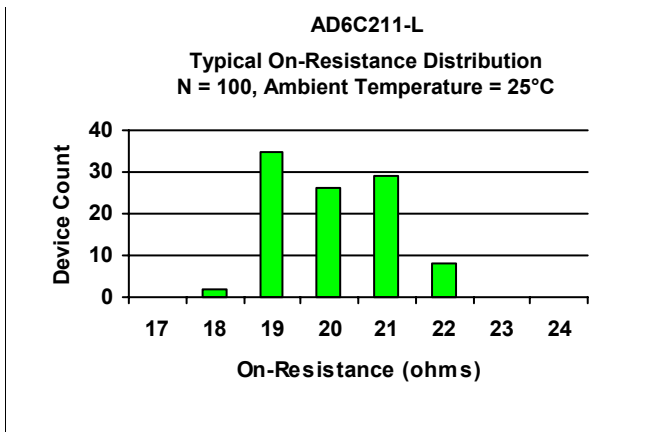
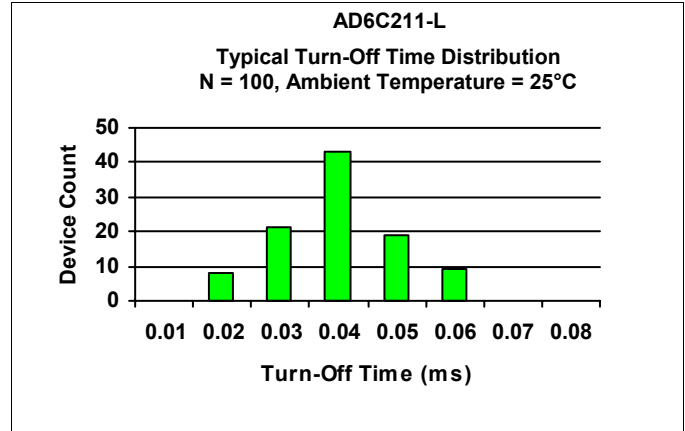
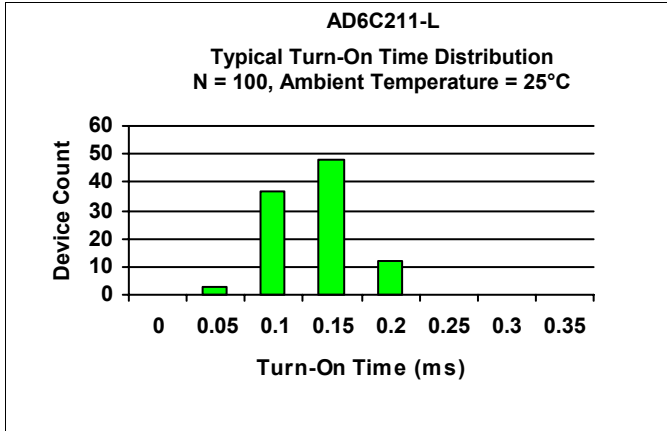

MECHANICAL DIMENSIONS

6 PIN DUAL IN-LINE PACKAGE

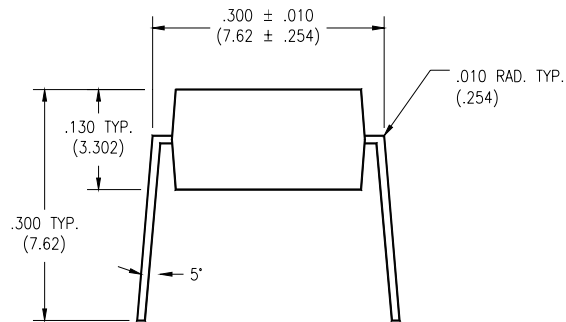

END VIEW

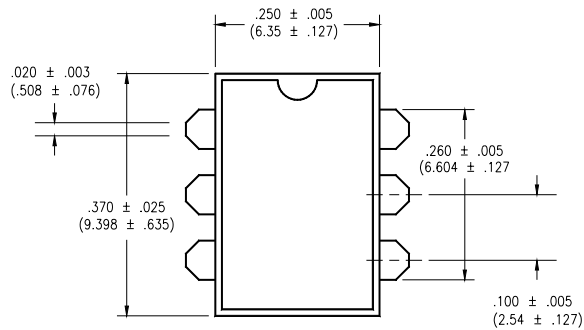

TOP VIEW

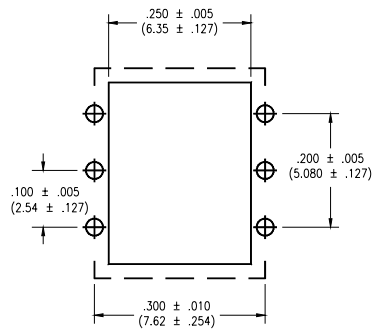

BOTTOM VIEW/
BOARD PATTERN

6 PIN SURFACE MOUNT DEVICE

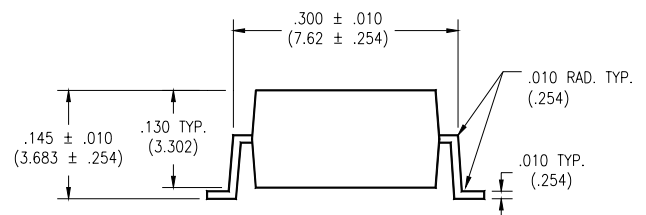

END VIEW

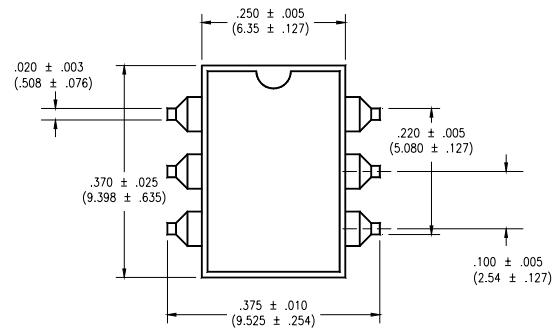

TOP VIEW

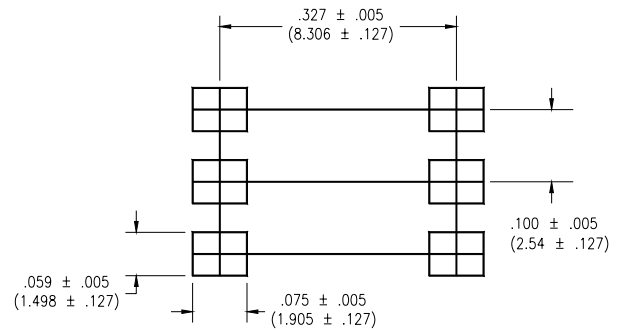

BOTTOM VIEW/
BOARD PATTERN

DISCLAIMER

Solid State Optronics (SSO) makes no warranties or representations with regards to the completeness and accuracy of this document. SSO reserves the right to make changes to product description, specifications at any time without further notice. SSO shall not assume any liability arising out of the application or use of any product or circuit described herein. Neither circuit patent licenses nor indemnity are expressed or implied. Except as specified in SSO's Standard Terms & Conditions, SSO disclaims liability for consequential or other damage, and we make no other warranty, expressed or implied, including merchantability and fitness for particular use.

LIFE SUPPORT POLICY

SSO does not authorize use of its devices in life support applications wherein failure or malfunction of a device may lead to personal injury or death. Users of SSO devices in life support applications assume all risks of such use and agree to indemnify SSO against any and all damages resulting from such use. Life support devices are defined as devices or systems which, (a) are intended for surgical implant into the body, or (b) support or sustain life, and (c) whose failure to perform when used properly in accordance with instructions for use can be reasonably expected to result in significant injury to the user, or (d) a critical component in any component of a life support device or system whose failure can be reasonably expected to cause failure of the life support device or system, or to affect its safety or effectiveness.
