

Proximity Sensors Inductive Nickel-plated Brass Housing Types DJ, M 14, PG 21, Namur

CARLO GAVAZZI



- Nickel-plated brass housing, cylindrical
- Diameter: M 14, PG 21
- Sensing distance: 2 to 6 mm
- Power supply: 8.2 VDC (Namur)
- Output: Namur (DIN 19 234)
- 2 m cable

Product Description

Proximity switch in M 14 and PG 21 nickel-plated brass housings, for flush mounting and non-flush mounting. Amplifier relay SD ... available. Delivered with 2 m cable.

Ordering Key

DJ 2 G

Type: Inductive proximity switch
Rated operating dist. (mm)
Housing material

Type Selection

| Housing diameter | Rated operating dist. (S _n) | Ordering no. Namur |
|------------------|---|--------------------|
| M 14 | 2 mm ¹⁾ | DJ 2 G |
| M 14 | 5 mm ²⁾ | DJ 5 G |
| PG 21 | 6 mm ¹⁾ | DJ 6 G |

¹⁾ For flush mounting in metal
²⁾ For non-flush mounting in metal

Specifications

| | | | |
|--|---|--|---|
| Rated operational volt. (U _e) (U _b) | 8.2 VDC 7 to 9 VDC (6 to 35 VDC, all specifications not observed in extended supply range) | Usable operating dist. (S _u) | DJ 2 G 0.8 x S _r ≤ S _u ≤ 1.2 x S _r DJ 5 G 0.9 x S _r ≤ S _u ≤ 1.1 x S _r DJ 6 G 0.8 x S _r ≤ S _u ≤ 1.2 x S _r |
| Self-inductance | ≤ 300 mH | Ambient temperature Operating | DJ 2 G -20° to +60°C (-4° to +140°F) DJ 5 G -25° to +70°C (-13° to +158°F) DJ 6 G -20° to +60°C (-4° to +140°F) |
| Self-capacitance | ≤ 120 nF | Storage | DJ 2 G -25° to +70°C (-13° to +158°F) DJ 5 G -30° to +80°C (-22° to +176°F) DJ 6 G -25° to +70°C (-13° to +158°F) |
| No-load supply current (I _o) | Activated: ≤ 1 mA Not activated: DJ 2 G ≥ 3 mA DJ 5 G ≥ 2.2 mA DJ 6 G ≥ 2.2 mA Max.: 9.35 mA | Degree of protection | IP 67 (Nema 1, 3, 4, 6, 13) |
| Protection | None (DJ10 G: reverse polarity) | Housing material | Body Nickel-plated brass Front Blue ABS Back Blue ABS |
| Transient voltage | ≤ 1 kV/0.5 J (prepared) | Cable | DJ 2 G 2 m, 2 x 0.25 mm ² DJ 5 G 2 m, 2 x 0.25 mm ² DJ 6 G 2 m, 2 x 0.50 mm ² grey PVC, oil proof |
| Frequency of operating cycles (f) | DJ 2 G 2000 Hz DJ 5 G 1000 Hz DJ 6 G 1000 Hz | | |
| Assured operating dist. (S _a) | DJ 2 G 0 to 1.44 mm DJ 5 G 0 to 4.05 mm DJ 6 G 0 to 4.32 mm | | |
| Repeat accuracy (R) | ≤ 10% | | |
| Hysteresis (H) (Differential travel) | Dependent on amplifier relay | | |



Specifications (cont.)

| | | | | | |
|--------|------------------|-------|-------------------|--------|----------|
| Weight | DJ 2 G | 80 g | Tightening torque | DJ 2 G | 17.5 Nm |
| | DJ 5 G | 80 g | | DJ 5 G | 17.5 Nm |
| | DJ 6 G | 210 g | | DJ 6 G | 175.0 Nm |
| | (cable included) | | | | |
| | | | CE-marking | Yes | |

Dimensions

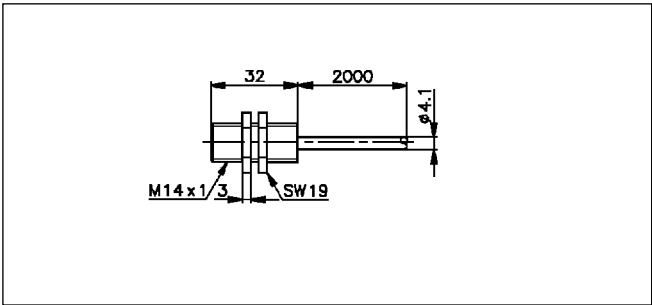

DJ 2 G

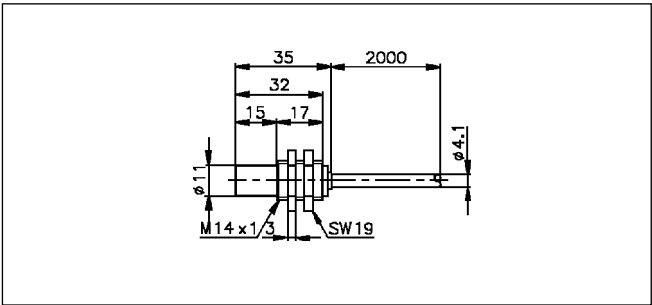

DJ 5 G

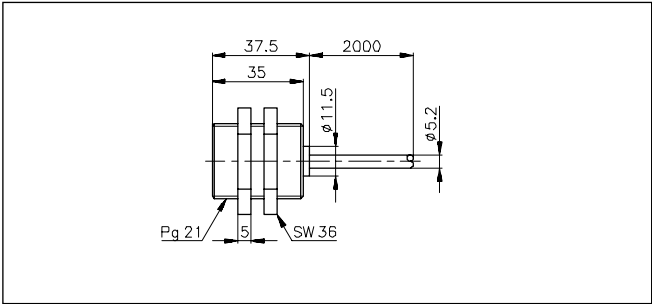

DJ 6 G

Wiring Diagrams

Refer to "Wiring Diagrams",
Technical information.

Installation Hints

Refer to "Installation Hints",
Technical information.

Amplifier Relays, Namur

> SD 110/210.
> SD 170/270.
Refer to Technical Information.