



**General Power Transformer <Pin Type: ERH Series>**

**Type: ERH2822**

◆ **Product Description**

- 30.0×29.5mm Max.(L×W), 23.0mm Max. Height.
- Custom design is available.



◆ **Feature**

- Max. Operating frequency 500kHz. Max Operating Power 35.0W(500kHz)
- Ideally used in Switching regulator, EL inverter and Power Factor Correction choke.
- RoHS Compliance

◆ **Dimensions (mm)**

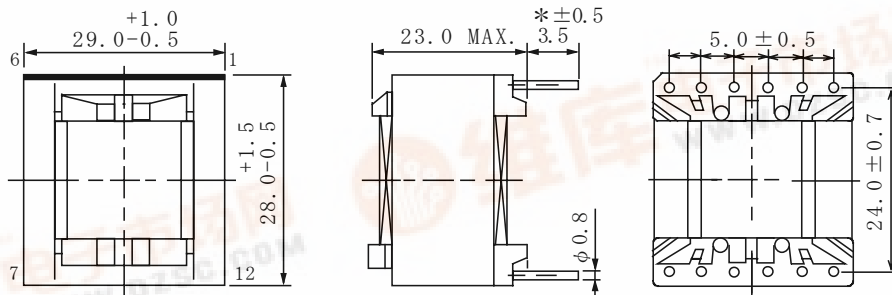

◆ **Schematics (Bottom)**

**1. For General Transformer**

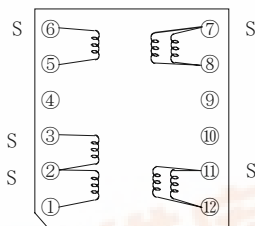

**2. For PFC choke**

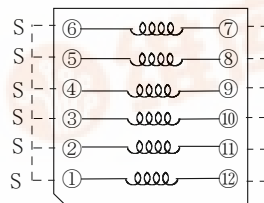

“S” is winding start

◆ **Specification (For General Transformer)**

| Sample No. | Inductance (1-3)<br>1kHz/1V | D.C.R.<br>(7-8) | D.C.R.<br>(11-12) | Hi-pot<br>Winding-winding<br>(50/60Hz) |
|------------|-----------------------------|-----------------|-------------------|--|
| 3308-T126  | 1.0mH ± 25%                 | 150mΩ Max.      | 35 mΩ Max.        | AC 1500Vrms/1min.                      |

◆ **Specification (For PFC choke)**

| Sample No. | Inductance<br>(1,2,3,4,5,6-7,8,9,10,11,12)<br>1kHz/1V | D.C.R.<br>(1,2,3,4,5,6-7,8,9,10,11,12) | Rated Current<br>(1,2,3,4,5,6-7,8,9,10,11,12) |
|------------|---|--|---|
| 3308-T130  | 50 μ H ± 18%  | 2.4mΩ Max.                             | 1.5 A   |

※ Rated current: The DC current at which the inductance decreases to 90 % of it's initial value or when Δt=40℃, whichever is lower(Ta=20℃).

