

FLU10ZM

L-Band Medium & High Power GaAs FET

FEATURES

- High Output Power: P1dB=29.5dBm(typ.)
- High Gain: G1dB=13.0dB(typ.)
- Low Cost Plastic(SMT) Package
- Tape and Reel Available

DESCRIPTION

The FLU10ZM is a GaAs FET designed for base station and CPE applications. This is a new product series using a plastic surface mount package that has been optimized for high volume cost driven applications. Fujitsu's stringent Quality Assurance Program assures the highest reliability and consistent performance.

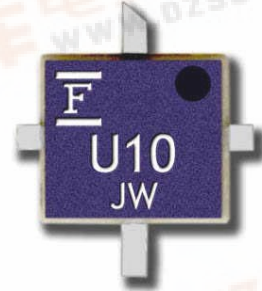

ABSOLUTE MAXIMUM RATINGS (Case Temperature Tc=25°C)

| Item | Symbol | Rating | Unit |
|-------------------------|------------------|-------------|------|
| Drain-Source Voltage | V _{DS} | 15 | V |
| Gate-Source Voltage | V _{GS} | -5 | V |
| Total Power Dissipation | P _T | 6.9 | W |
| Storage Temperature | T _{stg} | -55 to +150 | °C |
| Channel Temperature | T _{CH} | 175 | °C |

Recommended Operating Condition (Case Temperature Tc=25°C)

| Item | Symbol | Condition | Unit |
|----------------------|------------------|-----------|------|
| DC Input Voltage | V _{DS} | ≤ 10 | V |
| Channel Temperature | T _{ch} | ≤ 145 | °C |
| Forward Gate Current | I _{gsf} | ≤ 4.8 | mA |
| Reverse Gate Current | I _{gsr} | ≥ -0.5 | mA |
| Gate Resistance | R _g | 400 | Ω |

ELECTRICAL CHARACTERISTICS (Case Temperature Tc=25°C)

| Item | Symbol | Test Conditions | Limit | | | Unit |
|-------------------------------|------------------|---|-------|------|------|------|
| | | | Min. | Typ. | Max. | |
| Drain Current | I _{DSS} | V _{DS} =5V, V _{GS} =0V | - | 300 | 450 | mA |
| Transconductance | gm | V _{DS} =5V, I _{DS} =200mA | - | 150 | - | mS |
| Pinch-off Voltage | V _p | V _{DS} =5V, I _{DS} =15mA | -1.0 | -2.0 | -3.5 | V |
| Gate-Source Breakdown Voltage | V _{GSO} | I _{GS} =-15uA | -5 | - | - | V |
| Output Power at 1dB G.C.P. | P _{1dB} | V _{DS} =10V, f=2.0GHz, I _{DS} =0.6I _{DSS} (Typ.) | 28.5 | 29.5 | - | dBm |
| Power Gain at 1dB G.C.P. | G _{1dB} | I _{DS} =0.6I _{DSS} (Typ.) | 12.0 | 13.0 | - | dB |
| Thermal Resistance | R _{th} | Channel to Case | - | 15 | 18 | °C/W |

CASE STYLE: ZM

G.C.P.: Gain Compression Point

Note 1: Product supplied to this specification are 100% DC performance tested.

Note 2: The RF parameters are measured on a lot basis by sample testing 10 pcs/lot.

Acceptance Criteria:(accept/reject)=(0/1). Any lot failure shall be 100% retested.

| | | |
|-----|----------|-------------|
| ESD | Class II | 500~ 1999 V |
|-----|----------|-------------|

Note : Based on EIAJ ED-4701 C-111A (C=100pF,R=1.5kΩ)

FLU10ZM

L-Band Medium & High Power GaAs FET

POWER DERATING CURVE

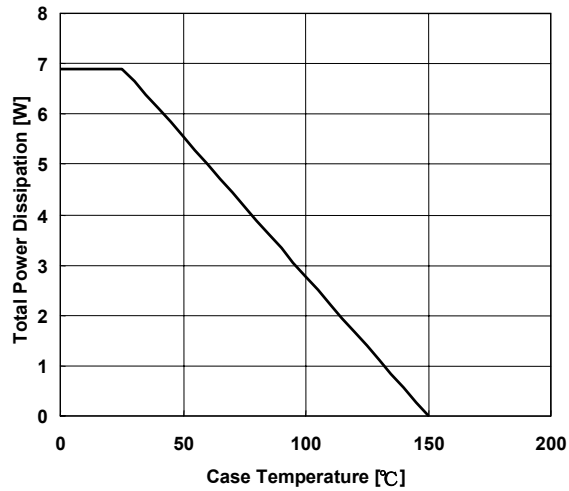

OUTPUT POWER & POWER ADDED EFFICIENCY vs. INPUT POWER

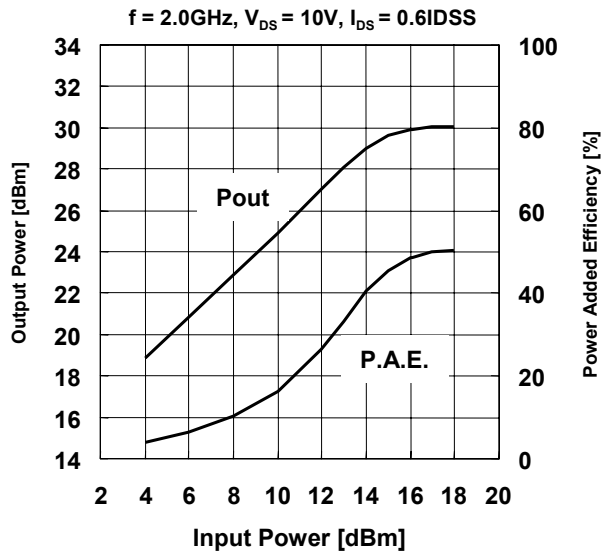

FLU10ZM

L-Band Medium & High Power GaAs FET

■ S-PARAMETER

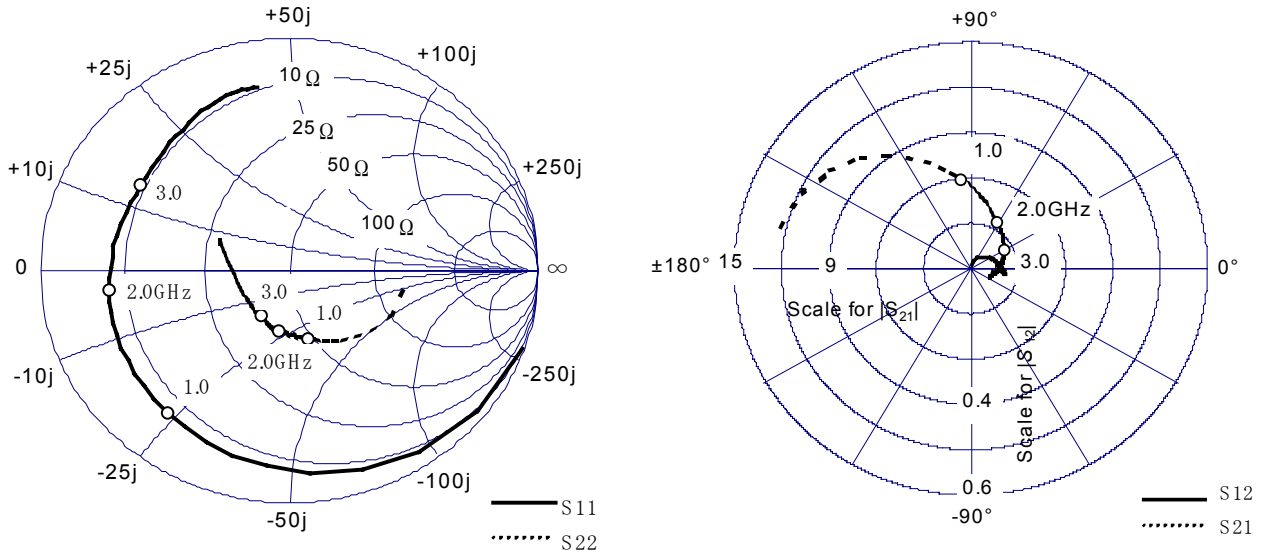

$V_{DS} = 10V, I_{DS} = 180mA$

| Freq [GHz] | S11 | | S21 | | S12 | | S22 | |
|---------------|------|---------|------|--------|------|--------|------|---------|
| | MAG | ANG | MAG | ANG | MAG | ANG | MAG | ANG |
| 0.5 | 0.88 | -82.82 | 9.02 | 126.68 | 0.05 | 48.61 | 0.37 | -52.39 |
| 1 | 0.78 | -128.10 | 5.90 | 96.81 | 0.06 | 27.98 | 0.30 | -78.22 |
| 1.5 | 0.75 | -153.80 | 4.31 | 76.65 | 0.07 | 19.62 | 0.27 | -91.11 |
| 2 | 0.72 | -174.63 | 3.45 | 60.18 | 0.07 | 13.94 | 0.25 | -101.36 |
| 2.5 | 0.71 | 165.70 | 2.85 | 43.48 | 0.08 | 8.34 | 0.22 | -114.34 |
| 3 | 0.69 | 145.11 | 2.41 | 27.24 | 0.08 | 4.74 | 0.20 | -128.63 |
| 3.5 | 0.73 | 126.72 | 2.05 | 11.34 | 0.08 | -1.38 | 0.19 | -153.74 |
| 4 | 0.76 | 112.29 | 1.74 | -3.63 | 0.08 | -7.63 | 0.22 | 179.95 |
| 4.5 | 0.79 | 100.63 | 1.48 | -17.87 | 0.09 | -13.21 | 0.27 | 161.06 |
| 5 | 0.80 | 93.48 | 1.25 | -30.30 | 0.09 | -16.94 | 0.34 | 146.70 |

FLU10ZM

L-Band Medium & High Power GaAs FET

OUTPUT POWER & DRAIN CURRENT vs. INPUT POWER with a wide band tuning condition.

@ $V_{DS} = 10V$, $I_{DS} = 150mA$, $V_{GS} = -0.9V$

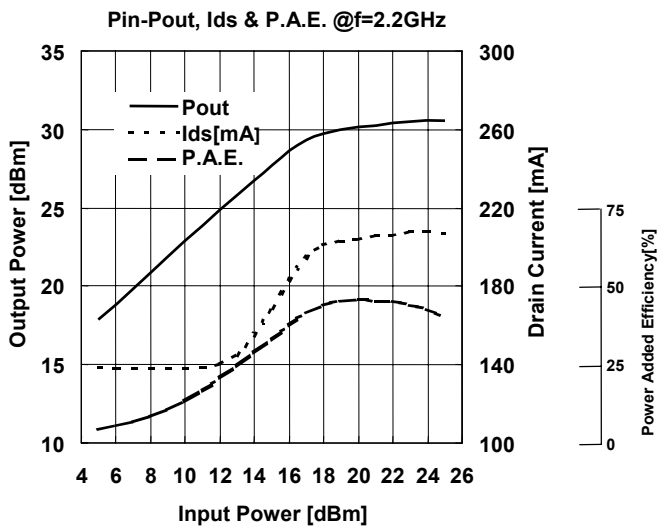
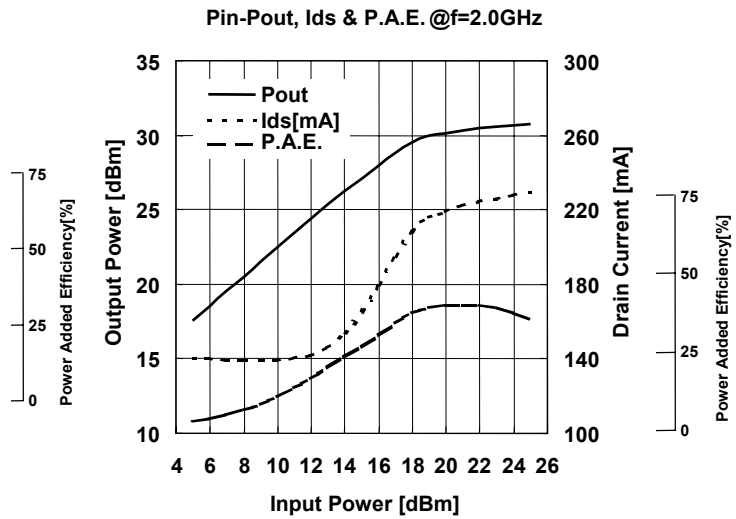
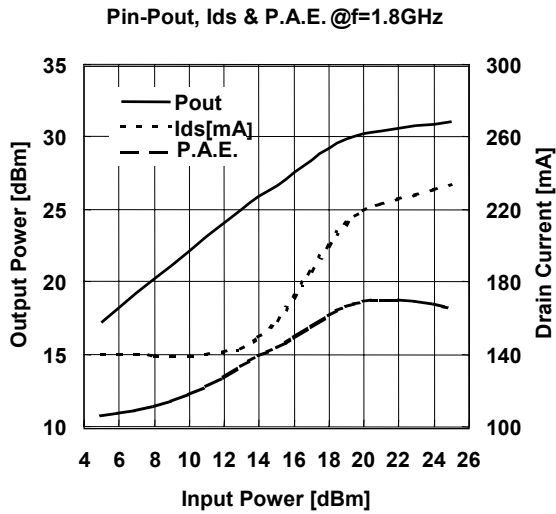

OUTPUT POWER vs. FREQUENCY

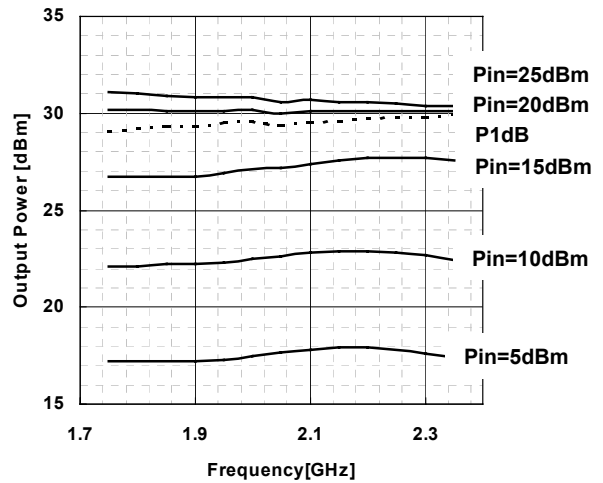

FLU10ZM

L-Band Medium & High Power GaAs FET

@ $V_{DS} = 10V$, $I_{DS} = 150mA$, $V_{GS} = -0.9V$

IMD vs OUTPUT POWER(2-tone)

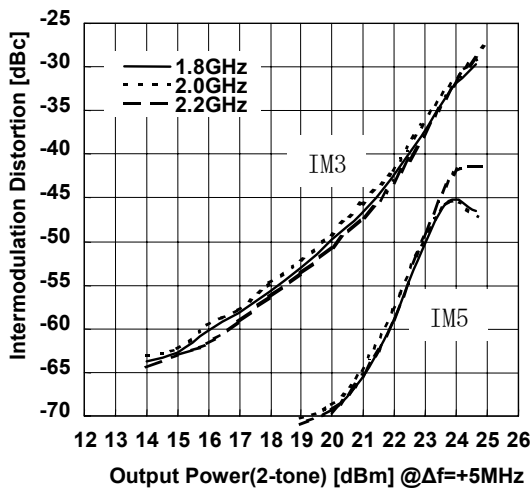

W-CDMA 2-CARRIER IMD(ACLR)

*fo=2.1325GHz *f1=2.1475GHz

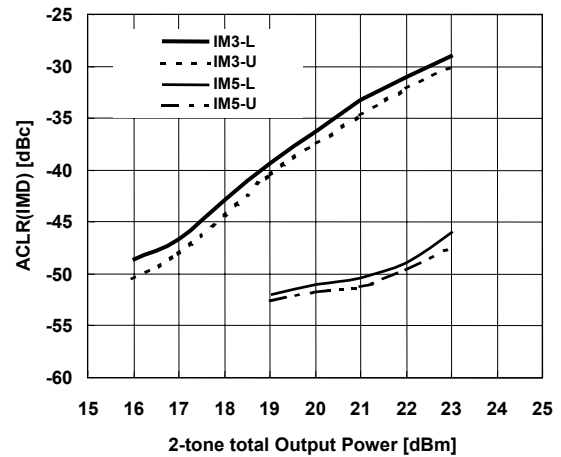

W-CDMA SINGLE CARRIER ACLR

*fo=2.1325GHz

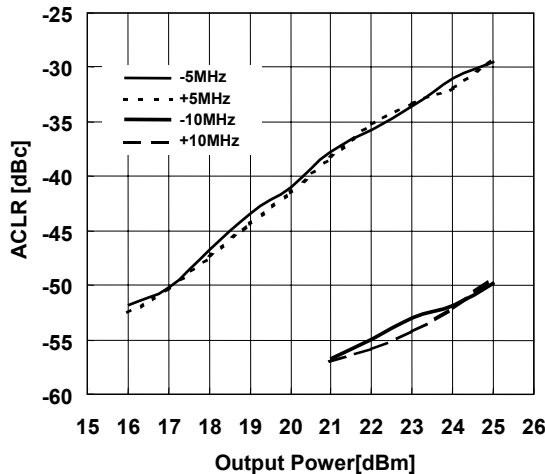

W-CDMA SINGLE CARRIER CCDF AND GAIN

*fo=2.1325GHz

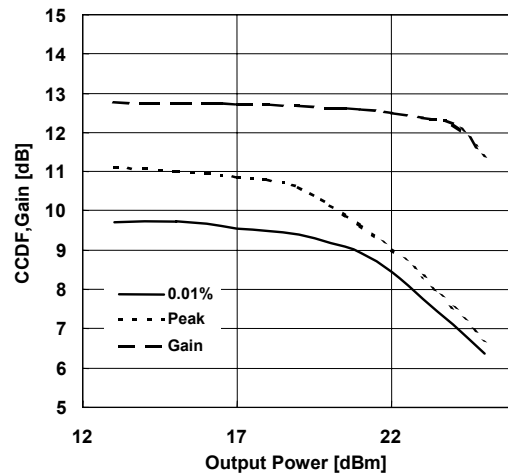

Note : *All signals are W-CDMA modulated at 3GPP3.4.12-00 BS-1 64ch non clipping. All data was obtained using the board tuned for wide band tuning (1.8 GHz to 2.3 GHz).

FLU10ZM

L-Band Medium & High Power GaAs FET

■ Recommended Bias Circuit and Internal Block Diagram (wide band tuning condition)

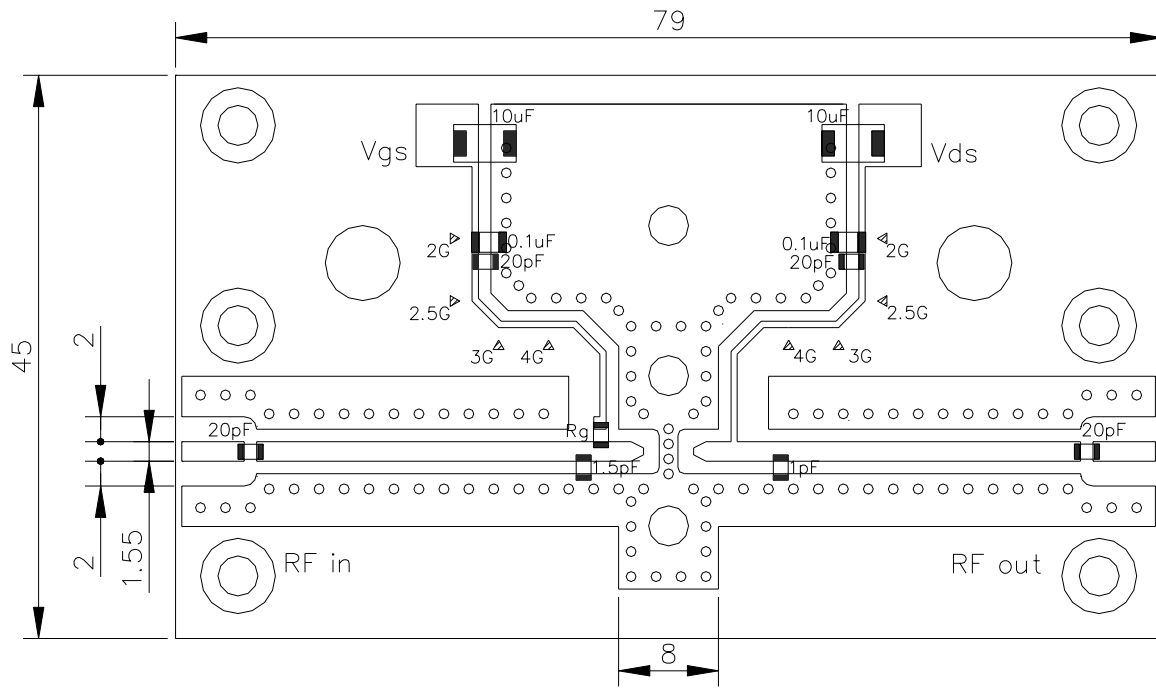

<Board information>
 $\epsilon_r=3.5$, $t=0.8$

Unit : mm

* Board was tuned for wide band performance with data shown on pages 4 and 5.

FLU10ZM

L-Band Medium & High Power GaAs FET

■ Package Outline

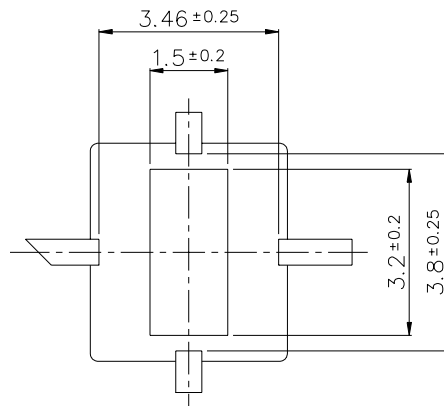
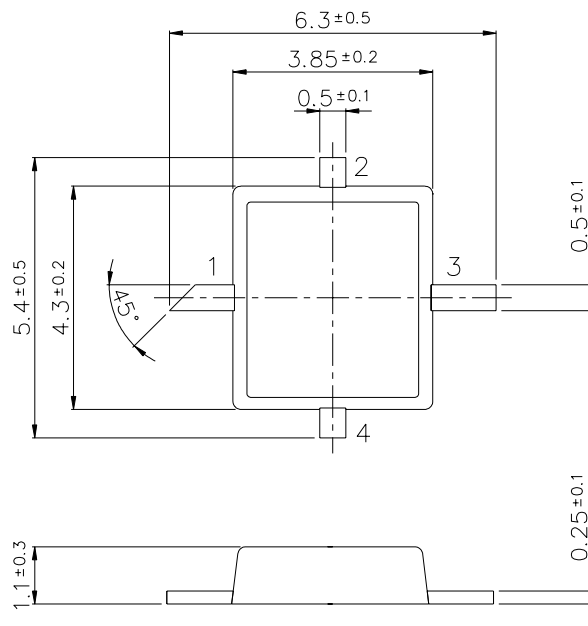

- 1 : Gate
 - 2 : Source
 - 3 : Drain
 - 4 : Source
- Unit : mm

FLU10ZM

L-Band Medium & High Power GaAs FET

For further information please contact :

FUJITSU COMPOUND SEMICONDUCTOR, INC.

2355 Zanker Rd.
San Jose, CA 95131-1138, U.S.A.
Phone: (408) 232-9500
FAX: (408) 428-9111
www.fcsi.fujitsu.com

FUJITSU QUANTUM DEVICES EUROPE LTD.

Network House
Norreys Drive
Maidenhead, Berkshire SL6 4FJ
Phone: +44 (0) 1628 504800
FAX: +44 (0) 1628 504888

FUJITSU QUANTUM DEVICES LIMITED

Business Development Division
11th Floor, Hachioji Daiichi-Seimei Bldg.
3-20-6 Myojin-cho
Hachioji-city, Tokyo 192-0046, Japan
TEL: +81-426-43-5885
FAX: +81-426-43-5582

| |
|--|
| CAUTION |
| Fujitsu Compound Semiconductor Products contain gallium arsenide (GaAs) which can be hazardous to the human body and the environment. For safety, observe the following procedures: |
| <ul style="list-style-type: none">• Do not put these products into the mouth.• Do not alter the form of this product into a gas, powder, or liquid through burning, crushing, or chemical processing as these by-products are dangerous to the human body if inhaled, ingested, or swallowed.• Observe government laws and company regulations when discarding this product. This product must be discarded in accordance with methods specified by applicable hazardous waste procedures. |

FUJITSU QUANTUM DEVICES SINGAPORE PTE LTD.

Hong Kong Branch
Rm. 1101, Ocean Centre, 5 Canton Rd.
Tsim Sha Tsui, Kowloon, Hong Kong
TEL: +852-23770226
FAX: +852-23763269

Fujitsu Limited reserves the right to change products and specifications without notice.
The information does not convey any license under rights of Fujitsu Limited or others.

(© 2003 FUJITSU COMPOUND SEMICONDUCTOR, INC.
Printed in U.S.A. FCSI0202M200

