

GTM CORPORATION

ISSUED DATE :2003/11/27
REVISED DATE :2004/11/29B

GMPSA44 NPN EPITAXIAL PLANAR TRANSISTOR

Description

The GMPSA44 is designed for application that requires high voltage.

Features

- *High Breakdown Voltage: 400(Min) at IC=1mA
- *High current .Gain :IC=300mA at 25°C
- *Complementary to GMPSA94

Package Dimensions

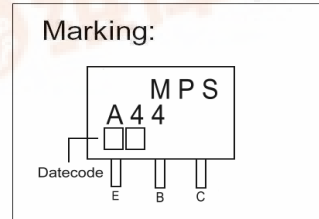
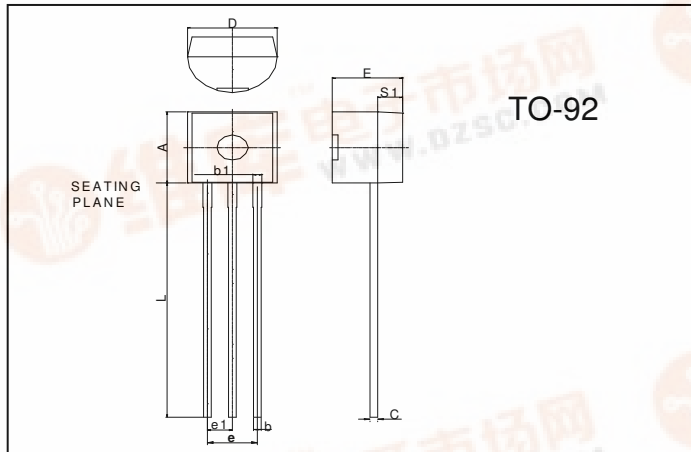

REF.	Millimeter		REF.	Millimeter	
	Min.	Max.		Min.	Max.
A	4.45	4.7	D	4.44	4.7
S1	1.02	-	E	3.30	3.81
b	0.36	0.51	L	12.70	-
b1	0.36	0.76	e1	1.150	1.390
C	0.36	0.51	e	2.42	2.66

Absolute Maximum Ratings (Ta = 25°C, unless otherwise specified)

Parameter		Ratings	Unit
Collector to Base Voltage	VCBO	500	V
Collector to Emitter Voltage	VCEO	400	V
Emitter to Base Voltage	VEBO	6	V
Collect Current(DC)	Ic	300	mA
Junction Temperature	Tj	+150	°C
Storage Temperature Range	TSTG	-55 ~ +150	°C
Total Power Dissipation	PD	625	mW

Electrical Characteristics (Ta = 25°C, unless otherwise specified)

Symbol	Min.	Typ.	Max.	Unit	Test Conditions
BVCBO	500	-	-	V	IC=100uA
BVCEO	400	-	-	V	IC=1mA
BVEBO	6	-	-	V	IE=10uA
ICBO	-	-	100	nA	VCB=400V
IEBO	-	-	100	nA	VEB=4V
ICES	-	-	500	nA	VCE=400V
VCE(sat)1	-	-	350	mV	IC=1.0mA, IB=0.1mA
VCE(sat)2	-	-	350	mV	IC=20mA, IB=2mA
VCE(sat)3	-	-	750	mV	IC=50mA, IB=5mA
VBE(sat)	-	-	750	mV	IC=10mA, IB=1mA
hFE1	40	-	-		VCE=10V, IC=1mA
hFE2	50	-	300		VCE=10V, IC=10mA
hFE3	45	-	-		VCE=10V, IC=50mA
hFE4	40	-	-		VCE=10V, IC=100mA
Cob	-	4	6	pF	VCB=20V, f=1MHz, IE=0

Classification of hFE2

Rank	N	SD	SUM
Range	50-300	70-210	120-300

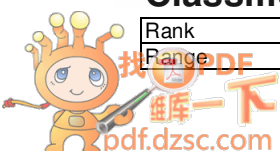

Characteristics Curve

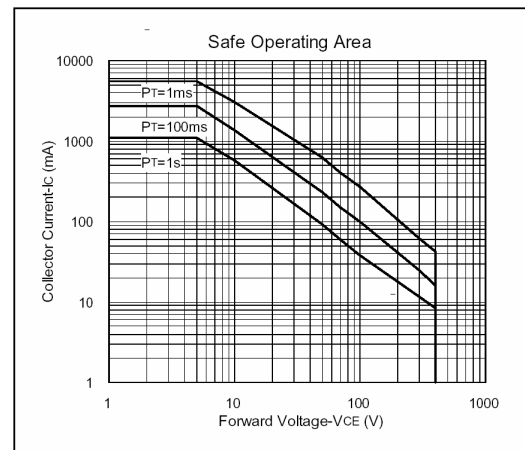
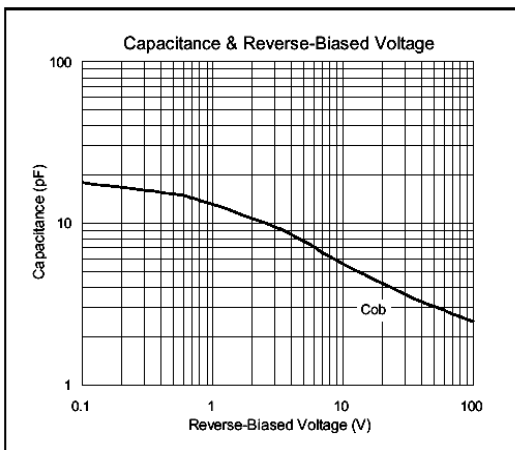
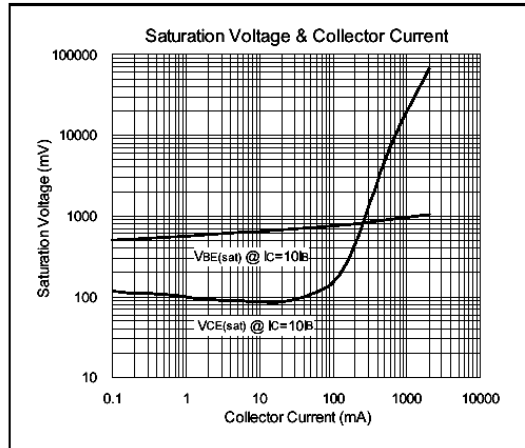
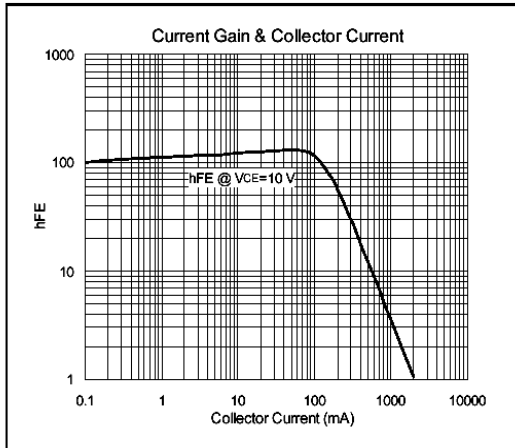

Important Notice:

- All rights are reserved. Reproduction in whole or in part is prohibited without the prior written approval of GTM.
- GTM reserves the right to make changes to its products without notice.
- GTM semiconductor products are not warranted to be suitable for use in life-support Applications, or systems.
- GTM assumes no liability for any consequence of customer product design, infringement of patents, or application assistance.

Head Office And Factory:

- **Taiwan:** No. 17-1 Tatung Rd. Fu Kou Hsin-Chu Industrial Park, Hsin-Chu, Taiwan, R. O. C.
- TEL : 886-3-597-7061 FAX : 886-3-597-9220, 597-0785
- **China:** (201203) No.255, Jang-Jiang Tsai-Lueng RD. , Pu-Dung-Hsin District, Shang-Hai City, China
- TEL : 86-21-5895-7671 ~ 4 FAX : 86-21-38950165