



FRD Type : KCF60A60E

OUTLINE DRAWING

FEATURES

- * Similar to TO-247AC (TO-3P) x 2 Case
- * Dual Diodes – Cathode Common
- * Ultra – Fast Recovery
- * Low Forward Voltage Drop
- * High Surge Capability
- * 200 Volts thru 600 Volts Types Available

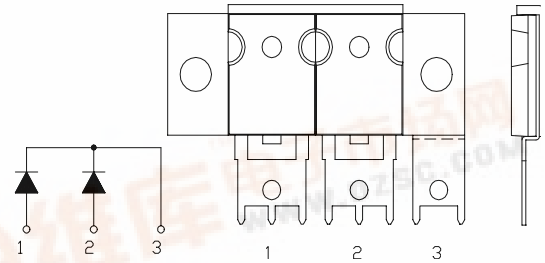

Maximum Ratings

Approx Net Weight:30g

Rating		Symbol	KCF60A60E		Unit
Repetitive Peak Reverse Voltage		V_{RRM}	600		V
Average Rectified Output Current		I_o	60	$T_c=47^\circ C$ 50 Hz, Full Sine Wave Resistive Load	A
RMS Forward Current		$I_{F(RMS)}$	66.6		A
Surge Forward Current		I_{FSM}	400	50 Hz Full Sine Wave, 1 cycle Non-repetitive	A
Operating Junction Temperature Range		T_{jw}	- 40 to + 150		$^\circ C$
Storage Temperature Range		T_{stg}	- 40 to + 150		$^\circ C$
Mounting torque	Anode Cathode Terminal	F_{tor}	0.5	Recommended value	N·m
	Cathode Base		2.4		

Electrical • Thermal Characteristics

Characteristics	Symbol	Conditions	Min.	Typ.	Max.	Unit
Peak Reverse Current	I_{RM}	$T_j=25^\circ C, V_{RM}=V_{RRM}$ per Arm	-	-	50	μA
Peak Forward Voltage	V_{FM}	$T_j=25^\circ C, I_{FM}=30A$ per Arm	-	-	1.7	V
Reverse Recovery Time	t_{rr}	$I_{FM}= 10 A,$ $-di/dt= 50 A/\mu s, T_a= 25^\circ C$	-	-	60	ns
Thermal Resistance	$R_{th(j-c)}$	Junction to Case	-	-	0.85	$^\circ C/W$



KCF60A60E OUTLINE DRAWING (Dimensions in mm)

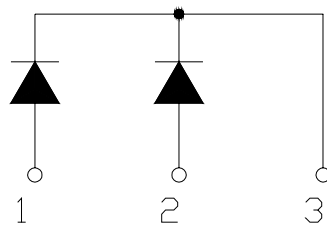
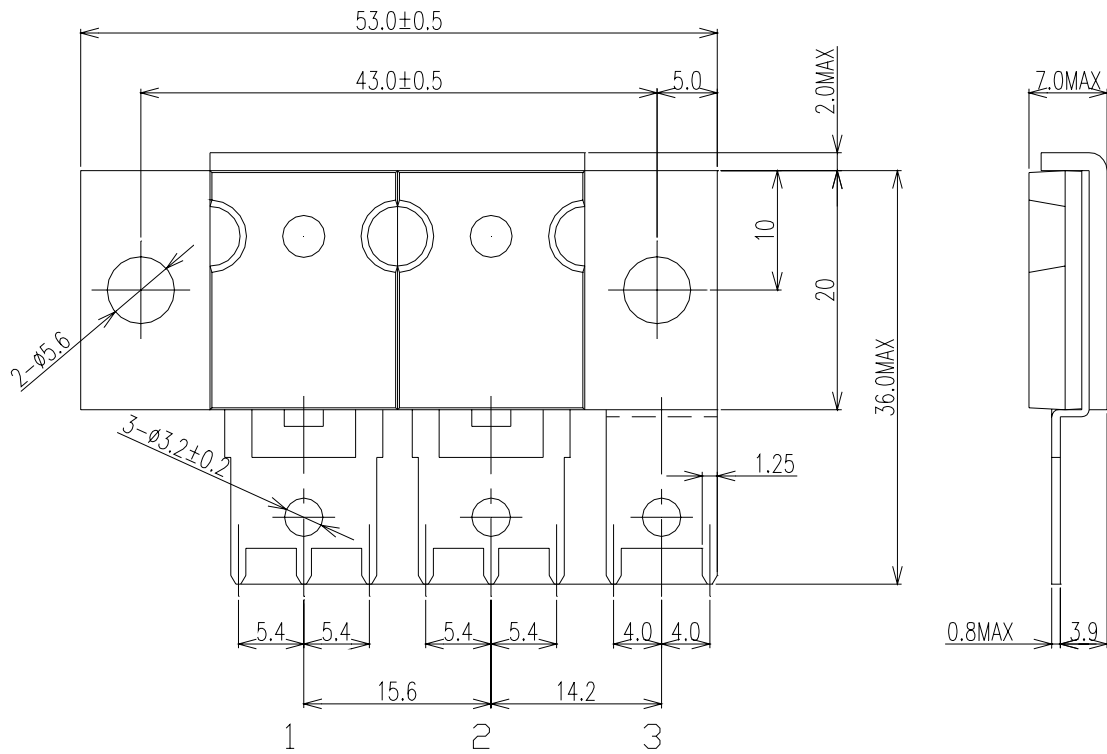

FORWARD CURRENT VS. VOLTAGE

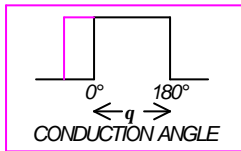
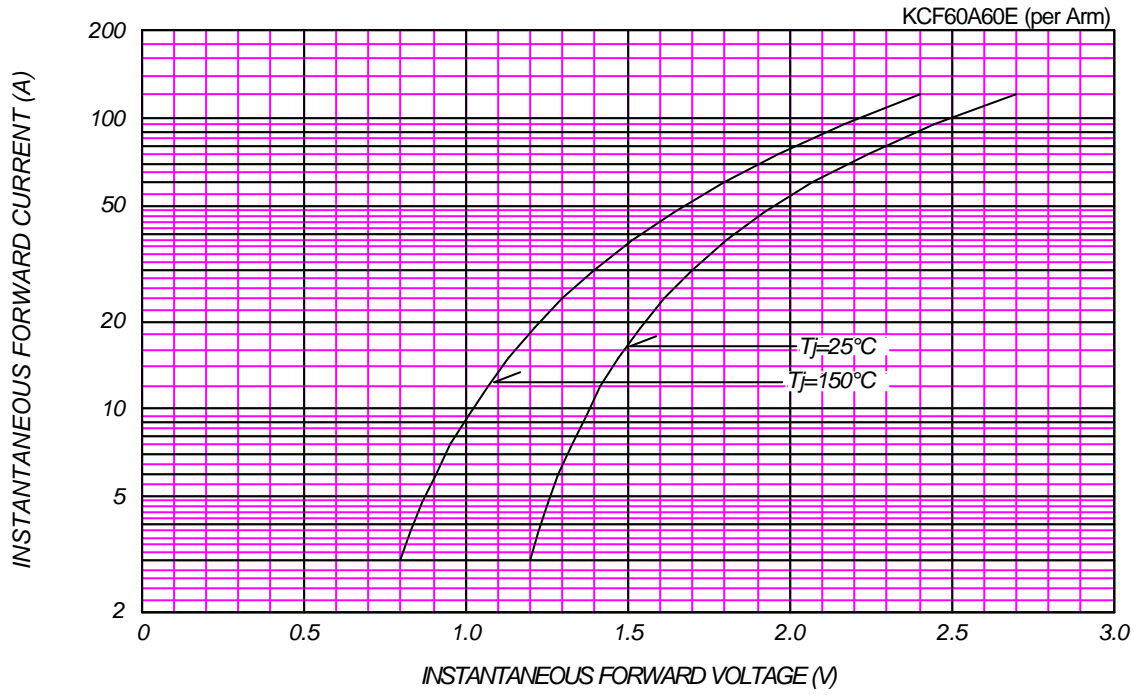

AVERAGE FORWARD POWER DISSIPATION

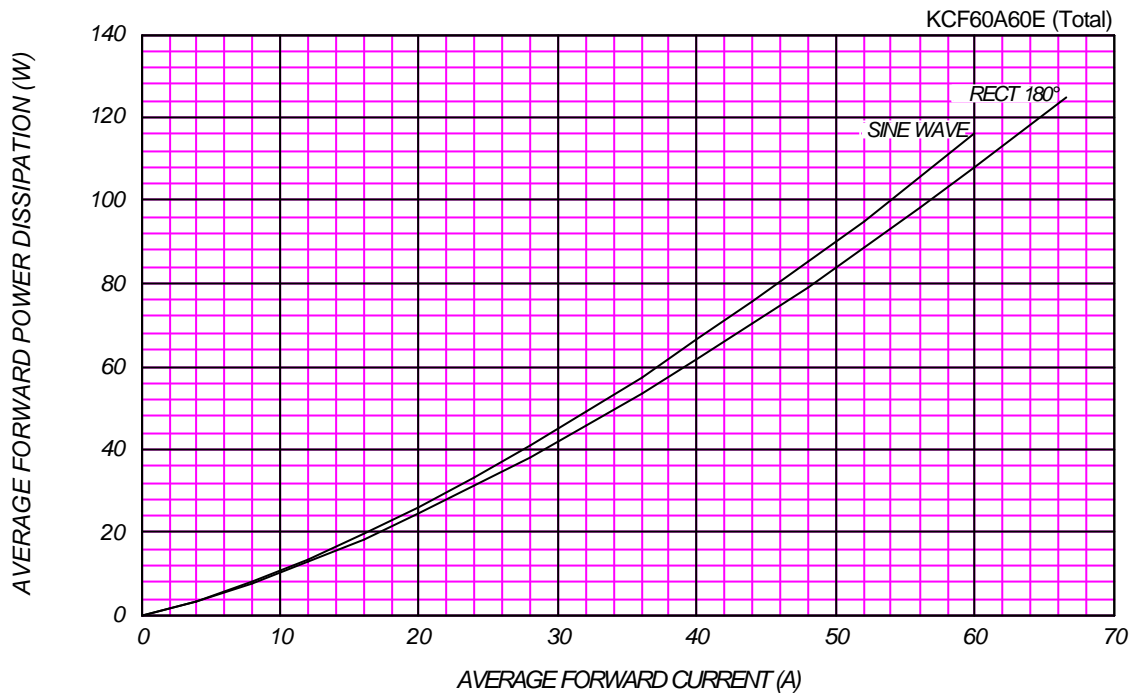

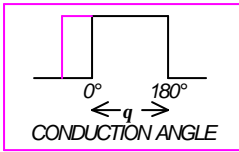

AVERAGE FORWARD CURRENT VS. CASE TEMPERATURE

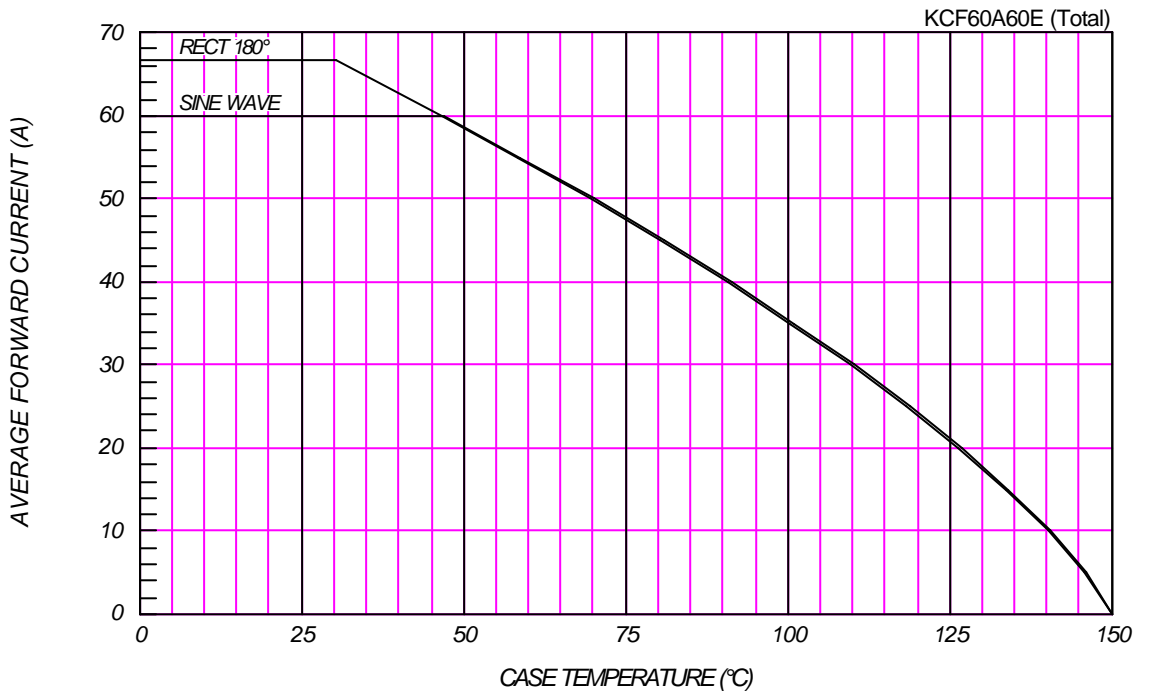

SURGE CURRENT RATINGS

f=50Hz, Sine Wave, Non-Repetitive, No Load

