

SERIES 100A SWITCHES

PROCESS SEALED MINIATURE TOGGLE SWITCHES



SPECIFICATIONS

Contact Rating: Dependent upon contact material
 Electrical Life: 40,000 make-and-break cycles at full load
 Contact Resistance: 10 mΩ max. typical initial @ 2-4 VDC 100 mA for both silver and gold plated contacts
 Insulation Resistance: 1,000 MΩ min.
 Dielectric Strength: 1,000 V RMS @ sea level
 Operating Temperature: -30° C to 85° C

MATERIALS

Case & Bushing: PBT
 Pedestal of Case: LPC
 Actuator: Brass, chrome plated with internal O-ring seal
 Switch Support: Brass or steel tin plated
 Contacts / Terminals: Silver or gold plated copper alloy

HOW TO ORDER

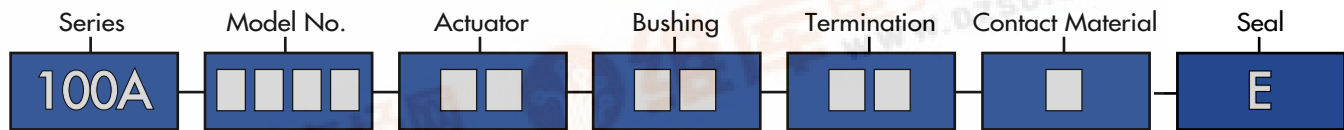

Series	Model No.	Actuator	Bushing	Termination	Contact Material	Seal
100A	WSP1 WSP2 WSP3 WSP4 WSP5 WDP1 WDP2 WDP3 WDP4 WDP5	T1 T2	B1 B4	M1 M2 M5 M6 M7 VS2 VS3 M61 M64 M71 VS21 VS31	Q=Silver R=Gold	E

EXAMPLE

100A → WDP4 → T1 → B4 → M1 → R → E

SPECIFICATIONS SUBJECT TO CHANGE WITHOUT NOTICE.

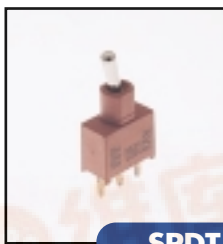

SPDT

Model No.	POS 1	POS 2	POS 3
WSP-1	ON	NONE	ON
WSP-2	ON	NONE	(ON)
WSP-3	ON	OFF	ON
WSP-4	(ON)	OFF	(ON)
WSP-5	ON	OFF	(ON)
Term. Comm.	2-3	OPEN	2-1

Schematic () = Momentary

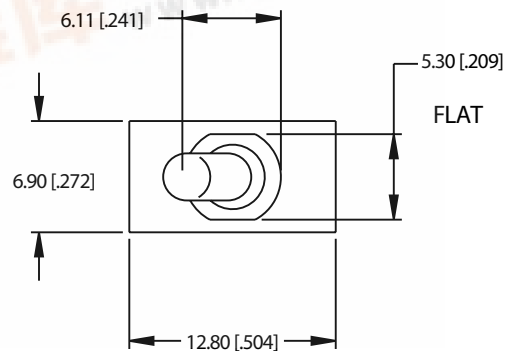

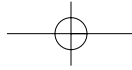

SERIES 100A SWITCHES

PROCESS SEALED MINIATURE TOGGLE SWITCHES

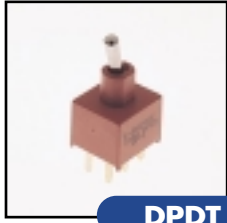

DPDT

Model No.	POS 1	POS 2	POS 3
WDP-1	ON	NONE	ON
WDP-2	ON	NONE	(ON)
WDP-3	ON	OFF	ON
WDP-4	(ON)	OFF	(ON)
WDP-5	ON	OFF	(ON)
Term. Comm.	2-3, 5-6	OPEN	2-1, 5-4

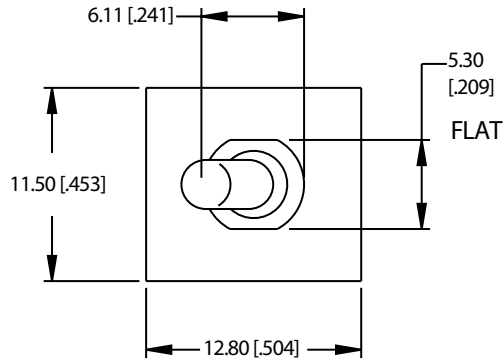
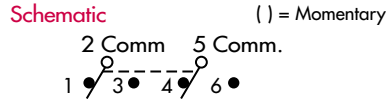

ACTUATOR OPTIONS

T1

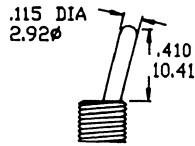

T1 actuator std. when ordered with M1 termination.
Add 0.100 (2.54) for B4 bushing.

T2

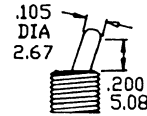

T2 actuator std. when ordered with VS, M2, M6 or M7 terminations.
Add 0.100 (2.54) for B4 bushing.

BUSHING OPTIONS

B1

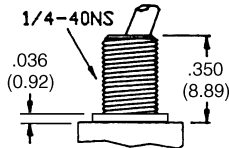

Std for M1

B4

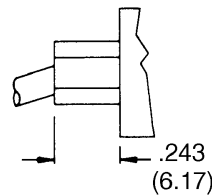

Std for M2, M6, M7, VS termination

TERMINATION OPTIONS

M1

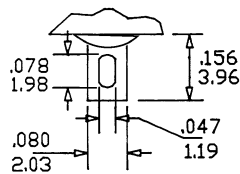

THK .030 (0.76)

M2

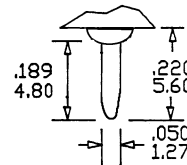

THK .030 (0.76)

SPECIFICATIONS SUBJECT TO CHANGE WITHOUT NOTICE.



SERIES 100A SWITCHES

PROCESS SEALED MINIATURE TOGGLE SWITCHES

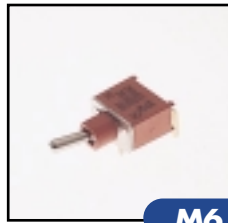

M6
SPDT

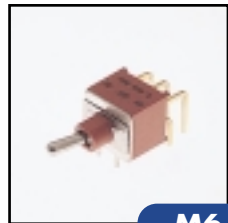
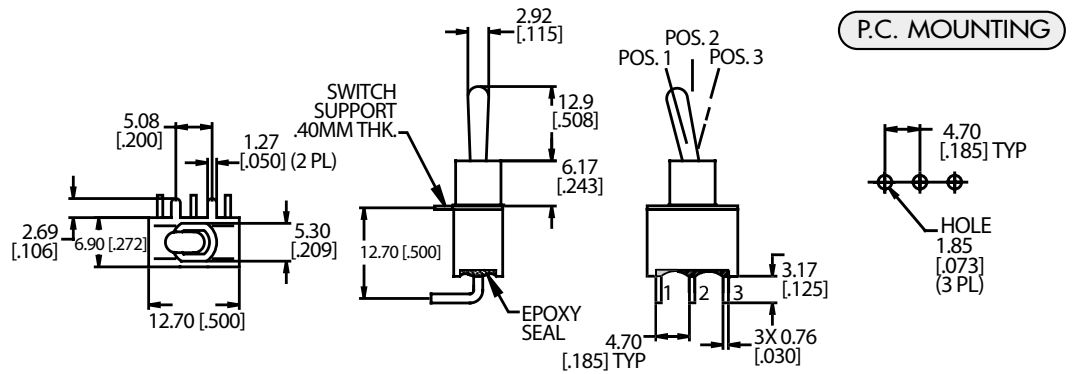

M6
DPDT

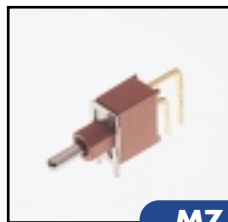
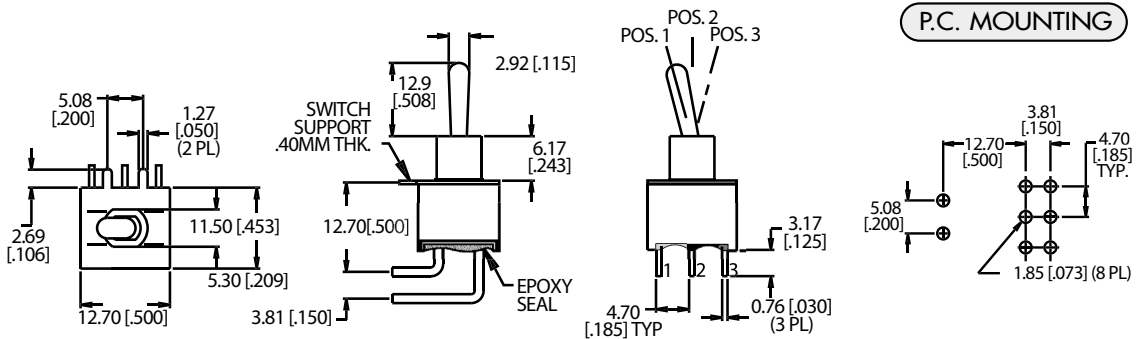

M7
SPDT

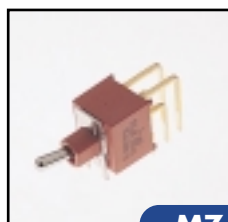
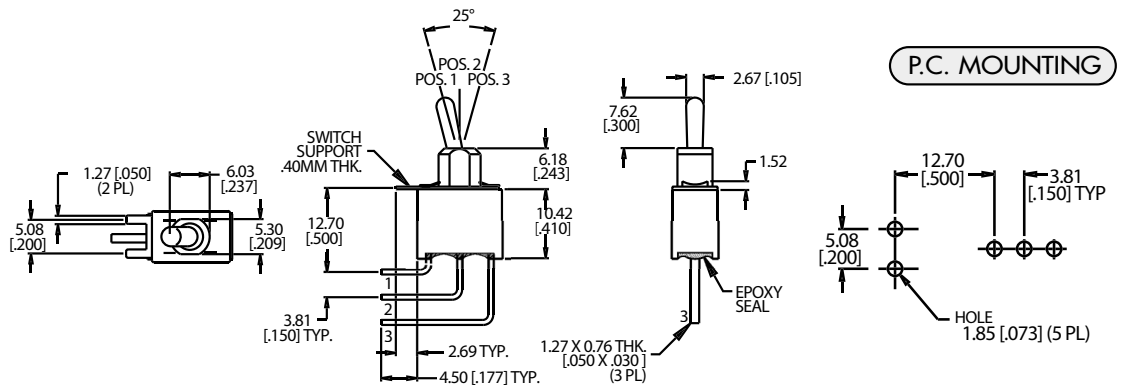

M7
DPDT

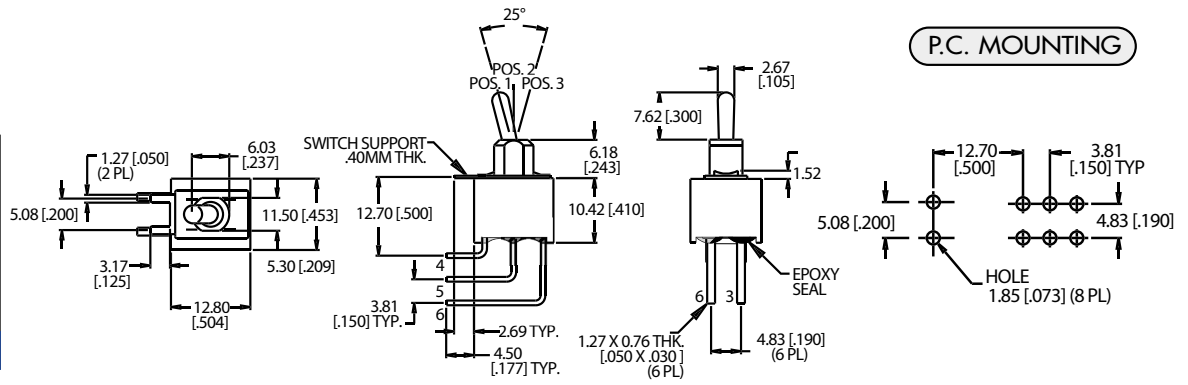

SPECIFICATIONS SUBJECT TO CHANGE WITHOUT NOTICE.

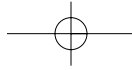

SERIES 100A SWITCHES

PROCESS SEALED MINIATURE TOGGLE SWITCHES

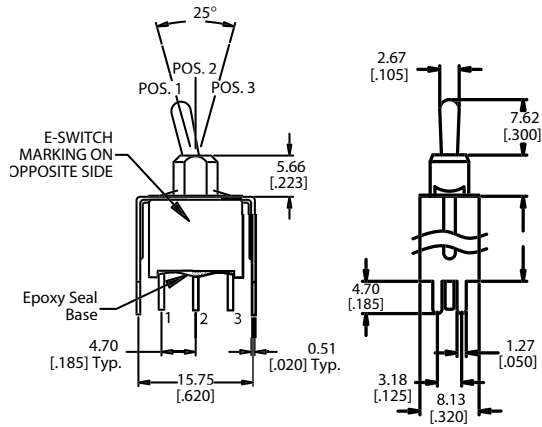

OPTION CODE	DIM. 'A'
VS2	.460 (11.68)
VS3	.630 (16.00)

P.C. MOUNTING

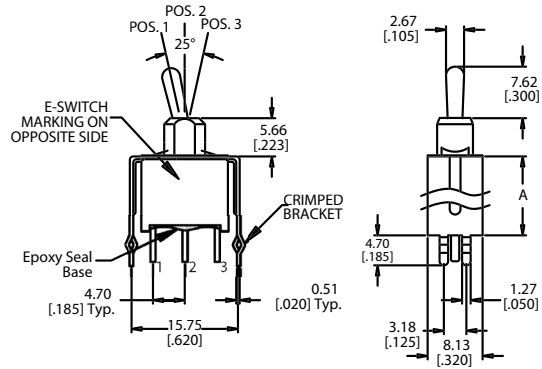
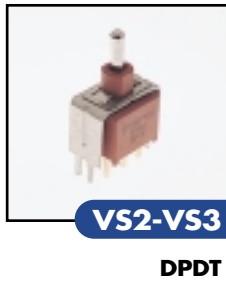
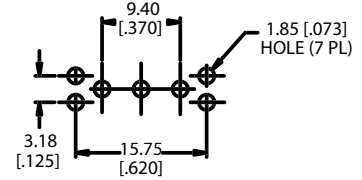

OPTION CODE	DIM. 'A'
VS2	.460 (11.68)
VS3	.630 (16.00)

P.C. MOUNTING

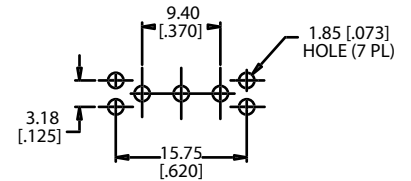

CONTACT MATERIAL OPTIONS

Q

Fixed Terminal: Gold flash over silver plated copper alloy
Moving Contact: Silver plated copper alloy
Rating: 5 Amps with resistive load @ 120VAC or 28VDC;
 2 Amps with resistive load @ 250VAC

R

Fixed Terminal: Copper alloy with gold plate over nickel plate
Moving Contact: Copper alloy with gold plate over nickel plate
Rating: 0.4 Volt-Amps (VA) max. @ 20V max. (AC or DC)

SPECIFICATIONS SUBJECT TO CHANGE WITHOUT NOTICE.

HARDWARE

HDW2 Nut

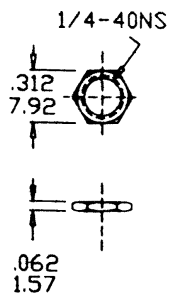

HDW15 Locking Ring

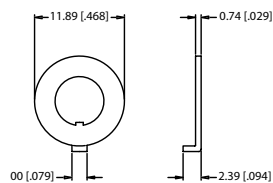

HDW11 Lock Washer

