

MOSPEC

PNP SILICON POWER TRANSISTORS

...designed for the output stage of 15W to 25W AF power amplifier

FEATURES:

- * Low Collector-Emitter Saturation Voltage
 $V_{CE(sat)} = 1.0V(\text{Max}) @ I_C=2.0A, I_B=0.2A$
- * DC Current Gain
 $hFE = 40-320 @ I_C = 1.0A$
- * Complementary to NPN 2SD313

**PNP
2SB507**

**3.0 AMPERE
POWER
TRANSISTORS
60 VOLTS
30 WATTS**

MAXIMUM RATINGS

Characteristic	Symbol	2SB507	Unit
Collector-Emitter Voltage	V_{CEO}	60	V
Collector-Base Voltage	V_{CBO}	60	V
Emitter-Base Voltage	V_{EBO}	5.0	V
Collector Current - Continuous	I_C	3.0	A
- Peak	I_{CM}	6.0	
Base current	I_B	1.0	A
Total Power Dissipation @ $T_C = 25^\circ C$ Derate above $25^\circ C$	P_D	30 0.24	W W/ $^\circ C$
Operating and Storage Junction Temperature Range	T_J, T_{STG}	-55 to +150	$^\circ C$

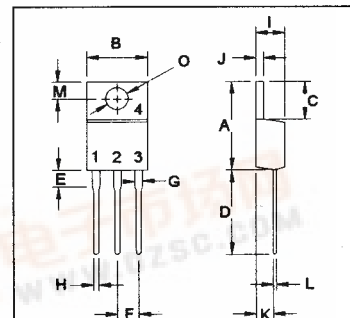
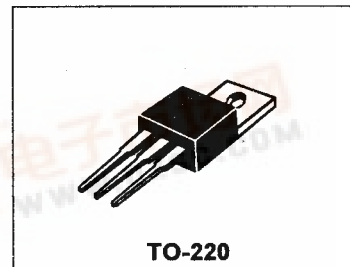

PIN 1.BASE
2.COLLECTOR
3.EMITTER
4.COLLECTOR(CASE)

THERMAL CHARACTERISTICS

Characteristic	Symbol	Max	Unit
Thermal Resistance Junction to Case	$R_{\theta jc}$	4.16	$^\circ C/W$

DIM	MILLIMETERS	
	MIN	MAX
A	14.68	15.31
B	9.78	10.42
C	5.01	6.52
D	13.06	14.62
E	3.57	4.07
F	2.42	3.66
G	1.12	1.36
H	0.72	0.96
I	4.22	4.98
J	1.14	1.38
K	2.20	2.97
L	0.33	0.55
M	2.48	2.98
O	3.70	3.90

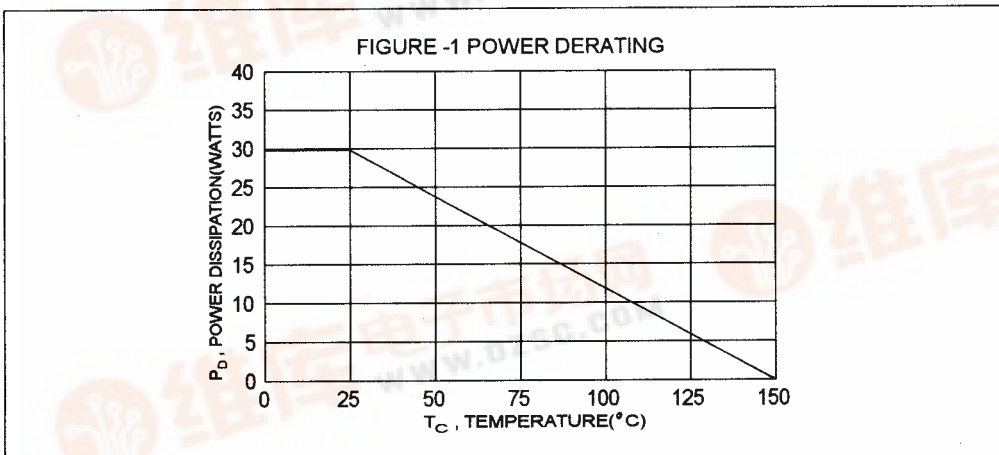

ELECTRICAL CHARACTERISTICS ($T_C = 25^\circ\text{C}$ unless otherwise noted)

Characteristic	Symbol	Min	Max	Unit
----------------	--------	-----	-----	------

OFF CHARACTERISTICS

Collector-Emitter Voltage ($I_C = 10 \text{ mA}$, $I_B = 0$)	V_{CE0}	60		V
Collector Cutoff Current ($V_{CB} = 20 \text{ V}$, $I_E = 0$)	I_{CBO}		100	μA
Collector Cutoff Current ($V_{CE} = 60 \text{ V}$, $I_B = 0$)	I_{CEO}		5.0	mA
Emitter Cutoff Current ($V_{EB} = 4.0 \text{ V}$, $I_C = 0$)	I_{EBO}		1.0	mA

ON CHARACTERISTICS (1)

DC Current Gain ($I_C = 1.0 \text{ A}$, $V_{CE} = 2.0 \text{ V}$) * ($I_C = 0.1 \text{ A}$, $V_{CE} = 2.0 \text{ V}$)	$h_{FE(2)}$ h_{FE}	40 40	320	
Collector-Emitter Saturation Voltage ($I_C = 2.0 \text{ A}$, $I_B = 200 \text{ mA}$)	$V_{CE(sat)}$		1.0	V
Base-Emitter On Voltage ($I_C = 1.0 \text{ A}$, $V_{CE} = 2.0 \text{ V}$)	$V_{BE(on)}$		1.5	V

DYNAMIC CHARACTERISTICS

Current-Gain-Bandwidth Product ($I_C = 0.5 \text{ A}$, $V_{CE} = 5.0 \text{ V}$, $f = 1.0 \text{ MHz}$)	f_T	5.0		MHz
--	-------	-----	--	-----

(1) Pulse Test: Pulse Width = 300 μs , Duty Cycle $\leq 2.0\%$ * $h_{FE(2)}$ Classification :

40	C	80	60	D	120	100	E	200	160	F	320
----	---	----	----	---	-----	-----	---	-----	-----	---	-----

Ic - Vce

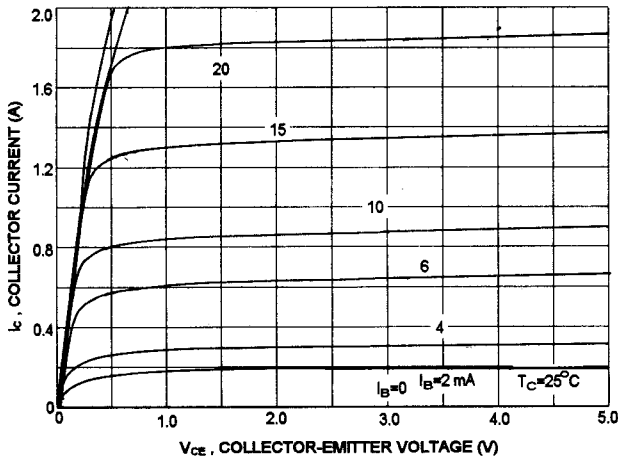

DC CURRENT GAIN

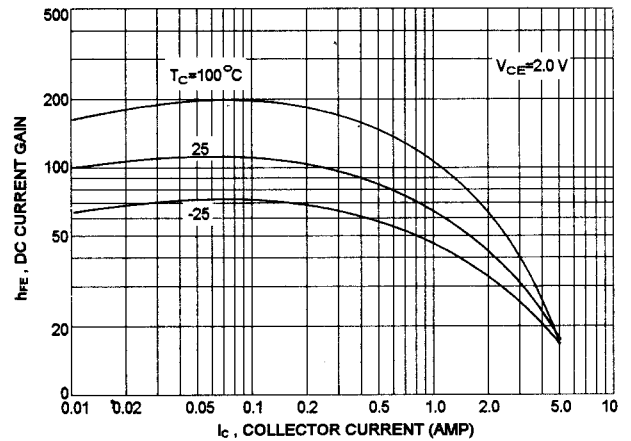

Ic - Vbe

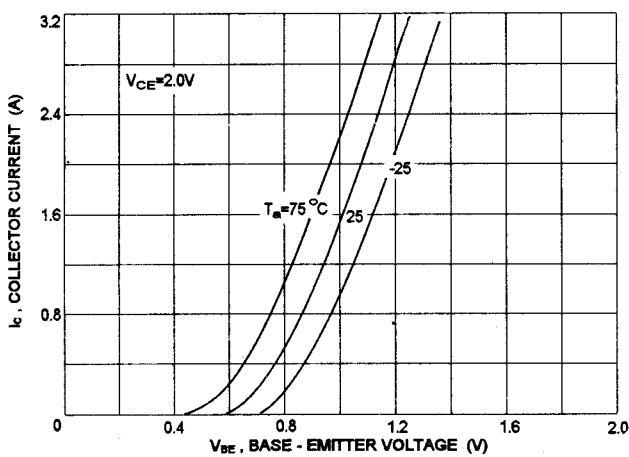

fT - Ic

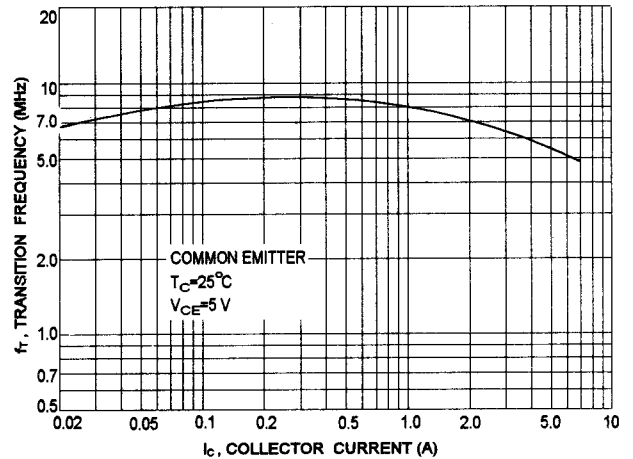

ACTIVE-REGION SAFE OPERATING AREA (SOA)

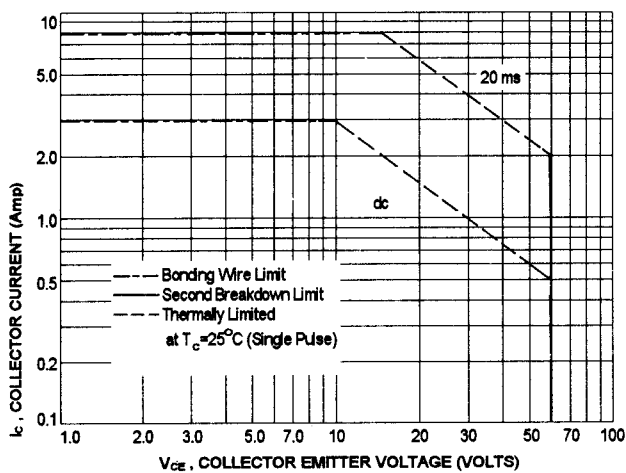

There are two limitation on the power handling ability of a transistor: average junction temperature and second breakdown safe operating area curves indicate I_c - V_{ce} limits of the transistor that must be observed for reliable operation i.e., the transistor must not be subjected to greater dissipation than curves indicate.

The data of SOA curve is base on $T_{J(PK)} = 150^\circ C$; T_c is variable depending on conditions. second breakdown pulse limits are valid for duty cycles to 10% provided $T_{J(PK)} \leq 150^\circ C$. At high case temperatures, thermal limitation will reduce the power that can be handled to values less than the limitations imposed by second breakdown.