

DATE	REV.	ECN	APP'D BY
9-26-07	C0	8241	TRM
5-30-12	C1	9481	SMN
6-4-12	D0	9498	TRM
2-17-15	D1	10260	ADB

B

B

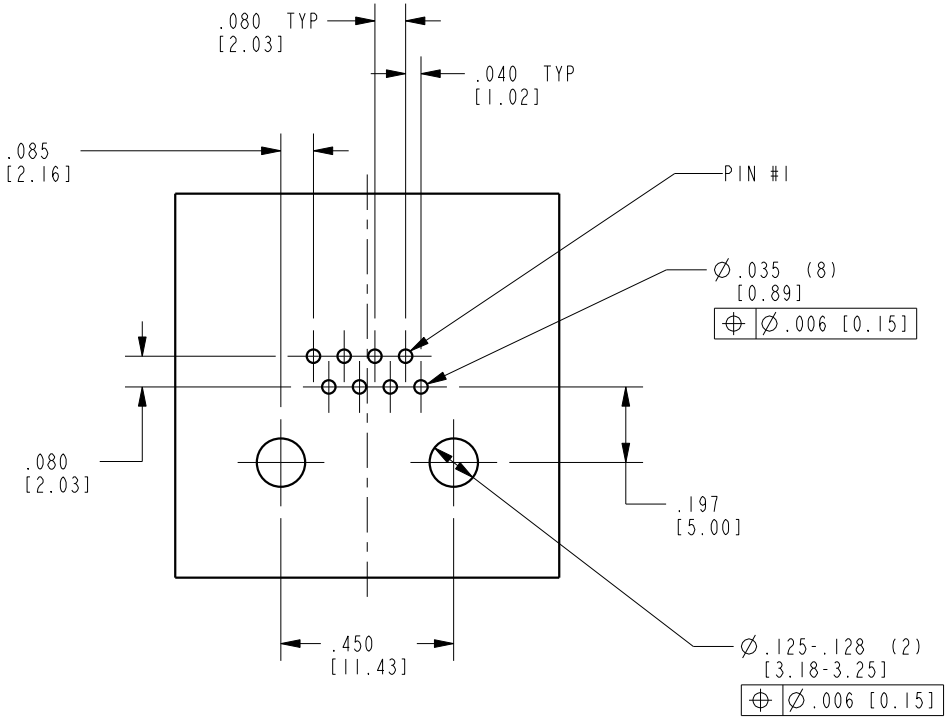
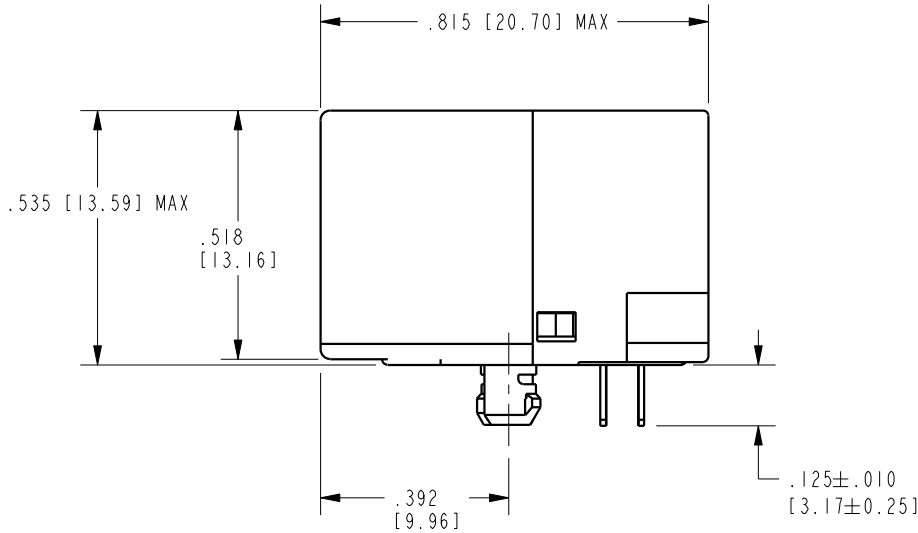
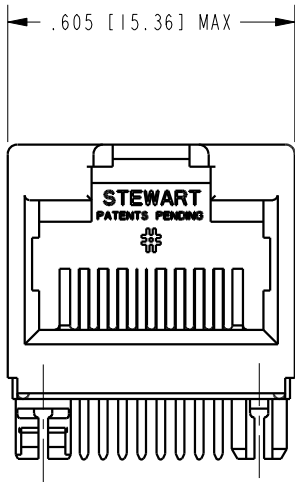

RECOMMENDED PCB HOLE LAYOUT  
SEEN FROM COMPONENT SIDE  
ALL CENTERLINE DIMENSIONS ARE BASIC

- NOTES:
- MATERIALS:  
HOUSING -- THERMOPLASTIC UL 94-V0  
CONTACTS -- COPPER ALLOY  
CONTACT PLATING -- SELECTIVE PLATING IN CONTACT AREA  
SEE CHART FOR DETAILS
  - PRODUCT DESIGNED FOR CAT6 APPLICATIONS
  - DIMENSIONS AND TOLERANCES COMPLY WITH TIA-1096 STANDARD.

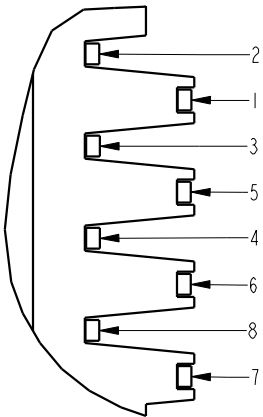

DETAIL M  
OUTPUT PIN DESIGNATIONS

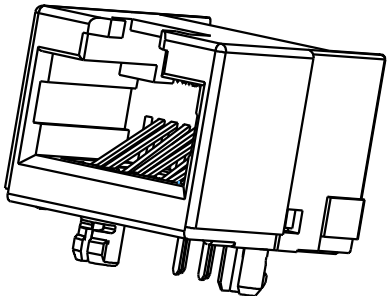
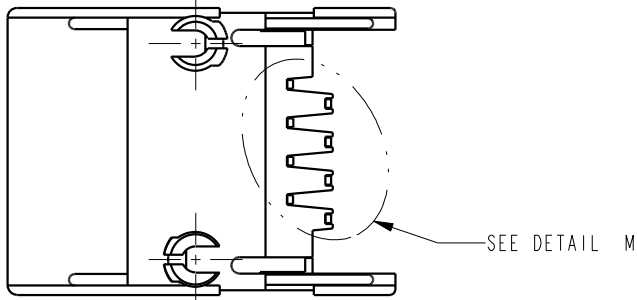

RoHS



50 MICRO-INCHES [1.27µm] Au OR 5 MICRO-INCHES [0.13µm] Au OVER 30 MICRO-INCHES [0.76µm]PdNi	SS-60000-010
CONTACT PLATING IN MATING AREA	PART NUMBER

THIRD ANGLE PROJECTION 				11118 Susquehanna Trail South Glen Rock, PA 17327-9199 (717) 235-7512 <a href="http://www.stewartconnector.com">http://www.stewartconnector.com</a>			
DO NOT SCALE DRAWING DRAWING IS SUBJECT TO CHANGE WITHOUT NOTICE		TITLE: 60 SERIES UNSHIELDED RIGHT ANGLE JACK					
DIMENSIONS: INCHES [METRIC]		THIS DRAWING AND THE SUBJECT MATTER SHOWN THEREON ARE CONFIDENTIAL AND THE PROPRIETARY PROPERTY OF STEWART CONNECTOR AND SHALL NOT BE REPRODUCED, COPIED, OR USED IN ANY MANNER WITHOUT PRIOR WRITTEN CONSENT OF STEWART CONNECTOR. THIS PRODUCT MAY BE PROTECTED BY ONE OR MORE OF THE FOLLOWING US PATENTS: 5791942 6217391 6368159 6419526 6602097 687722 6964587 7048590 7086909 7568950 7686650 OTHER PATENTS MAY BE PENDING.		DRN BY:	JRC	DATE	04-14-04
UNLESS OTHERWISE SPECIFIED TOLERANCES ARE ±.005 [0.13] ANGLES ARE ±1°				APPD BY:	RGC	DATE	04-14-04
SHEET NO. 1 OF 1				DWG. NO.	CT6000025		REV.