

NOTES:

- MATERIAL: HOUSING: GLASS FILLED LCP (LIQUID CRYSTAL POLYMER), UL94V-0, BLACK  
CONTACTS: COPPER ALLOY  
SOLDER CHARGE: 95.5% TIN, 3.8% SILVER, 0.7% COPPER
- FINISH: ALL DIM P HEIGHT OPTIONS - SELECT GOLD IN CONTACT AREA; 30 MICRONCH MINIMUM  
DIM P HEIGHT OPTIONS 2.0 & 2.5: SELECT GOLD FLASH ON TAIL, 7 MICRONCH MINIMUM  
DIM P HEIGHT OPTIONS 3.0 THRU 7.0: SELECT TIN ON TAIL, 50 MICRONCH MINIMUM  
ALL OPTIONS - NICKEL UNDERPLATE OVERALL ON TAIL
- PRODUCT SPECIFICATION: PS-45970-001
- PACKAGING SPECIFICATION: PK-45971-002 (TAPE AND REEL)
- MATES WITH SEARAY RECEPTACLE ASSEMBLY SERIES 45971
- APPLICATION SPECIFICATION: AS-45970-001
- COSMETIC SPECIFICATION: PS-45499-002 CLASS B
- PART STATUS: CONTACT MOLEX

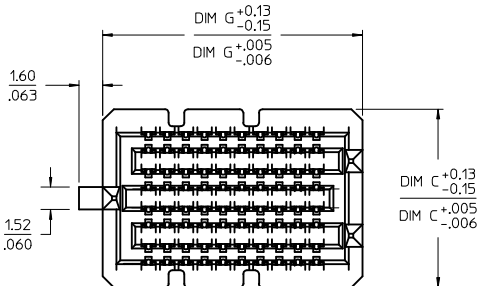

8 ROW  
10 POSITION  
SHOWN

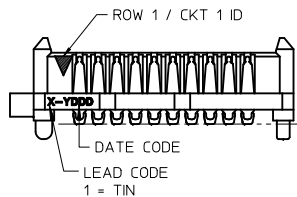

NOTE: THESE CODES MAY BE LOCATED ON EITHER SIDE OF THE HOUSING

SEE TABLE  
ACROSS ALL  
SOLDER  
CHARGES

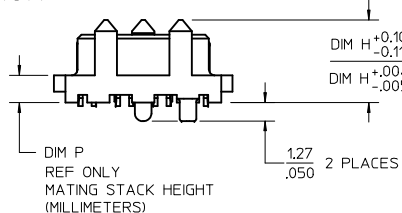

EDGE NOTCHES - SEE TABLE  
(THE NUMBER OF NOTCHES  
INCREASES AS THE NUMBER  
OF POSITIONS INCREASES)

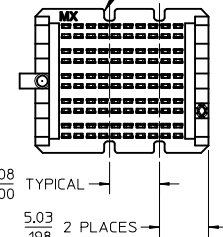

EDGE NOTCHING FOR  
10 ROW ASSEMBLIES  
(10 POSITION SHOWN)

| POSITIONS | TOTAL NUMBER OF<br>EDGE NOTCHES |              | 0.15/.006 |
|-----------|---------------------------------|--------------|-----------|
|           | 8 ROW                           | 6 AND 10 ROW |           |
| 10        | 4                               | 4            | 0.15/.006 |
| 15        | 6                               | 6            |           |
| 20        | 10                              | 10           |           |
| 25        | 12                              | 12           |           |
| 30        | 14                              | 14           |           |
| 35        | 16                              | 16           | 0.23/.009 |
| 40        | 18                              | 20           |           |
| 45        | 22                              | 22           |           |
| 50        | 24                              | 24           |           |

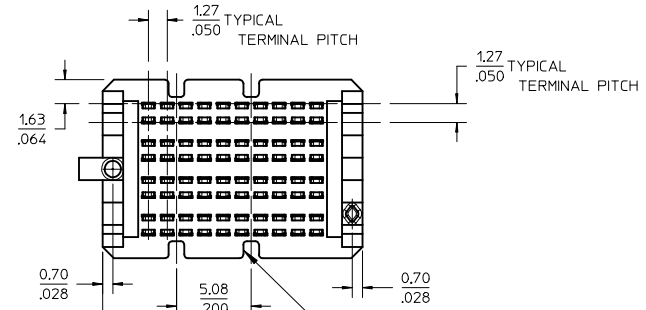

SEE OTHER EDGE NOTCHING VIEWS

SEE SHEET 3  
FOR 6 ROW OPTION

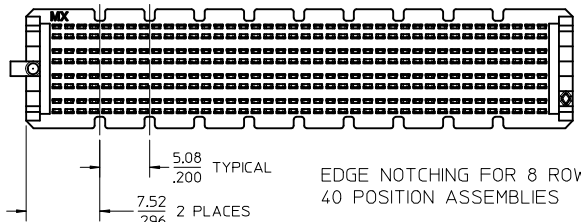

EDGE NOTCHING FOR 8 ROW,  
40 POSITION ASSEMBLIES

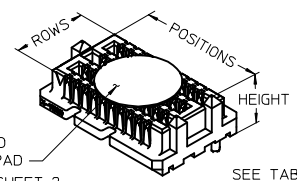

SEE SHEET 2  
FOR DIAMETERS  
SEE TABLE ON SHEET 4  
FOR HOUSING OPTIONS

|  |   |                                       |         |  |                    |  |                      |                        |  |  |
|--|---|---------------------------------------|---------|--|--------------------|--|----------------------|------------------------|--|--|
| <b>CLARIFY OVERALL LENGTH</b><br>EC NO: UCP2015-5493<br>DRWN: SVANG01 2015/06/25<br>CHKD: TIBARRA 2015/08/04<br>APPR: SMILLER 2015/08/07 | QUALITY SYMBOLS<br>$\nabla F=0$<br>$\nabla E=0$<br>$\nabla F=0$ | GENERAL TOLERANCES (UNLESS SPECIFIED) |         | DIMENSION STYLE<br>MM/IN                             |                    | SCALE<br>3:1   | DESIGN UNITS<br>INCH | THIRD ANGLE PROJECTION |  |  |
|  |   | 4 PLACES ± --- ± ---                  | mm INCH | DRAWN BY<br>TREGOR I                                 | DATE<br>2005/01/27 | TITLE<br>SEARAY<br>PLUG ASSEMBLY<br>1.27/.050 CENTERS<br><b>molex</b><br>MATERIAL NO. SEE TABLE SHT 4<br>DOCUMENT NO. SD-45970-001<br>SHEET NO. 1 OF 4 |                      |                        |  |  |
|  |   | 3 PLACES ± --- ± .010                 |         | CHECKED BY<br>BBARKER                                | DATE<br>2014/08/07 |  |                      |                        |  |  |
|  |   | 2 PLACES ± 0.25 ± .015                |         | APPROVED BY<br>JCOMERCI                              | DATE<br>2010/03/05 |  |                      |                        |  |  |
| 1 PLACE ± 0.38 ± ---   |   |                                       |         |  |                    |  |                      |                        |  |  |
| 0 PLACE ± ±  |   | ANGULAR ± --- °                       |         | DRAFT WHERE APPLICABLE MUST REMAIN WITHIN DIMENSIONS |                    |  |                      |                        |  |  |

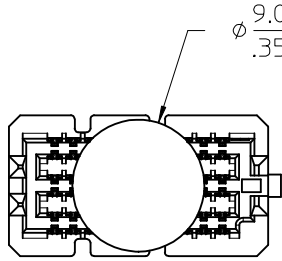

6 ROW OPTION

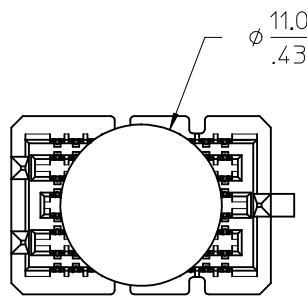

8 ROW OPTION

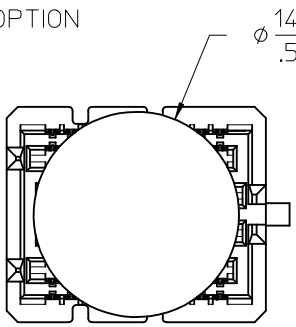

10 ROW OPTION

PICK AND PLACE  
PAD DIAMETERS  
10 POSITION VERSIONS SHOWN

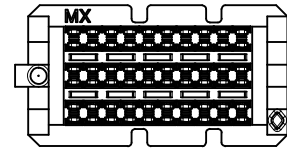
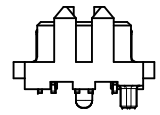
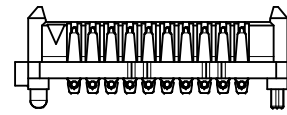
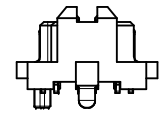
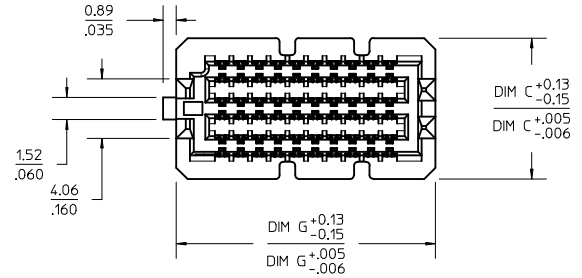

6 ROW OPTION  
10 POSITION VERSION  
SHOWN FOR REFERENCE

DIMENSIONS SHOWN ON  
OTHER SHEETS APPLY TO  
THE 6 ROW OPTION ALSO  
(EXCEPT AS OTHERWISE  
NOTED ON THIS SHEET)

| SEE SHEET 1   | EC NO: UCP2015-5493<br>DRWN: SVANG01 2015/06/25<br>CHKD: TIBARRA 2015/08/04<br>APPR: SMILLER 2015/08/07 | DESCRIPTION                     | QUALITY SYMBOLS                              | GENERAL TOLERANCES (UNLESS SPECIFIED)   | DIMENSION STYLE  | SCALE   | DESIGN UNITS | THIRD ANGLE PROJECTION |                  |                  |  |                  |                     |          |            |            |         |            |                  |         |       |       |       |     |      |  |
|---|---|---------------------------------|--|---|------------------|---------|--------------|------------------------|------------------|------------------|--|------------------|---------------------|----------|------------|------------|---------|------------|------------------|---------|-------|-------|-------|-----|------|--|
|   |   |                                 | $\nabla = 0$<br>$\nabla = 0$<br>$\nabla = 0$ | <table border="1"> <thead> <tr> <th></th> <th>mm</th> <th>INCH</th> </tr> </thead> <tbody> <tr> <td>4 PLACES</td> <td><math>\pm \text{---}</math></td> <td><math>\pm \text{---}</math></td> </tr> <tr> <td>3 PLACES</td> <td><math>\pm \text{---}</math></td> <td><math>\pm .010</math></td> </tr> <tr> <td>2 PLACES</td> <td><math>\pm 0.25</math></td> <td><math>\pm .015</math></td> </tr> <tr> <td>1 PLACE</td> <td><math>\pm 0.38</math></td> <td><math>\pm \text{---}</math></td> </tr> <tr> <td>0 PLACE</td> <td><math>\pm</math></td> <td><math>\pm</math></td> </tr> </tbody> </table> |                  | mm      | INCH         | 4 PLACES               | $\pm \text{---}$ | $\pm \text{---}$ | 3 PLACES                                     | $\pm \text{---}$ | $\pm .010$          | 2 PLACES | $\pm 0.25$ | $\pm .015$ | 1 PLACE | $\pm 0.38$ | $\pm \text{---}$ | 0 PLACE | $\pm$ | $\pm$ | MM/IN | 3:1 | INCH |  |
|   |   |                                 |  | mm  | INCH             |         |              |                        |                  |                  |  |                  |                     |          |            |            |         |            |                  |         |       |       |       |     |      |  |
|   |   |                                 | 4 PLACES                                     | $\pm \text{---}$  | $\pm \text{---}$ |         |              |                        |                  |                  |  |                  |                     |          |            |            |         |            |                  |         |       |       |       |     |      |  |
| 3 PLACES  | $\pm \text{---}$  | $\pm .010$                      |  |   |                  |         |              |                        |                  |                  |  |                  |                     |          |            |            |         |            |                  |         |       |       |       |     |      |  |
| 2 PLACES  | $\pm 0.25$  | $\pm .015$                      |  |   |                  |         |              |                        |                  |                  |  |                  |                     |          |            |            |         |            |                  |         |       |       |       |     |      |  |
| 1 PLACE   | $\pm 0.38$  | $\pm \text{---}$                |  |   |                  |         |              |                        |                  |                  |  |                  |                     |          |            |            |         |            |                  |         |       |       |       |     |      |  |
| 0 PLACE   | $\pm$   | $\pm$                           |  |   |                  |         |              |                        |                  |                  |  |                  |                     |          |            |            |         |            |                  |         |       |       |       |     |      |  |
| <table border="1"> <thead> <tr> <th>DATE</th> <th>BY</th> </tr> </thead> <tbody> <tr> <td>2005/01/27</td> <td>TGREGORI</td> </tr> <tr> <td>2014/08/07</td> <td>BBARKER</td> </tr> <tr> <td>2010/03/05</td> <td>JCOMERC I</td> </tr> </tbody> </table> | DATE  | BY                              | 2005/01/27                                   | TGREGORI  | 2014/08/07       | BBARKER | 2010/03/05   | JCOMERC I              | TITLE            |                  | SEARAY<br>PLUG ASSEMBLY<br>1.27/.050 CENTERS |                  | SHEET NO.<br>2 OF 4 |          |            |            |         |            |                  |         |       |       |       |     |      |  |
| DATE  | BY  |                                 |  |   |                  |         |              |                        |                  |                  |  |                  |                     |          |            |            |         |            |                  |         |       |       |       |     |      |  |
| 2005/01/27  | TGREGORI  |                                 |  |   |                  |         |              |                        |                  |                  |  |                  |                     |          |            |            |         |            |                  |         |       |       |       |     |      |  |
| 2014/08/07  | BBARKER   |                                 |  |   |                  |         |              |                        |                  |                  |  |                  |                     |          |            |            |         |            |                  |         |       |       |       |     |      |  |
| 2010/03/05  | JCOMERC I   |                                 |  |   |                  |         |              |                        |                  |                  |  |                  |                     |          |            |            |         |            |                  |         |       |       |       |     |      |  |
| DRAFT WHERE APPLICABLE<br>MUST REMAIN<br>WITHIN DIMENSIONS  |   | MATERIAL NO.<br>SEE TABLE SHT 4 | DOCUMENT NO.<br>SD-45970-001                 |   |                  |         |              |                        |                  |                  |  |                  |                     |          |            |            |         |            |                  |         |       |       |       |     |      |  |
| THIS DRAWING CONTAINS INFORMATION THAT IS PROPRIETARY TO MOLEX<br>INCORPORATED AND SHOULD NOT BE USED WITHOUT WRITTEN PERMISSION  |   |                                 |  |   |                  |         |              |                        |                  |                  |  |                  |                     |          |            |            |         |            |                  |         |       |       |       |     |      |  |



ROWS: 6 DIMENSION C = 9.60/.378

| DIM P:   |             | 2.0 MM      | 3.0 MM      | 3.5 MM      | 2.5 MM      | 4.5 MM      | 5.0 MM      | 7.0 MM      |
|----------|-------------|-------------|-------------|-------------|-------------|-------------|-------------|-------------|
| DIM H:   |             | 5.61/.221   | 6.60/.260   | 7.11/.280   | 6.12/.241   | 8.10/.319   | 8.61/.339   | 10.61/.418  |
| POSITION | DIM G       | MATERIAL NO | MATERIAL NO | MATERIAL NO | MATERIAL NO | MATERIAL NO | MATERIAL NO | MATERIAL NO |
| 10       | 17.69/0.698 | 45970-1165  | 45970-1265  | 45970-1365  | 45970-1465  | 45970-1565  | 45970-1665  | 45970-1765  |
| 20       | 30.39/1.198 | 45970-2165  | 45970-2265  | 45970-2365  | 45970-2465  | 45970-2565  | 45970-2665  | 45970-2765  |
| 30       | 43.09/1.698 | 45970-3165  | 45970-3265  | 45970-3365  | 45970-3465  | 45970-3565  | 45970-3665  | 45970-3765  |
| 40       | 55.79/2.198 | 45970-4165  | 45970-4265  | 45970-4365  | 45970-4465  | 45970-4565  | 45970-4665  | 45970-4765  |
| 50       | 68.49/2.698 | 45970-5165  | 45970-5265  | 45970-5365  | 45970-5465  | 45970-5565  | 45970-5665  | 45970-5765  |
| 15       | 24.04/0.948 | 45970-6165  | 45970-6265  | 45970-6365  | 45970-6465  | 45970-6565  | 45970-6665  | 45970-6765  |
| 25       | 36.74/1.448 | 45970-7165  | 45970-7265  | 45970-7365  | 45970-7465  | 45970-7565  | 45970-7665  | 45970-7765  |
| 35       | 49.44/1.948 | 45970-8165  | 45970-8265  | 45970-8365  | 45970-8465  | 45970-8565  | 45970-8665  | 45970-8765  |
| 45       | 62.14/2.448 | 45970-9165  | 45970-9265  | 45970-9365  | 45970-9465  | 45970-9565  | 45970-9665  | 45970-9765  |

ROWS: 8 DIMENSION C = 12.14/.478

| DIM P:   |             | 2.0 MM      | 3.0 MM      | 3.5 MM      | 2.5 MM      | 4.5 MM      | 5.0 MM      | 7.0 MM      |
|----------|-------------|-------------|-------------|-------------|-------------|-------------|-------------|-------------|
| DIM H:   |             | 5.61/.221   | 6.60/.260   | 7.11/.280   | 6.12/.241   | 8.10/.319   | 8.61/.339   | 10.61/.418  |
| POSITION | DIM G       | MATERIAL NO | MATERIAL NO | MATERIAL NO | MATERIAL NO | MATERIAL NO | MATERIAL NO | MATERIAL NO |
| 10       | 17.69/0.698 | 45970-1185  | 45970-1285  | 45970-1385  | 45970-1485  | 45970-1585  | 45970-1685  | 45970-1785  |
| 20       | 30.39/1.198 | 45970-2185  | 45970-2285  | 45970-2385  | 45970-2485  | 45970-2585  | 45970-2685  | 45970-2785  |
| 30       | 43.09/1.698 | 45970-3185  | 45970-3285  | 45970-3385  | 45970-3485  | 45970-3585  | 45970-3685  | 45970-3785  |
| 40       | 55.79/2.198 | 45970-4185  | 45970-4285  | 45970-4385  | 45970-4485  | 45970-4585  | 45970-4685  | 45970-4785  |
| 50       | 68.49/2.698 | 45970-5185  | 45970-5285  | 45970-5385  | 45970-5485  | 45970-5585  | 45970-5685  | 45970-5785  |
| 15       | 24.04/0.948 | 45970-6185  | 45970-6285  | 45970-6385  | 45970-6485  | 45970-6585  | 45970-6685  | 45970-6785  |
| 25       | 36.74/1.448 | 45970-7185  | 45970-7285  | 45970-7385  | 45970-7485  | 45970-7585  | 45970-7685  | 45970-7785  |
| 35       | 49.44/1.948 | 45970-8185  | 45970-8285  | 45970-8385  | 45970-8485  | 45970-8585  | 45970-8685  | 45970-8785  |
| 45       | 62.14/2.448 | 45970-9185  | 45970-9285  | 45970-9385  | 45970-9485  | 45970-9585  | 45970-9685  | 45970-9785  |

ROWS: 10 DIMENSION C = 14.68/.578

| DIM P:   |             | 2.0 MM      | 3.0 MM      | 3.5 MM      | 2.5 MM      | 4.5 MM      | 5.0 MM      | 7.0 MM      | 9.0 MM      |
|----------|-------------|-------------|-------------|-------------|-------------|-------------|-------------|-------------|-------------|
| DIM H:   |             | 5.61/.221   | 6.60/.260   | 7.11/.280   | 6.12/.241   | 8.10/.319   | 8.61/.339   | 10.61/.418  | 12.62/.497  |
| POSITION | DIM G       | MATERIAL NO | MATERIAL NO | MATERIAL NO | MATERIAL NO | MATERIAL NO | MATERIAL NO | MATERIAL NO | MATERIAL NO |
| 10       | 17.69/0.698 | 45970-1115  | 45970-1215  | 45970-1315  | 45970-1415  | 45970-1515  | 45970-1615  | 45970-1715  | 45970-1915  |
| 20       | 30.39/1.198 | 45970-2115  | 45970-2215  | 45970-2315  | 45970-2415  | 45970-2515  | 45970-2615  | 45970-2715  | 45970-2915  |
| 30       | 43.09/1.698 | 45970-3115  | 45970-3215  | 45970-3315  | 45970-3415  | 45970-3515  | 45970-3615  | 45970-3715  | 45970-3915  |
| 40       | 55.79/2.198 | 45970-4115  | 45970-4215  | 45970-4315  | 45970-4415  | 45970-4515  | 45970-4615  | 45970-4715  | 45970-4915  |
| 50       | 68.49/2.698 | 45970-5115  | 45970-5215  | 45970-5315  | 45970-5415  | 45970-5515  | 45970-5615  | 45970-5715  | 45970-5915  |
| 15       | 24.04/0.948 | 45970-6115  | 45970-6215  | 45970-6315  | 45970-6415  | 45970-6515  | 45970-6615  | 45970-6715  | 45970-6915  |
| 25       | 36.74/1.448 | 45970-7115  | 45970-7215  | 45970-7315  | 45970-7415  | 45970-7515  | 45970-7615  | 45970-7715  | 45970-7915  |
| 35       | 49.44/1.948 | 45970-8115  | 45970-8215  | 45970-8315  | 45970-8415  | 45970-8515  | 45970-8615  | 45970-8715  | 45970-8915  |
| 45       | 62.14/2.448 | 45970-9115  | 45970-9215  | 45970-9315  | 45970-9415  | 45970-9515  | 45970-9615  | 45970-9715  | 45970-9915  |

MATING STACK HEIGHTS (DIMENSION P)  
GIVEN IN MILLIMETERS (MM) FOR REFERENCE ONLY

|  |  |   |   |   |  |                        |
|--|--|---|---|---|--|------------------------|
| SEE SHEET 1<br>EC NO: UCP2015-5493<br>DRWN: SVANG01 2015/06/25<br>CHKD: TIBARRA 2015/08/04<br>APPR: SMILLER 2015/08/07 | QUALITY SYMBOLS                              | GENERAL TOLERANCES (UNLESS SPECIFIED)   | DIMENSION STYLE   | SCALE   | DESIGN UNITS   | THIRD ANGLE PROJECTION |
|  | $\nabla F=0$<br>$\nabla E=0$<br>$\nabla D=0$ | mm INCH<br>4 PLACES ± --- ± ---<br>3 PLACES ± --- ± .010<br>2 PLACES ± 0.25 ± .015<br>1 PLACE ± 0.38 ± ---<br>0 PLACE ± ± | MM/IN   | 4:1   | INCH   |                        |
|  | DESCRIPTION                                  | ANGULAR ± --- °   | DRAWN BY DATE   | TITLE   | SEARAY<br>PLUG ASSEMBLY<br>1.27/.050 CENTERS<br><b>molex</b> |                        |
|  | REV  | DRAFT WHERE APPLICABLE MUST REMAIN WITHIN DIMENSIONS  | CHECKED BY DATE   | TGREGORI 2005/01/27<br>BBARKER 2014/08/07<br>JCOMERC I 2010/03/05 |  |                        |
|  |  | MATERIAL NO.  | DOCUMENT NO.  | SD-45970-001  |  | SHEET NO. 4 OF 4       |
|  |  | SIZE B  | THIS DRAWING CONTAINS INFORMATION THAT IS PROPRIETARY TO MOLEX INCORPORATED AND SHOULD NOT BE USED WITHOUT WRITTEN PERMISSION |   |  |                        |