

2 CIRCUIT RECEPTACLE WITH LOCK BRIDGE
POLARIZATION OPTION A

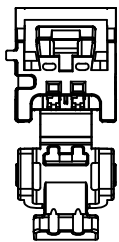

2 CIRCUIT RECEPTACLE WITH LOCK BRIDGE
POLARIZATION OPTION B

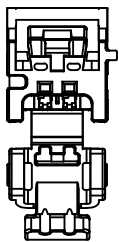

2 CIRCUIT RECEPTACLE WITH LOCK BRIDGE
POLARIZATION OPTION C

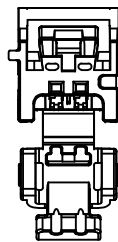

2 CIRCUIT RECEPTACLE WITH LOCK BRIDGE
POLARIZATION OPTION D

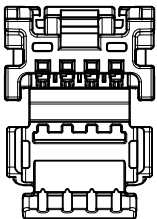

4 CIRCUIT RECEPTACLE WITHOUT LOCK BRIDGE
POLARIZATION OPTION A

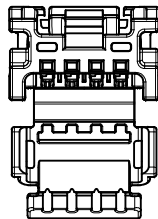

4 CIRCUIT RECEPTACLE WITHOUT LOCK BRIDGE
POLARIZATION OPTION B

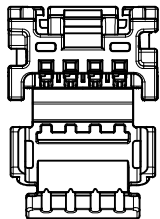

4 CIRCUIT RECEPTACLE WITHOUT LOCK BRIDGE
POLARIZATION OPTION C

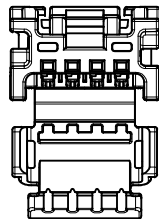

4 CIRCUIT RECEPTACLE WITHOUT LOCK BRIDGE
POLARIZATION OPTION D

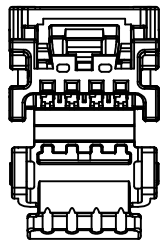

4 CIRCUIT RECEPTACLE BRIDGED
POLARIZATION OPTION A

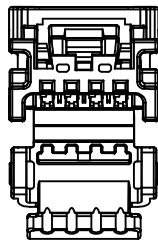

4 CIRCUIT RECEPTACLE BRIDGED
POLARIZATION OPTION B

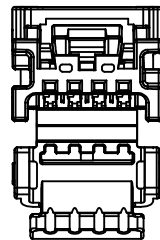

4 CIRCUIT RECEPTACLE BRIDGED
POLARIZATION OPTION C

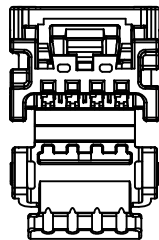

4 CIRCUIT RECEPTACLE BRIDGED
POLARIZATION OPTION D

NOTES: VALID UNLESS OTHERWISE SPECIFIED

1. GENERAL:
 - a. APPLICATION SPECIFICATION SEE: AS-34791-020
 - b. PRODUCT SPECIFICATION SEE: PS-34971-020
 - c. PACKAGING SPECIFICATION PER MOLEX DRAWING: PK-31301-538
 - d. PARTS MUST BE IN COMPLIANCE TO MOLEX CHEMICAL SUBSTANCES FOR PRODUCTS AND PACKAGING SPECIFICATION: PS-40000-5015
 - e. DATA MUST BE SUBMITTED UNDER THE MOLEX PART NUMBER TO IMDS (COMPANY ID=13255)
 - f. FLAMMABILITY REQUIREMENT: PER ISO3795 OR GM3191
 1. BURN RATE 100 mm/MIN MAXIMUM
 2. MATERIAL MUST BE SELF EXTINGUISHING
 - g. VISUAL DEFECTS SHALL MEET COSMETIC STANDARD PS-45499-002 (Class B)
 - h. FOR TERMINAL USAGE, REFER TO MOLEX SALES DRAWING SD-560023-002.
2. DESIGN - MATERIALS:
 - a. MATERIAL: UNFILLED PBT
3. DESIGN - GEOMETRY:
 - a. THIS IS A 100% CAD GENERATED PART. THE CAD MATHEMATICAL DATA IS THE MASTER FOR THIS PART. FOR DIMENSIONAL OR ANY INFORMATION NOT SHOWN ON THIS DRAWING, ANALYZE THE CAD MODEL.
 - b. GEOMETRIC DIMENSIONS AND TOLERANCES PER ASME Y14.5M - 1994
 - c. GENERAL TOLERANCES:
 - LINEAR: PER DIN 16901 CODE B FOR PRECISION ENGINEERING
 - ANGULAR: $\pm 3^\circ$
 - d. EDGES AND UNDIMENSIONED DETAILS PER ISO13715
 - e. CORNERS SHOWN AS SHARP TO BE R 0.2 MAX
 - f. LETTERING SHALL BE 0.1 MAX RAISED IN 0.15 MAX RECESS PAD AND NOT PROTRUDE THE SURFACE. THIS INCLUDES RECYCLING CODE, PLANT AND CAVITY ID, VENDOR ID, CIRCUIT ID, AND PART SERIES NUMBER.
4. DESIGN - FUNCTIONALITY
 - a. HINGE DOES NOT AFFECT FUNCTION OF THE PART.

LAST BALLOON ON DRAWING:

10

DELETED BALLOONS:

ADDED ZCKT EC NO: UAU2016-0996 DRAWN BY: J CHKD: J APPR: RBALMAN 2016/01/04 2015/10/23 DRINKHEWITT	QUALITY SYMBOLS	GENERAL TOLERANCES (UNLESS SPECIFIED)	DIMENSION STYLE	SCALE	DESIGN UNITS	THIRD ANGLE PROJECTION
	∇=0 ∇=0 ∇=0	mm INCH 4 PLACES ± --- ± --- 3 PLACES ± --- ± --- 2 PLACES ± --- ± --- 1 PLACE ± --- ± --- ANGULAR ± ---°	MM ONLY DRAWN BY: JDUNAJ DATE: 2010/06/24 CHECKED BY: BDLCK DATE: 2010/06/24 APPROVED BY: SMARCEAU DATE: 2011/11/21	6:1	METRIC	MINISO SINGLE ROW RECEPTACLE SALES DRAWING molex
	DRAFT WHERE APPLICABLE MUST REMAIN WITHIN DIMENSIONS	MATERIAL NO: SEE TABLE	DOCUMENT NO: SD-34791-001	SHEET NO: 1 OF 5		

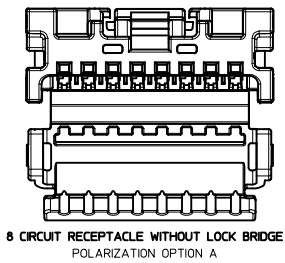

8 CIRCUIT RECEPTACLE WITHOUT LOCK BRIDGE
POLARIZATION OPTION A

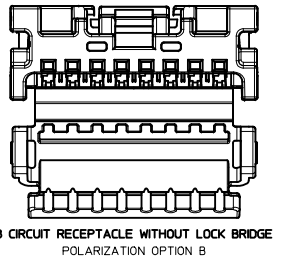

8 CIRCUIT RECEPTACLE WITHOUT LOCK BRIDGE
POLARIZATION OPTION B

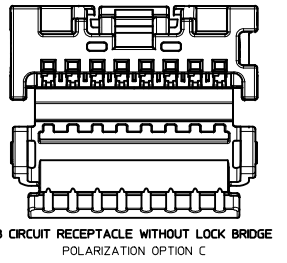

8 CIRCUIT RECEPTACLE WITHOUT LOCK BRIDGE
POLARIZATION OPTION C

HINGE OPEN

2 CIRCUIT RECEPTACLE SHOWN
(AS SHIPPED)

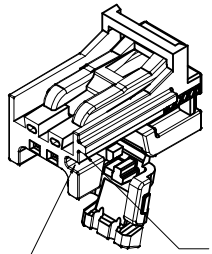

POLARIZATION
FEATURE
LOCATION

POLARIZATION
FEATURE
LOCATION

HINGE CLOSED

2 CIRCUIT RECEPTACLE SHOWN
(AS ASSEMBLED)

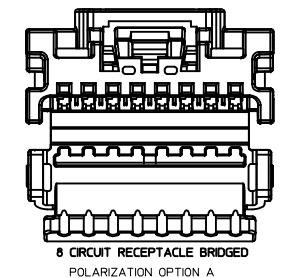
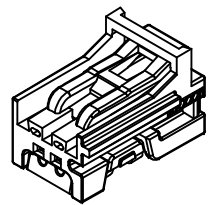

8 CIRCUIT RECEPTACLE BRIDGED
POLARIZATION OPTION A

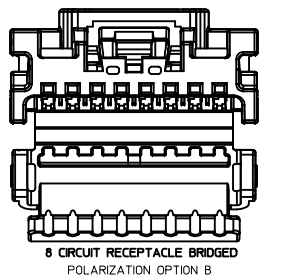

8 CIRCUIT RECEPTACLE BRIDGED
POLARIZATION OPTION B

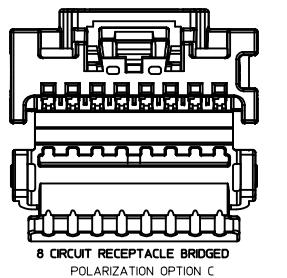

8 CIRCUIT RECEPTACLE BRIDGED
POLARIZATION OPTION C

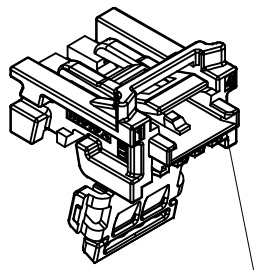

MIN50 WITH BRIDGE OPTION
COMES WITH CPA TRAY

*REFER TO SD-34824-003 FOR
CPA-RECEPTACLE ASSEMBLIES

HINGE OPEN

4 CIRCUIT RECEPTACLE SHOWN
(AS SHIPPED)

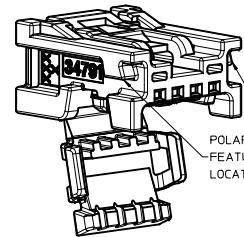

POLARIZATION
FEATURE
LOCATIONS

HINGE CLOSED

4 CIRCUIT RECEPTACLE SHOWN
(AS ASSEMBLED)

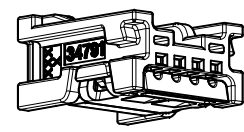

ADDED ZCKT EC NO: UAU2016-0996 DRAWN: HEWITT CHKD: APPR: BRALMAN 2015/10/23 2016/01/04	QUALITY SYMBOLS	GENERAL TOLERANCES (UNLESS SPECIFIED)	DIMENSION STYLE	SCALE	DESIGN UNITS	THIRD ANGLE PROJECTION	
	▽=0	mm INCH	MM ONLY	5:1	METRIC	☉	
	▽=0	4 PLACES ±--- ±--- 3 PLACES ±--- ±--- 2 PLACES ±--- ±--- 1 PLACE ±--- ±--- 0 PLACE ±	DRAWN BY DATE JDUNAJ 2010/06/24	TITLE MIN50 SINGLE ROW RECEPTACLE SALES DRAWING			
	▽=0	ANGULAR ±---°	CHECKED BY DATE BDICK 2010/06/24	APPROVED BY DATE SMARCEAU 2011/11/21			
REVISION	DESCRIPTION	DRAFT WHERE APPLICABLE MUST REMAIN WITHIN DIMENSIONS	MATERIAL NO.	SEE TABLE	DOCUMENT NO.	SHEET NO.	
					SD-34791-001	2 OF 5	
THIS DRAWING CONTAINS INFORMATION THAT IS PROPRIETARY TO MOLEX INCORPORATED AND SHOULD NOT BE USED WITHOUT WRITTEN PERMISSION							

20 19 18 17 16 15 14 13 12 11 10 9 8 7 6 5 4 3 2 1

(NON-BRIDGED 4 CKT OPTION SHOWN BELOW)

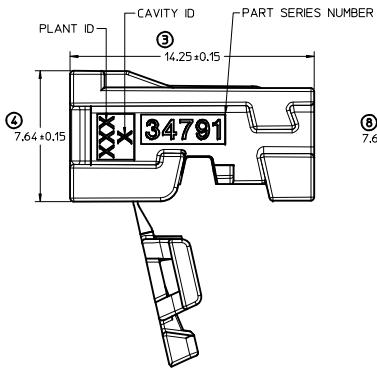

(NON-BRIDGED 8 CKT OPTION SHOWN BELOW)

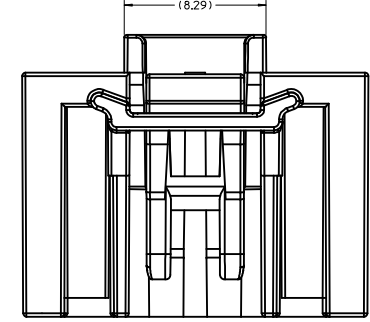
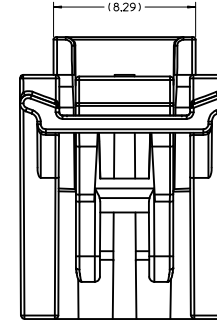
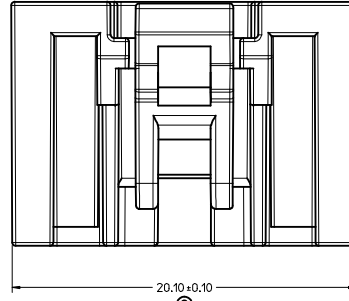
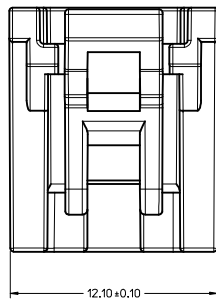
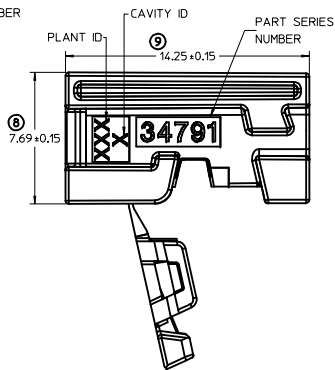

(BRIDGED 4 CKT OPTION SHOWN BELOW)

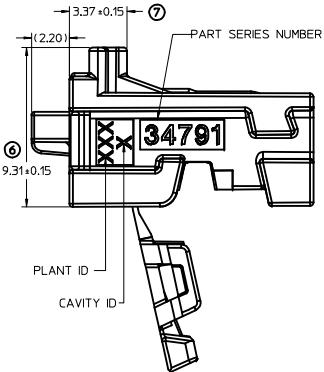

(BRIDGED 8 CKT OPTION SHOWN BELOW)

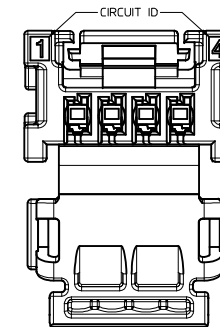
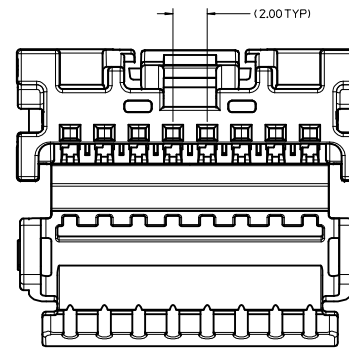
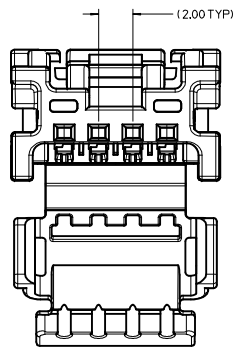
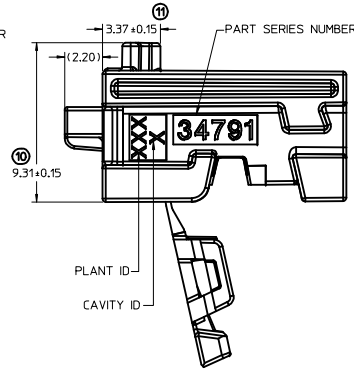

4 CKT RECEPTACLE SHOWN BELOW.
8 CKT RECEPTACLE HAS SIMILAR
CIRCUIT ID LOCATION.

(2 CKT SHOWN BELOW - NO CPA TRAY)

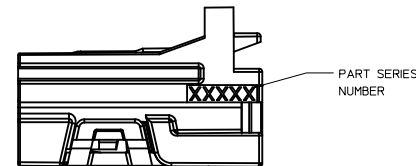
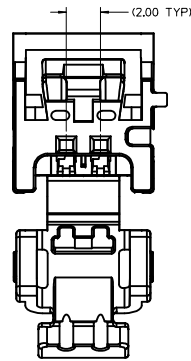
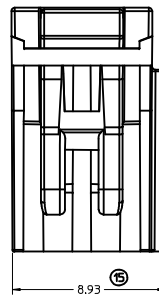
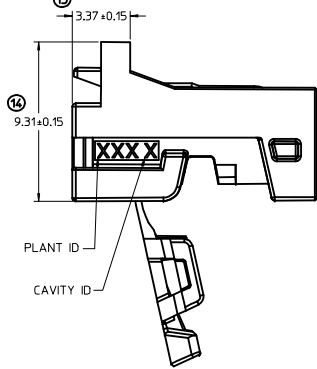

ADDED 2CKT EC NO: UAU2016-0996 DRAWN BY: DRANKHEWITT CHKD: J APPR: RBALMAN DATE: 2015/10/23 REV: 2016/01/04	QUALITY SYMBOLS	GENERAL TOLERANCES (UNLESS SPECIFIED)	DIMENSION STYLE	SCALE	DESIGN UNITS	THIRD ANGLE PROJECTION
	∇=0 ∇=0 ∇=0	mm INCH 4 PLACES ± --- ± --- 3 PLACES ± --- ± --- 2 PLACES ± --- ± --- 1 PLACE ± --- ± --- ANGULAR ± ---°	MM ONLY	7:1	METRIC	☉ □ THIRD ANGLE PROJECTION
	DRAWN BY: JDUNAJ CHECKED BY: BDLCK APPROVED BY: SMARCEAU DATE: 2010/06/24 DATE: 2010/06/24 DATE: 2011/11/21	MATERIAL NO: SEE TABLE	TITLE: MINISO SINGLE ROW RECEPTACLE SALES DRAWING molex	DOCUMENT NO: SD-34791-001	SHEET NO: 3 OF 5	
	DRAFT WHERE APPLICABLE MUST REMAIN WITHIN DIMENSIONS					

19 18 17 16 15 14 13 12 11 10 9 8 7 6 5 4 3 2 1

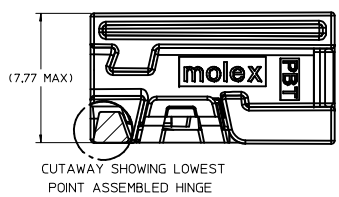
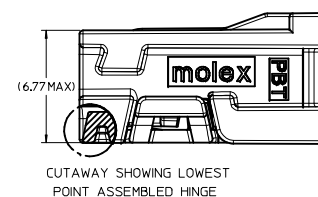
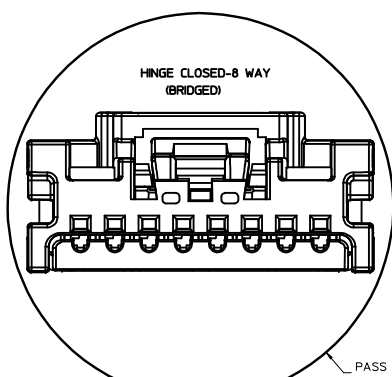
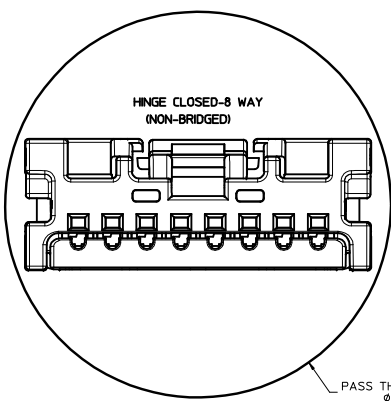
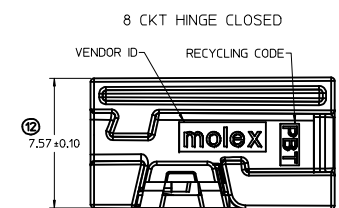
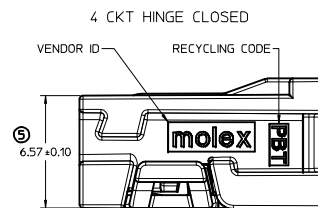
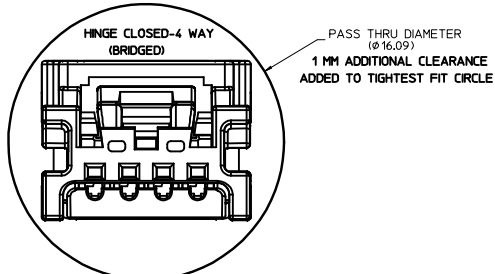
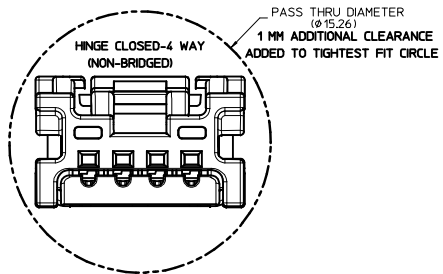
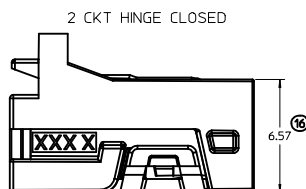
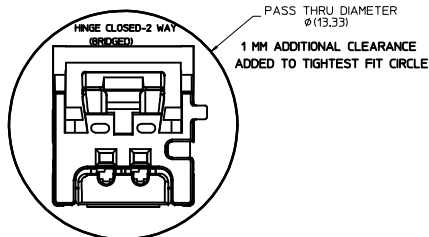

ADDED 2CKT EC NO: UAU2016-0996 DRAWN BY: J CHYK: J APPR: RBALMAN 2015/10/23 2016/01/04	QUALITY SYMBOLS	GENERAL TOLERANCES (UNLESS SPECIFIED)		DIMENSION STYLE		SCALE	DESIGN UNITS	THIRD ANGLE PROJECTION
	▽=0 ▽=0 ▽=0	mm	INCH	MM ONLY		7:1	METRIC	THIRD ANGLE PROJECTION
	4 PLACES +---+---+---+---+ 3 PLACES +---+---+---+---+ 2 PLACES +---+---+---+---+ 1 PLACE +---+---+---+---+ 0 PLACE +---+---+---+---+	ANGULAR ±---+---+---+---+ DRAFT WHERE APPLICABLE MUST REMAIN WITHIN DIMENSIONS		DRAWN BY: JDUNAJ DATE: 2010/06/24 CHECKED BY: BDLCK DATE: 2010/06/24 APPROVED BY: SMARCEAU DATE: 2011/11/21		TITLE: MIN150 SINGLE ROW RECEPTACLE SALES DRAWING molex		DOCUMENT NO.: SD-34791-001 SHEET NO.: 4 OF 5
	SEE TABLE	THIS DRAWING CONTAINS INFORMATION THAT IS PROPRIETARY TO MOLEX INCORPORATED AND SHOULD NOT BE USED WITHOUT WRITTEN PERMISSION						

MINISO RECEPTACLES

MATERIAL NUMBER BULK PACKAGING PK-31301-538	LOCK BRIDGE OPTION	CONFIGURATION	CIRCUIT	POL	COLOR	MATING COMPONENT							
						SURFACE MOUNT TECHNOLOGY (SMT) HEADER-TIN TAPE AND REEL PACKAGING PK-31301-786	TUBE PACKAGING PK-31301-688	SURFACE MOUNT TECHNOLOGY (SMT) HEADER-GOLD TAPE AND REEL PACKAGING PK-31301-786	TUBE PACKAGING PK-31301-688	VERTICAL THRU HOLE HEADER TRAY PACKAGING PK-31301-440	HOLE HEADER TUBE PACKAGING PK-31301-688	RIGHT ANGLE THRU HOLE HEADERS TRAY PACKAGING PK-31301-440	TUBE PACKAGING PK-31301-688
34791-0040	NO	USCAR COMPATIBLE	4	A	BLACK	34912-8040	34912-9040	34912-6040	34912-5040	34792-0040	34792-9040	34793-0040	34793-9040
34791-0041	NO	USCAR COMPATIBLE	4	B	GRAY	34912-8041	34912-9041	34912-6041	34912-5041	34792-0041	34792-9041	34793-0041	34793-9041
34791-0042	NO	USCAR COMPATIBLE	4	C	DARK GRAY	34912-8042	34912-9042	34912-6042	34912-5042	34792-0042	34792-9042	34793-0042	34793-9042
34791-0043	NO	USCAR COMPATIBLE	4	D	GREEN	34912-8043	34912-9043	34912-6043	34912-5043	34792-0043	34792-9043	34793-0043	34793-9043
34791-0080	NO	USCAR COMPATIBLE	8	A	BLACK	34912-8080	34912-9080	34912-6080	34912-5080	34792-0080	34792-9080	34793-0080	34793-9080
34791-0081	NO	USCAR COMPATIBLE	8	B	GRAY	34912-8081	34912-9081	34912-6081	34912-5081	34792-0081	34792-9081	34793-0081	34793-9081
34791-0082	NO	USCAR COMPATIBLE	8	C	DARK GRAY	34912-8082	34912-9082	34912-6082	34912-5082	34792-0082	34792-9082	34793-0082	34793-9082
34791-0140	YES	USCAR COMPATIBLE	4	A	BLACK	34912-8040	34912-9040	34912-6040	34912-5040	34792-0040	34792-9040	34793-0040	34793-9040
34791-0141	YES	USCAR COMPATIBLE	4	B	GRAY	34912-8041	34912-9041	34912-6041	34912-5041	34792-0041	34792-9041	34793-0041	34793-9041
34791-0142	YES	USCAR COMPATIBLE	4	C	DARK GRAY	34912-8042	34912-9042	34912-6042	34912-5042	34792-0042	34792-9042	34793-0042	34793-9042
34791-0143	YES	USCAR COMPATIBLE	4	D	GREEN	34912-8043	34912-9043	34912-6043	34912-5043	34792-0043	34792-9043	34793-0043	34793-9043
34791-0180	YES	USCAR COMPATIBLE	8	A	BLACK	34912-8080	34912-9080	34912-6080	34912-5080	34792-0080	34792-9080	34793-0080	34793-9080
34791-0181	YES	USCAR COMPATIBLE	8	B	GRAY	34912-8081	34912-9081	34912-6081	34912-5081	34792-0081	34792-9081	34793-0081	34793-9081
34791-0182	YES	USCAR COMPATIBLE	8	C	DARK GRAY	34912-8082	34912-9082	34912-6082	34912-5082	34792-0082	34792-9082	34793-0082	34793-9082
34791-0120	YES	MOLEX	2	A	BLACK	34912-8020	34912-9020	34912-6020	34912-5020	N/A	N/A	N/A	N/A
34791-0121	YES	MOLEX	2	B	GRAY	34912-8021	34912-9021	34912-6021	34912-5021	N/A	N/A	N/A	N/A
34791-0122	YES	MOLEX	2	C	DARK GRAY	34912-8022	34912-9022	34912-6022	34912-5022	N/A	N/A	N/A	N/A
34791-0123	YES	MOLEX	2	D	GREEN	34912-8023	34912-9023	34912-6023	34912-5023	N/A	N/A	N/A	N/A

CTX50 UNSEALED RECEPTACLE TERMINALS

PART NUMBER		MATERIAL	WIRE GAGE (mm ²)	GRIP
D-WIND (LEFT PAYOFF)	B-WIND (RIGHT PAYOFF)			
560023-0448	560023-0450	COPPER ALLOY	0.35	LARGE
560023-0421	560023-0423	COPPER ALLOY	0.22	MEDIUM
560023-0422	560023-0424	COPPER ALLOY	0.13	SMALL

ADDED 2CKT EEC NO. UAU2016-0996 J. DRANKHEWITT CHYD. APPR:RBALMAN 2016/01/04 REV	QUALITY SYMBOLS	GENERAL TOLERANCES (UNLESS SPECIFIED)	DIMENSION STYLE	SCALE	DESIGN UNITS	THIRD ANGLE PROJECTION
	▽=0	mm INCH	MM ONLY	5:1	METRIC	
	▽=0	4 PLACES ± --- ± ---	DRAWN BY	DATE	TITLE	
	▽=0	3 PLACES ± --- ± ---	JDUNAJ	2010/06/24	MINISO SINGLE ROW RECEPTACLE SALES DRAWING	
	2 PLACES ± --- ± ---	CHECKED BY	DATE			
	1 PLACE ± --- ± ---	BDICK	2010/06/24			
	0 PLACE ± --- ± ---	APPROVED BY	DATE			
		SMARCEAU	2011/11/21			
	ANGULAR ± ---	MATERIAL NO.	DOCUMENT NO.		SHEET NO.	
	DRAFT WHERE APPLICABLE MUST REMAIN WITHIN DIMENSIONS	SEE TABLE	SD-34791-001		5 OF 5	
		THIS DRAWING CONTAINS INFORMATION THAT IS PROPRIETARY TO MOLEX INCORPORATED AND SHOULD NOT BE USED WITHOUT WRITTEN PERMISSION				