

THIS DRAWING IS UNPUBLISHED. RELEASED FOR PUBLICATION ,19 .
 © COPYRIGHT 19 BY AMP INCORPORATED. ALL RIGHTS RESERVED.

LOC	DIST	REVISIONS			
P	LTR	DESCRIPTION	DATE	DWN	APVD
G	14	H	REDRAWN PER 0720-0540-95	05SEP95	LO ME

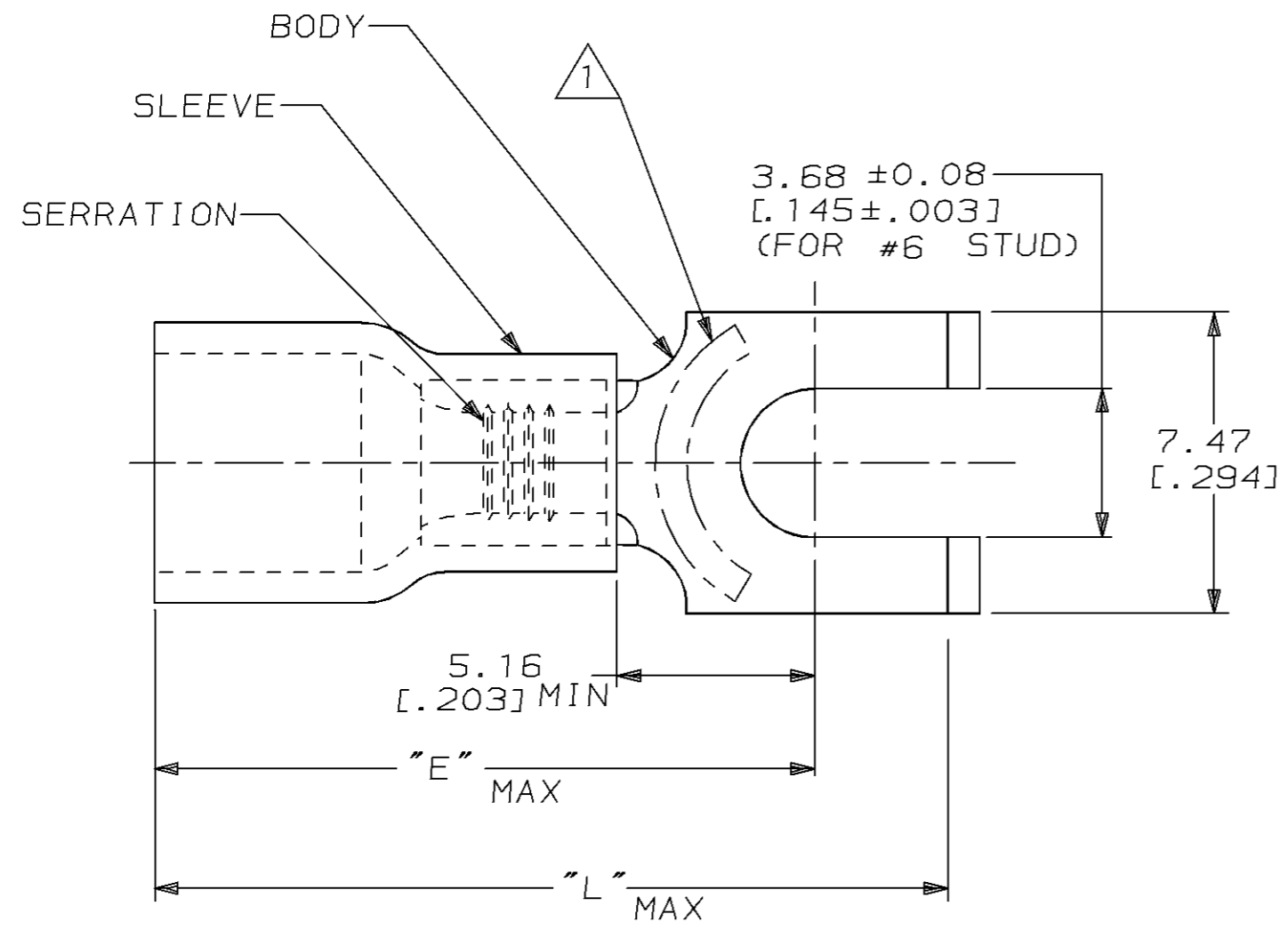

AMP WIRE RANGE	UL E13288	SP LR7189 Certified
16-14 AWG SOLID OR STRANDED	16-14 AWG SOLID OR STRANDED	16-14 AWG SOLID OR STRANDED

- ① STAMP AMP 16-14* APPROX AS SHOWN
- 2. SEE TABLE FOR WIRE INSUL DIA
- 3. TONGUE MATL THK, 0.79±0.05 [.031±.002]

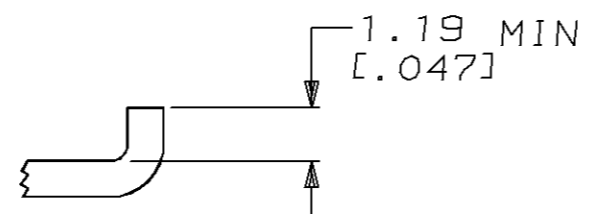

15.72 [.619]	19.02 [.749]	2.92-4.32 [.115-.170]	100	LOOSE PIECE, BOX	8-324165-1
16.97 [.668]	20.27 [.798]	3.81-6.35 [.150-.250]	2500	ON TAPE, REEL	2-324165-4
15.72 [.619]	19.02 [.749]	2.92-4.32 [.115-.170]	5000	ON TAPE, REEL	2-324165-1
15.72 [.619]	19.02 [.749]	2.92-4.32 [.115-.170]	1000	LOOSE PIECE	324165
"E"	"L"	WIRE INSUL DIA	QTY	PACKAGE TYPE	PART NO

AMP INCORPORATED CUSTOMER SERVICE SYSTEM	
FOR ADDITIONAL PRODUCT INFORMATION OR COPIES OF DRAWINGS AND TECHNICAL DOCUMENTS	PRODUCT INFORMATION CENTER 1-800-522-6752
FOR APPLICATION TOOLING INFORMATION	TOOLING ASSISTANCE CENTER 1-800-722-1111
FOR ORDER ENTRY	1-800-526-5142

MAX RECOMMENDED OPERATING TEMPERATURE: 90°C [194°F]
VOLTAGE RATING: 600V MAX (1000V FIXTURE OR SIGN)
CIRCULAR MIL AREA: 1.04mm² - 2.62mm² (2,050-5,180)

<small>THIS DRAWING IS A CONTROLLED DOCUMENT FOR AMP INCORPORATED. IT IS SUBJECT TO CHANGE AND THE CONTROLLING ENGINEERING ORGANIZATION SHOULD BE CONTACTED FOR THE LATEST REVISION.</small>	
DIMENSIONS: mm [in]	TOLERANCES UNLESS OTHERWISE SPECIFIED:
	0 PLC ±-
	1 PLC ±-
	2 PLC ±0.20 [.008]
	3 PLC ±-
	4 PLC ±-
	ANGLES ±-
MATERIAL BODY, CU PER ASTM B152 SLEEVE, PVC, COLOR, BLUE	FINISH TIN PLATE PER MIL-T-10727

DWN L OLMEDA	05SEP95
CHK M ELLIS	05SEP95
APVD G NGO	05SEP95
PRODUCT SPEC UL 486A	
APPLICATION SPEC	
WEIGHT	-
CUSTOMER DRAWING	

AMP AMP Incorporated Harrisburg, PA 17105-3608		
NAME TERMINAL, SPADE, FLANGED, PLASTI-GRIP, WIRE SIZE, 16-14 AWG		
SIZE A3	CAGE CODE 00779	DRAWING NO C-324165
SCALE 6:1	SHEET 1 OF 1	REV H