

IEC Appliance Connector C14 with Fuseholder 2-pole to Felcom

Plug removal necessary for fuse replacement



Appliance inlet with fuseholder

C14



70 ° C



Description

- Component:
Snap-In Version from front side
- 2 Functions:
Inlet Protection class I, Fuseholder for fuse-links 5 x 20 mm 1- or 2-pole
- For PCB mounting Used in Felcom

Characteristics

- Individual components soldered on a printed circuit board
- Plug removal necessary for fuse-link replacement
Fuse drawer meets requirements of medical standard IEC/EN 60601-1
- The fuseholder is accessible from the equipment front
- Qualified for use in equipment according IEC/EN 60950

Weblinks

Approvals: <http://www.schurter.com/approvals>RoHS: <http://www.schurter.com/rohs>

Technical Data

Ratings IEC	10 A / 250 VAC; 50 Hz
Ratings UL/CSA	10 A / 250 VAC; 60 Hz
Allowable Operation Temp.	-25 °C to 70 °C
Degree of Protection	from front side IP 40 acc. to IEC 60529
Protection Class	Suitable for appliances with protection class I acc. to IEC 61140
Terminal	For PCB mounting
Panel Thickness s	Snap-in: 1/1.2/1.5/2/2.5/3 mm
Material: Housing	Thermoplastic, black, UL 94V-0

Appliance-Inlet /-Outlet	C14 acc. to IEC/EN 60320-1, UL 498, CSA C22.2 no. 42 (for cold condition) pin-temperature 70 °C, 10 A, Protection class I
Fuseholder	1 or 2 pole, Shocksafe category PC2 acc. to IEC 60127-6, for fuse-links 5 x 20 mm
Rated Power Acceptance @ Ta 23 °C	5 x 20: 2 W (1 pole)/ 1.6 W (2-pole) per pole
Power Acceptance @ Ta > 23 °C	Admissible power acceptance at higher ambient temperature see derating curves

Dimensions

Appliance inlet with fuseholder

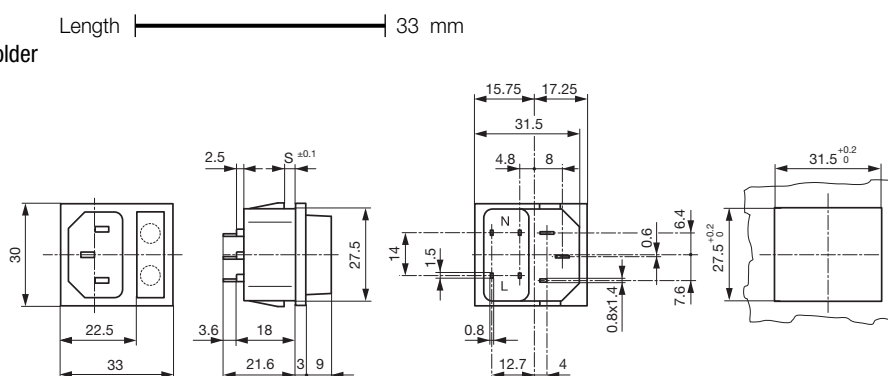

Variants

Type	Panel Thickness s [mm]	Line Switch	Fuseholder	Appliance-inlet	Appliance outlet	Order Number
Fuseholder	1	-	1 pole	C14	-	6250.5510
Fuseholder	1	-	2-pole	C14	-	6255.5510
Fuseholder	1.2	-	1 pole	C14	-	6250.5512
Fuseholder	1.2	-	2-pole	C14	-	6255.5512
Fuseholder	1.5	-	1 pole	C14	-	6250.5515
Fuseholder	1.5	-	2-pole	C14	-	6255.5515
Fuseholder	2	-	1 pole	C14	-	6250.5520
Fuseholder	2	-	2-pole	C14	-	6255.5520
Fuseholder	2.5	-	1 pole	C14	-	6250.5525
Fuseholder	2.5	-	2-pole	C14	-	6255.5525
Fuseholder	3	-	1 pole	C14	-	6250.5530
Fuseholder	3	-	2-pole	C14	-	6255.5530

Packaging unit 50 Pcs