

NOTE:

- 1.) ALL DIMENSIONS APPLY BEFORE PLATING
- 2.) THDS SHALL BE TO GAUGE FIT AFTER PLATING OR OTHER FINISH
- 3.) SURFACE SHALL BE SMOOTH, AND FREE OF TOOL MARKS
- 4.) BREAK ALL SHARP CORNERS AND REMOVE BURRS

REVISIONS			
SYM	DESCRIPTION	REVISED BY	DATE

FULL SECTION

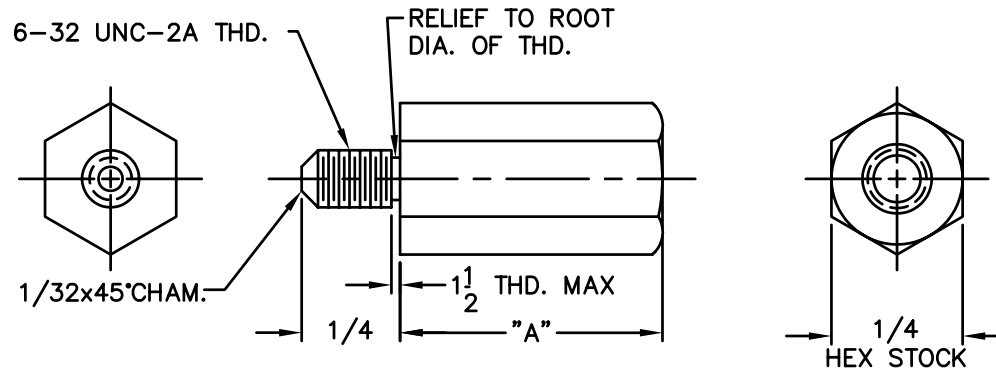
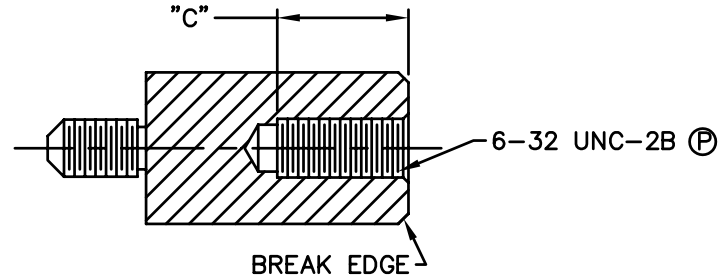

STANDOFF		
PART NO.	LENGTH	C
8255	1.125	.375
8256	1.250	.375
8257	1.375	.375
8258	1.500	.375
8259	1.625	.375
8260	1.750	.375
8261	2.000	.375
8262	2.500	.375
8263	3.000	.375

MATERIAL: BRASS 360 1/2 HARD		FINISH: NICKEL CODE 10		<h1>ABBATRON</h1> <p>Electronic Connectors and Hardware 632 Arch Street, Meadville, Pa. 16335</p>			
DIMENSIONAL TOLERANCES UNLESS OTHERWISE SPECIFIED			TITLE: 8255-8263				
.XX	.XXX	.XXX	BRASS HEX MALE/FEMALE STANDOFF				
---	---	---	DRAWN: T. LORD DATE: 01/08/03				
FRACTIONS		ANGLES	SCALE	CHECKED: T. LORD DATE: 01/08/03			
---		---	4X	APPROVED: T. LORD DATE: 01/08/03			
HEAT TREAT: ---		PLOT SCALE: 1=1		SIZE: B	DRAWING NUMBER: SD: 8255-8263		
				ISSUE: P			