

ESDBL7951HP

Transient Voltage Suppressors

for ESD Protection

Features

- Low Clamping Voltage
- Low Leakage
- Bi-direction high reliability

PINNING

PIN	DESCRIPTION
1	Anode
2	Anode

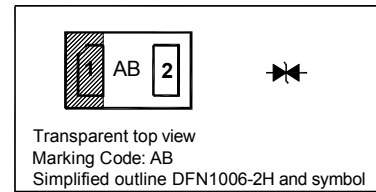

Absolute Maximum Ratings ($T_a = 25^\circ\text{C}$)

Parameter	Symbol	Value	Unit
IEC61000-4-2 (ESD) Air Contact	V_{ESD}	± 15 ± 8	KV
Total Power Dissipation on FR-5 Board ¹⁾	P_D	150	mW
Junction Temperature Range	T_j	- 55 to + 125	$^\circ\text{C}$
Storage Temperature Range	T_{stg}	- 55 to + 150	$^\circ\text{C}$

¹⁾FR-5 = 1.0 x 0.75 x 0.62 in

Characteristics at $T_a = 25^\circ\text{C}$

Type	Reverse Stand-off Voltage	Reverse Current	Reverse Breakdown Voltage		Clamping Voltage	Reverse Peak Pulse Current	Capacitance		
	V_{RWM}	I_R at V_{RWM}	V_{BR}	at I_T	V_C at Max. I_{PP}	I_{PP}	C_j	at f	at V_R
	Max. (V)	Max. (μA)	Min. (V)	(mA)	Max. (V)	Max. (A)	Max. (pF)	(MHz)	(V)
ESDBL7951HP	5	1	5.4	1	12.9	1	0.9	1	0

TOP DYNAMIC



Dated: 19/05/2015 Rev: 02

ESDBL7951HP

PACKAGE OUTLINE

Plastic surface mounted package

DFN1006-2H

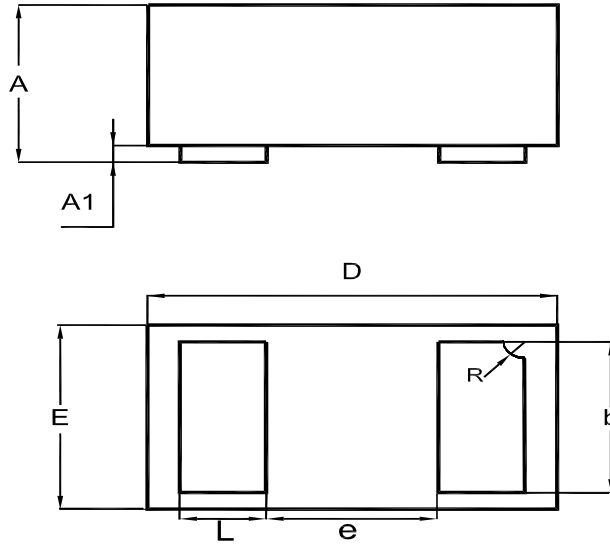

UNIT	A	A1	b	D	E	e	L	R
mm	0.51	0.05	0.55	1.05	0.65	0.4	0.3	0.15
	0.46	0	0.45	0.95	0.55		0.2	0.05

Recommended Soldering Footprint

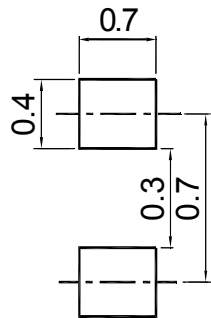

Packing information

Package	Tape Width (mm)	Pitch		Reel Size		Per Reel Packing Quantity
		mm	inch	mm	inch	
DFN1006-2H	8	4 ± 0.1	0.157 ± 0.004	178	7	5,000

TOP DYNAMIC



Dated: 19/05/2015 Rev: 02