

RB520-40HP

SILICON EPITAXIAL SCHOTTKY BARRIER DIODE

Features

- Low Reverse Current
- Ultra-small surface mount package
- High reliability

PINNING

PIN	DESCRIPTION
1	Cathode
2	Anode

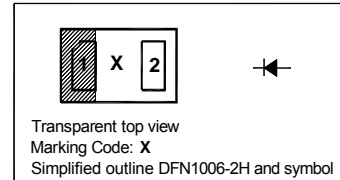

Absolute Maximum Ratings ($T_a = 25^\circ\text{C}$)

Parameter	Symbol	Value	Unit
Peak Reverse Voltage	V_{RM}	40	V
Reverse Voltage	V_R	40	V
Average Rectified Forward Current	$I_{F(AV)}$	200	mA
Non-Repetitive Peak Forward Current $t = 8.3 \text{ ms}$	I_{FSM}	1	A
Junction Temperature	T_j	150	$^\circ\text{C}$
Operating and Storage Temperature Range	T_{stg}	- 40 to + 150	$^\circ\text{C}$

Characteristics at $T_a = 25^\circ\text{C}$

Parameter	Symbol	Max.	Unit
Forward Voltage at $I_F = 200 \text{ mA}$	V_F	0.55	V
Peak Reverse Current at $V_R = 10 \text{ V}$	I_R	10	μA

TOP DYNAMIC



Dated: 18/06/2016 Rev: 01

RB520-40HP

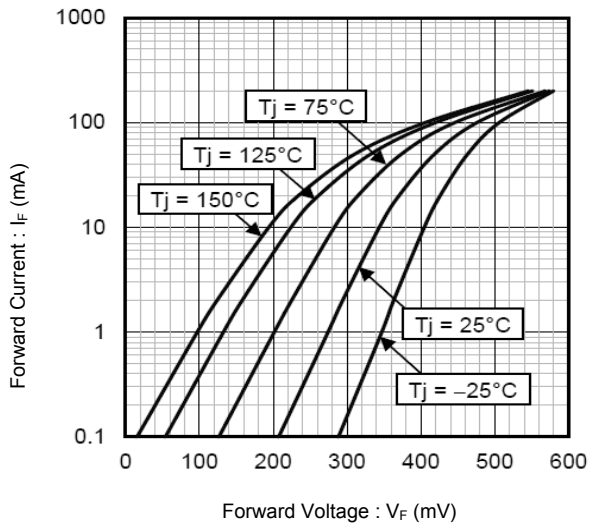
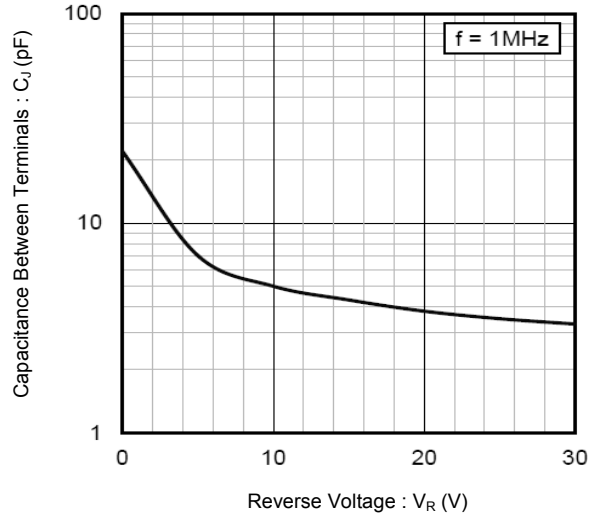
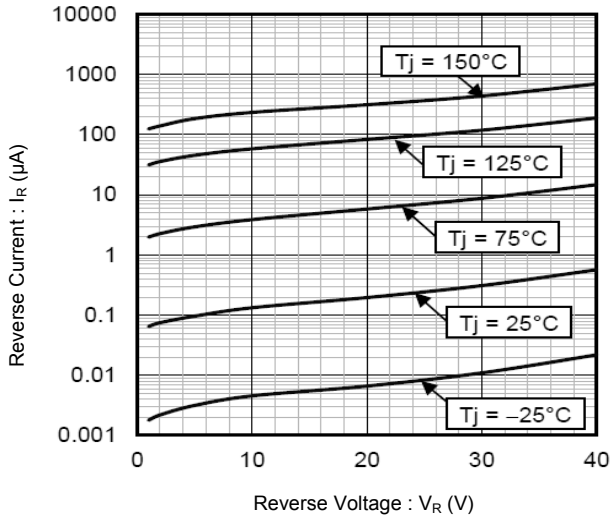

TOP DYNAMIC



ISO14001 : 2004 Certificate No. 121505007 ISO 9001 : 2008 Certificate No. 50114012 OHSAS 18001 : 2007 Certificate No. 0513150008 IECQ QC 080000 Certificate No. EC34100014102

Dated: 18/06/2016 Rev: 01

RB520-40HP

PACKAGE OUTLINE

Plastic surface mounted package

DFN1006-2H

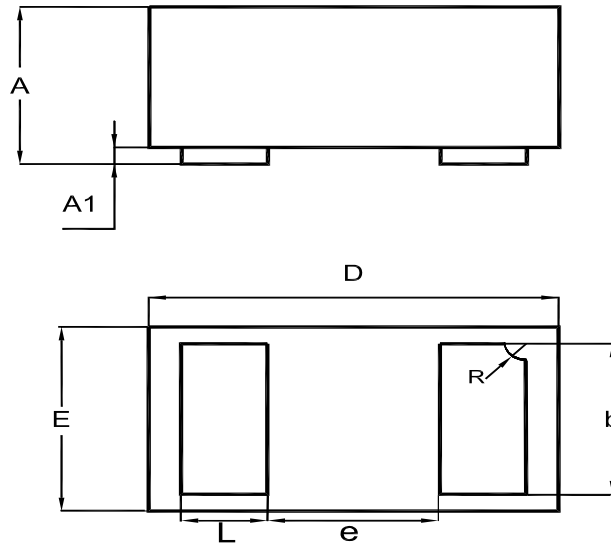

UNIT	A	A1	b	D	E	e	L	R
mm	0.51	0.05	0.55	1.05	0.65	0.4	0.3	0.15
	0.46	0	0.45	0.95	0.55		0.2	0.05

Recommended Soldering Footprint

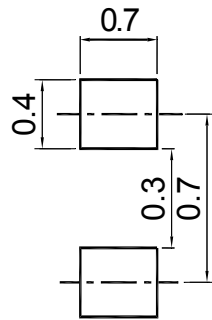

Packing information

Package	Tape Width (mm)	Pitch		Reel Size		Per Reel Packing Quantity
		mm	inch	mm	inch	
DFN1006-2H	8	4 ± 0.1	0.157 ± 0.004	178	7	5,000

TOP DYNAMIC



Dated: 18/06/2016 Rev: 01