

# S3AC THRU S3MC

## Surface Mount General Rectifiers

Reverse Voltage - 50 to 1000 V

Forward Current - 3 A

### Features

- The plastic package carries UL flammability classification 94 V-0
- High forward surge current capability
- Low reverse current

### Mechanical Data

- Case: SMC (DO-214AB) molded plastic body
- Terminals: Solder plated, solderable per MIL-STD-750, method
- Polarity: color band denotes cathode end

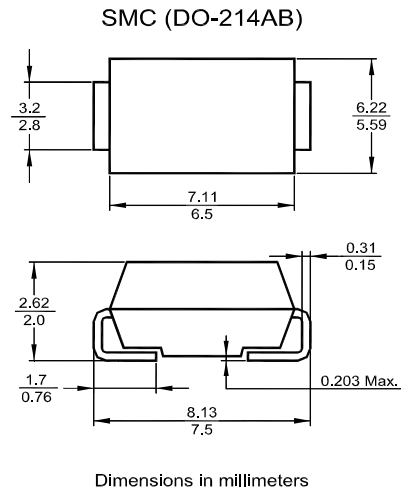

### Maximum Ratings and Characteristics

Ratings at 25 °C ambient temperature unless otherwise specified. Single phase, half wave, 60 Hz, resistive or inductive load. For capacitive load, derate current by 20%.

Parameter	Symbols	S3AC	S3BC	S3DC	S3GC	S3JC	S3KC	S3MC	Units
Maximum Repetitive Peak Reverse Voltage	$V_{RRM}$	50	100	200	400	600	800	1000	V
Maximum RMS Voltage	$V_{RMS}$	35	70	140	280	420	560	700	V
Maximum DC Blocking Voltage	$V_{DC}$	50	100	200	400	600	800	1000	V
Maximum Average Forward Current at $T_L = 75\text{ }^\circ\text{C}$	$I_{F(AV)}$	3							A
Peak Forward Surge Current 8.3 ms Single Half Sine-wave Superimposed on Rated Load (JEDEC method)	$I_{FSM}$	100							A
Maximum Forward Voltage at $I_F = 3\text{ A}$	$V_F$	1.15							V
Maximum DC Reverse Current at $T_A = 25\text{ }^\circ\text{C}$ at Rated DC Blocking Voltage at $T_A = 125\text{ }^\circ\text{C}$	$I_R$	10 250							$\mu\text{A}$
Typical Junction Capacitance <sup>1)</sup>	$C_J$	60							pF
Typical Thermal Resistance <sup>2)</sup>	$R_{\theta JA}$	53							$^\circ\text{C/W}$
Typical Thermal Resistance <sup>2)</sup>	$R_{\theta JL}$	16							$^\circ\text{C/W}$
Operating and Storage Temperature Range	$T_j, T_{stg}$	- 55 to + 150							$^\circ\text{C}$

<sup>1)</sup> Measured at 1 MHz and applied reverse voltage of 4 V.

<sup>2)</sup> P.C.B mounted with 0.27" X 0.27" (7 X 7 mm) copper pad areas

**TOP DYNAMIC**

# S3AC THRU S3MC

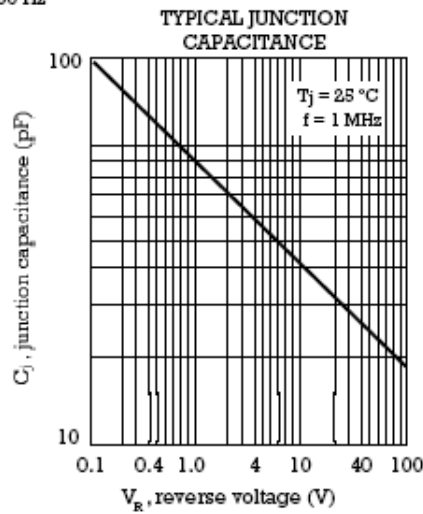
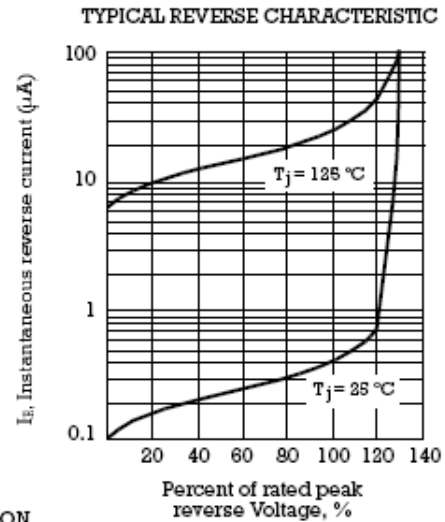
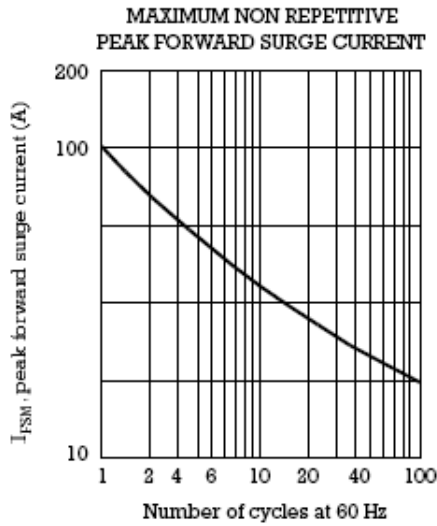
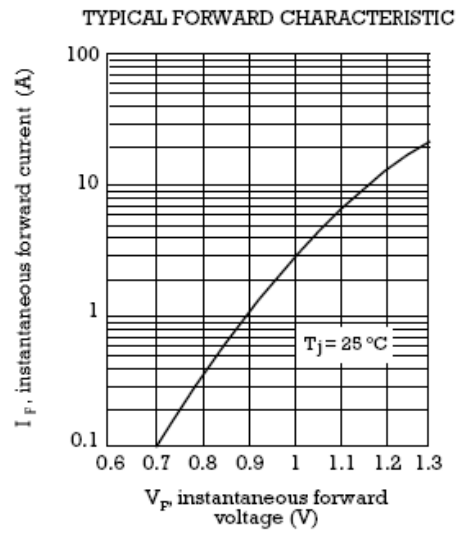
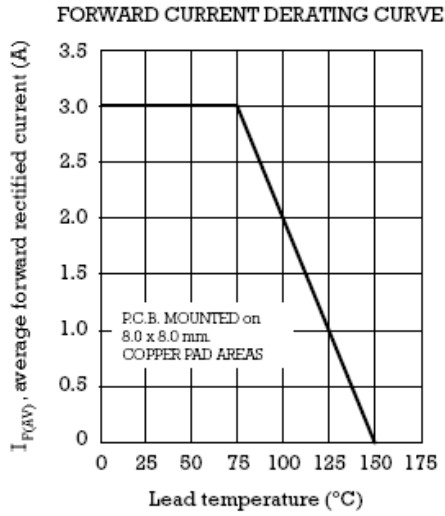

**TOP DYNAMIC**