

Dual Low Drop Out Regulator  
Ceramic Capacitor Available  
**BA3258FP/HFP**

● Description

● Dimension (Unit : mm)

**BA3258FP**

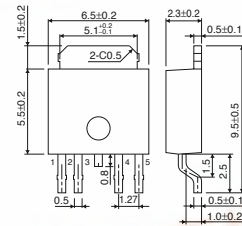

**TO252-5**

● Features

- 1) 3.3V/1A and 1.5V/1A
- 2) Output ceramic capacitor available
- 3) Output voltage accuracy : +/-2%
- 4) Built-in over-current and thermal protection circuit
- 5) TO252-5 package and HRP-5 package

**BA3258HFP**

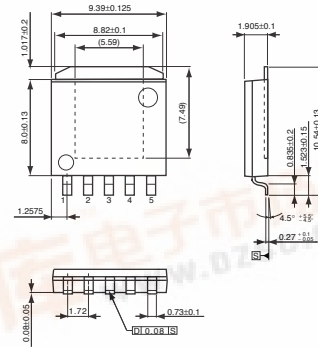

**HRP-5**

● Applications

HDD/DVD

● Absolute Maximum Ratings (Ta=25°C)

Parameter	Symbol	Limits	Unit
Power supply voltage	V <sub>CC</sub>	15	V
Power dissipation	HRP-5	2300	mW
	TO252-5	1300	
Operating temperature range	T <sub>opr</sub>	0 ~ +85	°C
Storage temperature range	T <sub>stg</sub>	-55 ~ +150	°C

\*1 Derating : 18.4mW/°C for operation above Ta=25°C PCB (70mmx70mm, t=1.6mm) glass epoxy mounting.  
\*2 Derating : 10.4mW/°C for operation above Ta=25°C PCB (70mmx70mm, t=1.6mm) glass epoxy mounting.

● Recommended Operating Conditions (Ta=25°C)

Parameter	Symbol	Min.	Typ.	Max.	Unit
Power supply voltage	V <sub>CC</sub>	4.75	-	14.0	V



● Electrical characteristics (Unless otherwise noted;  $T_a=25^\circ\text{C}$ ,  $V_{cc}=5\text{V}$ )

Parameter	Symbol	Min.	Typ.	Max.	Unit	Conditions
Circuit current	$I_b$	-	3□	5□	mA	$I_{o1}=0\text{mA}$ , $I_{o2}=0\text{mA}$
Line regulation 1,2	$\Delta V_{LINE1,2}$	-	5□	15□	mV	$V_{cc}=4.75 \rightarrow 14\text{V}$ , $I_o=5\text{mA}$
Load regulation 1,2	$\Delta V_{LOAD1,2}$	-	5□	20□	mV	$I_o=5\text{mA} \rightarrow 1\text{A}$
[3.3V output]						
Output voltage	$V_{o1}$	3.234	3.300□	3.366□	V	$I_{o1}=50\text{mA}$
Dropout voltage	$\Delta V_{D1}$	-	1.1□	1.3□	V	$I_{o1}=1\text{A}$
Output current	$I_{o1}$	1.0	-	-	A	
[1.5V output]						
Output voltage	$V_{o2}$	1.470	1.500□	1.530□	V	$I_{o2}=50\text{mA}$
Output current	$I_{o2}$	1.0	-	-	A	

● Application Circuit

