

Coaxial DC Block

BLK-18

0.01 to 18 GHz

Maximum Ratings

| | |
|-----------------------|----------------|
| Operating Temperature | -55°C to 100°C |
| Storage Temperature | -55°C to 100°C |
| Max. DC input voltage | 50V |

Features

- broadband performance
- low insertion loss
- rugged unibody construction
- off-the-shelf availability



CASE STYLE: FF888
CONNECTOR: SMA (F) - SMA (M)
PRICE: \$21.95 ea.
QTY. (1-9)

Applications

- test and measurement instrumentation
- communication systems
- defense systems

Outline Drawing

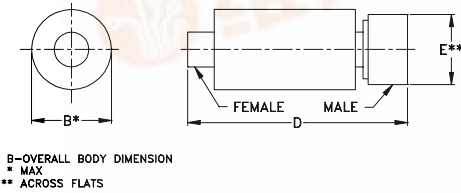

Electrical Specifications at 25°C

| FREQUENCY (GHz) | INSERTION LOSS (dB) | | RETURN LOSS (dB) | |
|-----------------|---------------------|------|------------------|------|
| | Typ. | Max. | Typ. | Min. |
| 0.01-0.1 | 0.02 | 0.2 | 26 | 20 |
| 0.1-1.0 | 0.07 | 0.3 | 36 | 20 |
| 1.0-4.0 | 0.15 | 0.5 | 24 | 20 |
| 4.0-8.0 | 0.38 | 1.0 | 18 | 15 |
| 8.0-18 | 1.00 | — | 12 | — |

Outline Dimensions (inch/mm)

| B | D | E | wt. |
|-------|-------|------|-------|
| .46 | 1.18 | .31 | grams |
| 11.68 | 29.97 | 7.87 | 7.0 |

Typical Performance Data

| FREQUENCY (MHz) | INSERTION LOSS (dB) | RETURN LOSS (dB) | |
|-----------------|---------------------|------------------|--------|
| | | MALE | FEMALE |
| 10.00 | 0.05 | 28.49 | 28.48 |
| 50.00 | 0.03 | 45.13 | 45.06 |
| 100.00 | 0.03 | 50.04 | 50.34 |
| 300.00 | 0.05 | 39.11 | 39.36 |
| 500.00 | 0.07 | 35.50 | 35.89 |
| 700.00 | 0.11 | 34.05 | 34.48 |
| 900.00 | 0.10 | 32.59 | 33.09 |
| 1000.00 | 0.10 | 31.87 | 32.59 |
| 2000.00 | 0.10 | 28.84 | 28.45 |
| 3000.00 | 0.12 | 26.71 | 25.78 |
| 4000.00 | 0.20 | 24.84 | 24.46 |
| 5000.00 | 0.28 | 22.08 | 23.35 |
| 6000.00 | 0.35 | 19.95 | 21.73 |
| 7000.00 | 0.41 | 20.10 | 20.67 |
| 8000.00 | 0.47 | 17.98 | 18.83 |
| 10000.00 | 0.64 | 15.04 | 15.60 |
| 12000.00 | 0.80 | 14.59 | 12.85 |
| 14000.00 | 0.99 | 12.82 | 12.36 |
| 16000.00 | 1.08 | 13.07 | 12.06 |
| 18000.00 | 1.03 | 16.78 | 12.60 |

