



# FRD Type : EA21FC4-F

## OUTLINE DRAWING

### FEATURES

- \* TO-252AA Case, Surface Mounting Device
- \* Packaged in 16mm Tape and Reel
- \* Ultra – Fast Recovery
- \* Low Forward Voltage drop
- \* Low Power Loss
- \* High Surge Capability
- \* 200 Volts thru 400 Volts Types Available

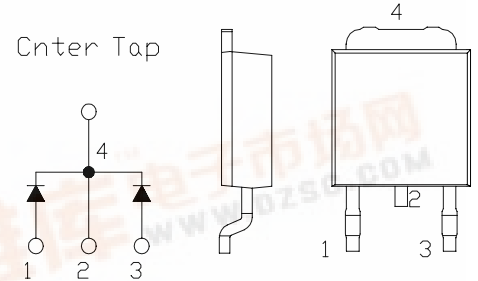

### Maximum Ratings

Approx Net Weight:0.30g

Rating		Symbol	EA21FC4-F			Unit
Repetitive Peak Reverse Voltage		V <sub>RRM</sub>	400			V
Non-repetitiv Peak Reverse Voltage		V <sub>RSM</sub>	440			
Average Rectified Output Current	P.C.Board mounted *	I <sub>O</sub>	1.5	Ta=25°C	50Hz Full Sine Wave Resistive Load	A
	-		2.0	Tc=135°C		
RMS Forward Current		I <sub>F(RMS)</sub>	2.22			A
Surge Forward Current		I <sub>FSM</sub>	30	50Hz Full Sine Wave,1cycle, Non-repetitive		A
Operating JunctionTemperature Range		T <sub>jw</sub>	- 40 to + 150			°C
Storage Temperature Range		T <sub>stg</sub>	- 40 to + 150			°C

### Electrical • Thermal Characteristics

Characteristics		Symbol	Conditions	Min	Typ	Max	Unit
Peak Reverse Current		$I_{RM}$	$T_j=25^{\circ}C, V_{RM}=V_{RRM}$ per Arm	-	-	20	$\mu A$
Peak Forward Voltage		$V_{FM}$	$T_j=25^{\circ}C, I_{FM}= 1 A$ per Arm	-	-	1.25	V
Reverse Recovery Time		$t_{rr}$	$I_{FM}= 1 A,$ $-di/dt= 50 A/\mu s, T_a= 25^{\circ}C$	-	-	30	ns
Thermal Resistance	Junction to Ambient	$R_{th(j-a)}$	P.C.Board mounted *	-	-	80	$^{\circ}C/W$
	Junction to Case	$R_{th(j-c)}$	-	-	-	6	$^{\circ}C/W$

\* Print Land = 20x20 mm



EA21FC4-F OUTLINE DRAWING (Dimensions in mm)

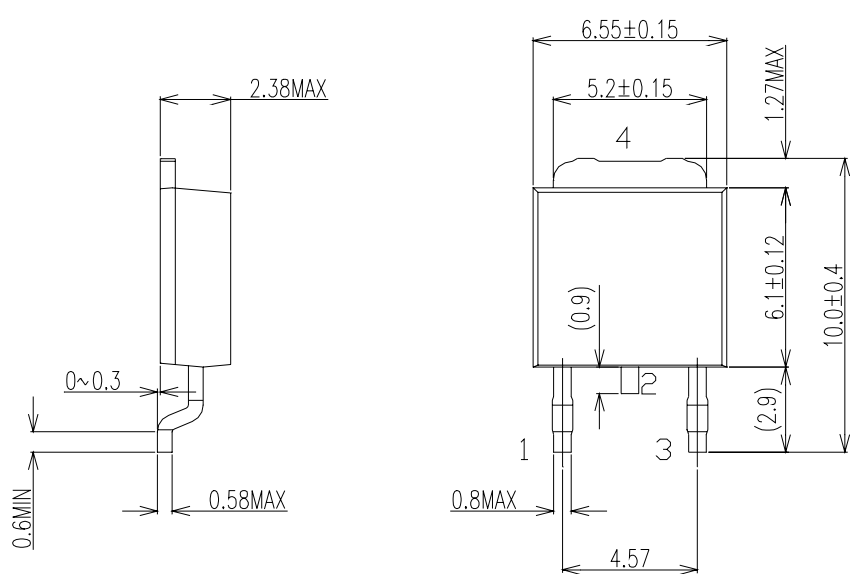

SOLDERING PAD

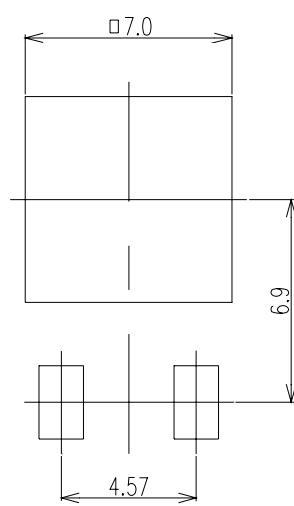

Center Tap

