



GENERAL DESCRIPTION

This high voltage MOSFET uses an advanced termination scheme to provide enhanced voltage-blocking capability without degrading performance over time. In addition, this advanced MOSFET is designed to withstand high energy in avalanche and commutation modes. The new energy efficient design also offers a drain-to-source diode with a fast recovery time. Designed for high voltage, high speed switching applications in power supplies, converters and PWM motor controls, these devices are particularly well suited for bridge circuits where diode speed and commutating safe operating areas are critical and offer additional and safety margin against unexpected voltage transients.

FEATURES

- ◆ Robust High Voltage Termination
- ◆ Avalanche Energy Specified
- ◆ Source-to-Drain Diode Recovery Time Comparable to a Discrete Fast Recovery Diode
- ◆ Diode is Characterized for Use in Bridge Circuits
- ◆ I_{BSS} and $V_{DS(on)}$ Specified at Elevated Temperature

PIN CONFIGURATION

TO-220/TO-220FP
Front View

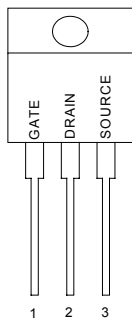

TO-252
Front View

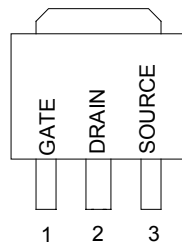

TO-251
Front View

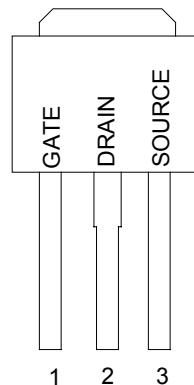

SYMBOL

N-Channel MOSFET

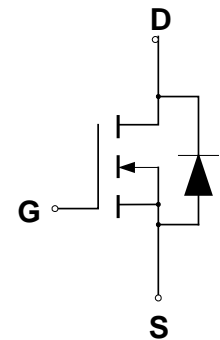

ABSOLUTE MAXIMUM RATINGS

| Rating | Symbol | Value | Unit |
|-------------------------------------------------------------------------------------------------------------------------------------------------------------------------------|----------------|------------|------|
| Drain to Current – Continuous | I_D | 2.0 | A |
| – Pulsed | I_{DM} | 9.0 | |
| Gate-to-Source Voltage – Continue | V_{GS} | ± 20 | V |
| – Non-repetitive | V_{GSM} | ± 40 | V |
| Total Power Dissipation | P_D | 50 | W |
| Derate above 25°C | | 0.4 | W/°C |
| Operating and Storage Temperature Range | T_J, T_{STG} | -55 to 150 | °C |
| Single Pulse Drain-to-Source Avalanche Energy – $T_J = 25^\circ\text{C}$ ($V_{DD} = 100\text{V}, V_{GS} = 10\text{V}, I_L = 2\text{A}, L = 10\text{mH}, R_G = 25\Omega$) | E_{AS} | 20 | mJ |
| Thermal Resistance – Junction to Case | θ_{JC} | 1.0 | °C/W |
| – Junction to Ambient | θ_{JA} | 62.5 | |
| Maximum Lead Temperature for Soldering Purposes, 1/8" from case for 10 seconds | T_L | 260 | °C |

ORDERING INFORMATION

| Part Number | Package |
|------------------|---------------------|
| CMT02N60N251 | TO-251 |
| CMT02N60N252 | TO-252 |
| CMT02N60N220 | TO-220 |
| CMT02N60N220FP | TO-220 Full Package |
| CMT02N60GN251* | TO-251 |
| CMT02N60GN252* | TO-252 |
| CMT02N60GN220* | TO-220 |
| CMT02N60GN220FP* | TO-220 Full Package |

*Note: G : Suffix for Pb Free Product

ELECTRICAL CHARACTERISTICS

Unless otherwise specified, $T_J = 25^\circ\text{C}$.

| Characteristic | Symbol | CMT02N60 | | | Units | |
|------------------------------------------------------------------------------------------------------------------------------------------------------------------------|-------------------------------------------------------------------------------------------------------|--------------|-----|-------------|----------|----|
| | | Min | Typ | Max | | |
| Drain-Source Breakdown Voltage ($V_{GS} = 0\text{ V}$, $I_D = 250\ \mu\text{A}$) | $V_{(BR)DSS}$ | 600 | | | V | |
| Drain-Source Leakage Current ($V_{DS} = 600\text{ V}$, $V_{GS} = 0\text{ V}$) ($V_{DS} = 480\text{ V}$, $V_{GS} = 0\text{ V}$, $T_J = 125^\circ\text{C}$) | I_{DSS} | | | 0.25 1.0 | mA | |
| Gate-Source Leakage Current-Forward ($V_{gsf} = 20\text{ V}$, $V_{DS} = 0\text{ V}$) | I_{GSSF} | | | 100 | nA | |
| Gate-Source Leakage Current-Reverse ($V_{gsr} = 20\text{ V}$, $V_{DS} = 0\text{ V}$) | I_{GSSR} | | | 100 | nA | |
| Gate Threshold Voltage ($V_{DS} = V_{GS}$, $I_D = 250\ \mu\text{A}$) | $V_{GS(th)}$ | 2.0 | 3.1 | 4.0 | V | |
| Static Drain-Source On-Resistance ($V_{GS} = 10\text{ V}$, $I_D = 1.0\text{ A}$) * | $R_{DS(on)}$ | | 3.3 | 4.4 | Ω | |
| Drain-Source On-Voltage ($V_{GS} = 10\text{ V}$) ($I_D = 2.0\text{ A}$) | $V_{DS(on)}$ | | | 8.8 | V | |
| Forward Transconductance ($V_{DS} \geq 50\text{ V}$, $I_D = 1.0\text{ A}$) * | g_{FS} | 1.0 | | | mhos | |
| Input Capacitance | $(V_{DS} = 25\text{ V}$, $V_{GS} = 0\text{ V}$, $f = 1.0\text{ MHz}$) | C_{iss} | 435 | | pF | |
| Output Capacitance | | C_{oss} | 56 | | pF | |
| Reverse Transfer Capacitance | | C_{rss} | 9.2 | | pF | |
| Turn-On Delay Time | $(V_{DD} = 300\text{ V}$, $I_D = 2.0\text{ A}$, $V_{GS} = 10\text{ V}$, $R_G = 18\Omega$) * | $t_{d(on)}$ | 12 | | ns | |
| Rise Time | | t_r | 21 | | ns | |
| Turn-Off Delay Time | | $t_{d(off)}$ | 30 | | ns | |
| Fall Time | | t_f | 24 | | ns | |
| Total Gate Charge | $(V_{DS} = 400\text{ V}$, $I_D = 2.0\text{ A}$, $V_{GS} = 10\text{ V}$) * | Q_g | 13 | 22 | nC | |
| Gate-Source Charge | | Q_{gs} | 2.0 | | nC | |
| Gate-Drain Charge | | Q_{gd} | 6.0 | | nC | |
| Internal Drain Inductance (Measured from the drain lead 0.25" from package to center of die) | L_D | | 4.5 | | nH | |
| Internal Drain Inductance (Measured from the source lead 0.25" from package to source bond pad) | L_S | | 7.5 | | nH | |
| SOURCE-DRAIN DIODE CHARACTERISTICS | | | | | | |
| Forward On-Voltage(1) | $(I_S = 2.0\text{ A}$, $V_{GS} = 0\text{ V}$, $d_i/d_t = 100\text{ A}/\mu\text{s}$) | V_{SD} | | 1.0 | 1.6 | V |
| Forward Turn-On Time | | t_{on} | | ** | | ns |
| Reverse Recovery Time | | t_{rr} | | 340 | | ns |

* Pulse Test: Pulse Width $\leq 300\mu\text{s}$, Duty Cycle $\leq 2\%$

** Negligible, Dominated by circuit inductance

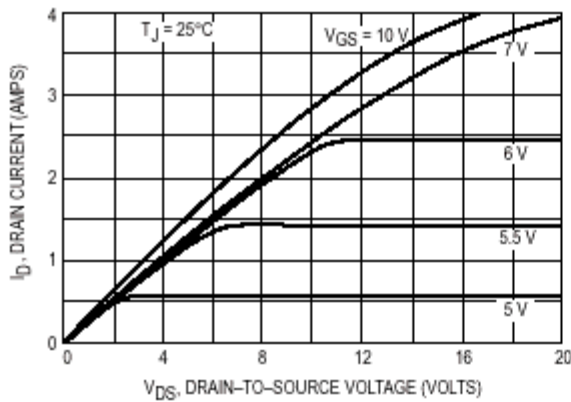
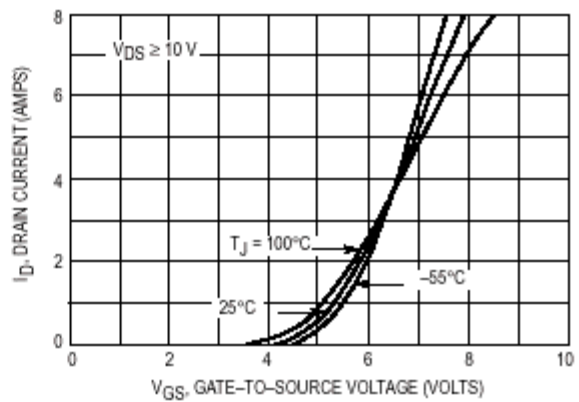
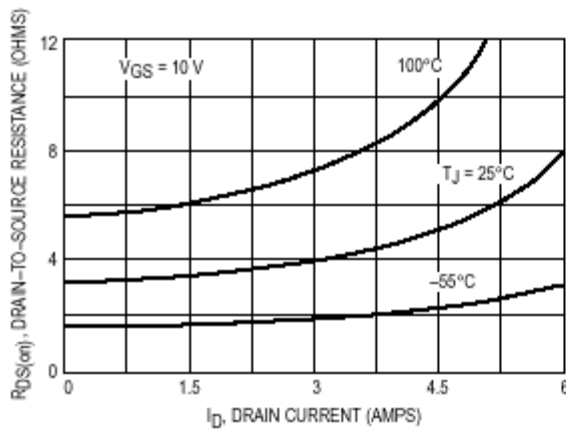
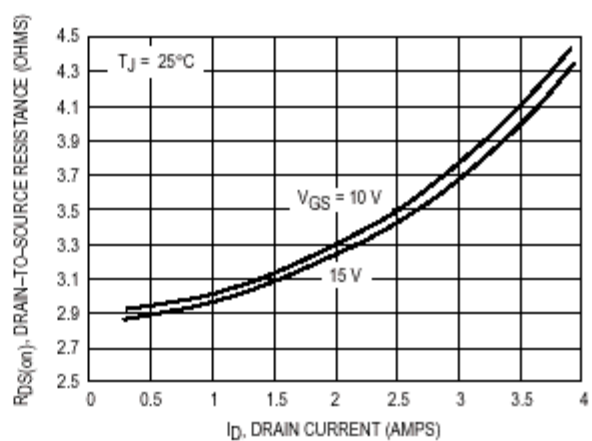
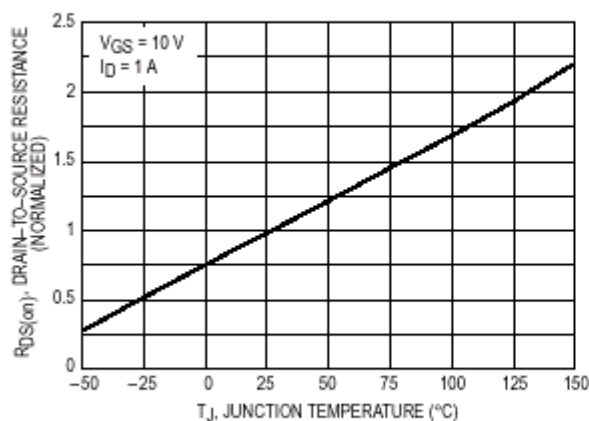
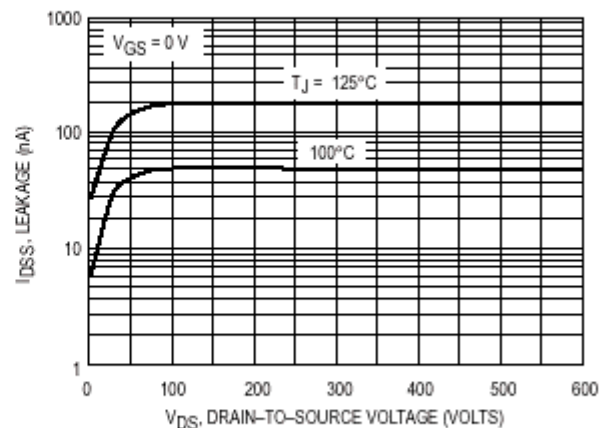
TYPICAL ELECTRICAL CHARACTERISTICS

Figure 1. On-Region Characteristics

Figure 2. Transfer Characteristics

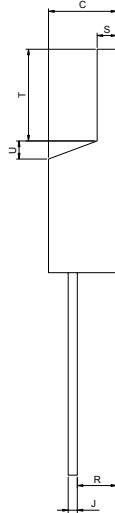
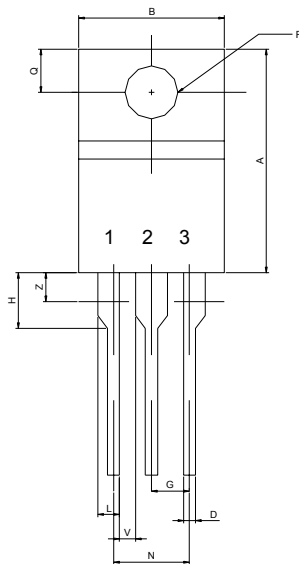
Figure 3. On-Resistance versus Drain Current and Temperature

Figure 4. On-Resistance versus Drain Current and Gate Voltage

Figure 5. On-Resistance Variation with Temperature

Figure 6. Drain-To-Source Leakage Current versus Voltage

PACKAGE DIMENSION

TO-220



PIN 1: GATE
PIN 2: DRAIN
PIN 3: SOURCE

| SYMBOLS | DIMENSIONS IN MILLIMETERS | | | DIMENSIONS IN INCHES | | |
|---------|---------------------------|-----|-------|----------------------|-----|-------|
| | MIN | NOM | MAX | MIN | NOM | MAX |
| A | 14.48 | --- | 15.75 | 0.570 | --- | 0.620 |
| B | 9.66 | --- | 10.28 | 0.380 | --- | 0.405 |
| C | 4.07 | --- | 4.82 | 0.160 | --- | 0.190 |
| D | 0.64 | --- | 0.88 | 0.025 | --- | 0.035 |
| F | 3.61 | --- | 3.73 | 0.142 | --- | 0.147 |
| G | 2.42 | --- | 2.66 | 0.095 | --- | 0.105 |
| H | 2.80 | --- | 3.93 | 0.110 | --- | 0.155 |
| J | 0.46 | --- | 0.64 | 0.018 | --- | 0.025 |
| K | 12.70 | --- | 14.27 | 0.500 | --- | 0.562 |
| L | 1.15 | --- | 1.52 | 0.045 | --- | 0.080 |
| N | 4.83 | --- | 5.33 | 0.190 | --- | 0.210 |
| Q | 2.54 | --- | 3.04 | 0.100 | --- | 0.120 |
| R | 2.04 | --- | 2.79 | 0.080 | --- | 0.110 |
| S | 1.15 | --- | 1.39 | 0.045 | --- | 0.055 |
| T | 5.97 | --- | 6.47 | 0.235 | --- | 0.255 |
| U | 0.00 | --- | 1.27 | 0.000 | --- | 0.050 |
| V | 1.15 | --- | --- | 0.045 | --- | --- |
| Z | --- | --- | 2.04 | --- | --- | 0.080 |

TO-220FP

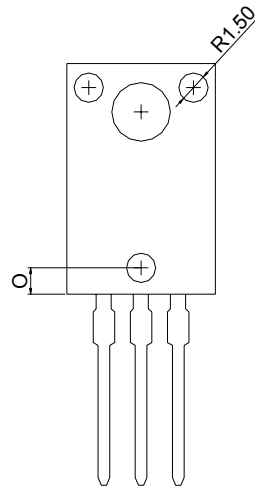
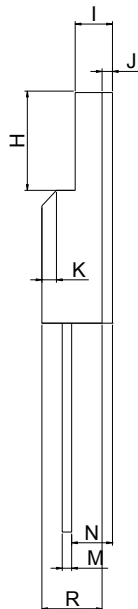
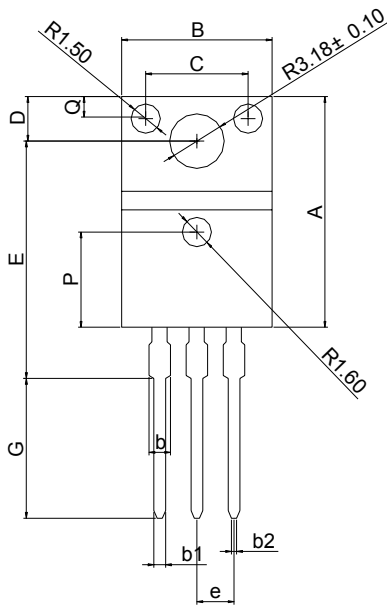

| SYMBOLS | DIMENSIONS IN MILLIMETERS | | | DIMENSIONS IN INCHES | | |
|---------|---------------------------|------|-------|----------------------|-------|-------|
| | MIN | NOM | MAX | MIN | NOM | MAX |
| A | 15.67 | --- | 16.07 | 0.617 | --- | 0.633 |
| B | 9.96 | --- | 10.36 | 0.392 | --- | 0.408 |
| C | --- | 7.00 | --- | --- | 0.275 | --- |
| D | 3.20 | --- | 3.40 | 0.126 | --- | 0.134 |
| E | 15.60 | --- | 16.00 | 0.614 | --- | 0.630 |
| G | 9.45 | --- | 10.05 | 0.372 | --- | 0.396 |
| H | 6.48 | --- | 6.88 | 0.255 | --- | 0.279 |
| I | 2.34 | --- | 2.74 | 0.092 | --- | 0.108 |
| J | --- | 0.70 | --- | --- | 0.028 | --- |
| K | --- | 1.00 | --- | --- | 0.039 | --- |
| M | 0.45 | --- | 0.60 | 0.018 | --- | 0.024 |
| N | 2.56 | --- | 2.96 | 0.101 | --- | 0.117 |
| O | --- | 1.80 | --- | --- | 0.071 | --- |
| P | --- | 6.50 | --- | --- | 0.256 | --- |
| Q | --- | 1.50 | --- | --- | 0.059 | --- |
| R | 4.50 | --- | 4.90 | 0.177 | --- | 0.193 |
| b | --- | --- | 1.47 | --- | --- | 0.058 |
| b1 | 0.70 | --- | 0.90 | 0.028 | --- | 0.035 |
| b2 | 0.25 | --- | 0.45 | 0.010 | --- | 0.018 |
| e | --- | 2.54 | --- | --- | 0.100 | --- |

Front View

Side View

Back View

PACKAGE DIMENSION

TO-251

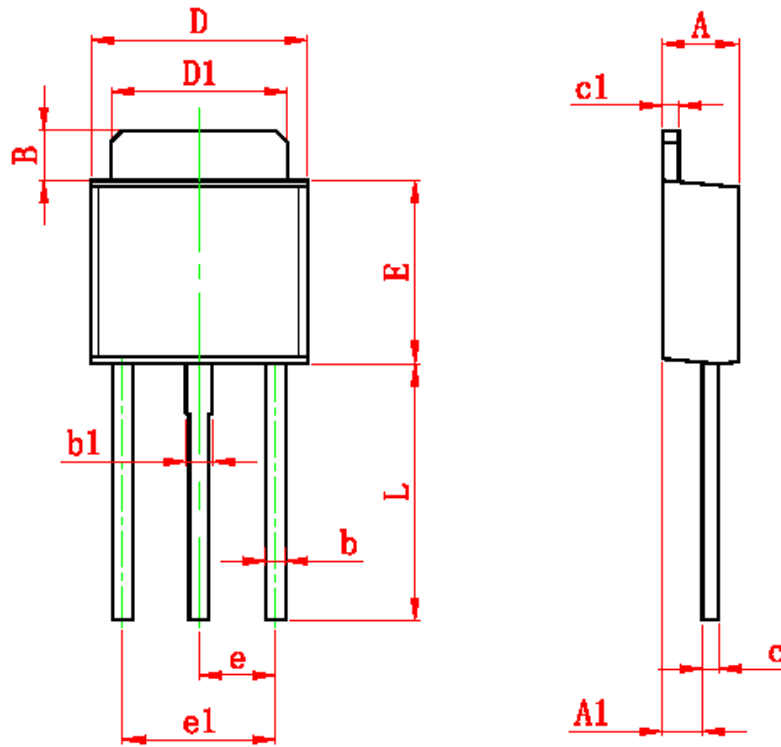

| Symbol | Dimensions In Millimeters | | Dimensions In Inches | |
|--------|---------------------------|-------|----------------------|-------|
| | Min | Max | Min | Max |
| A | 2.200 | 2.400 | 0.087 | 0.094 |
| A1 | 1.020 | 1.270 | 0.040 | 0.050 |
| B | 1.350 | 1.650 | 0.053 | 0.065 |
| b | 0.500 | 0.700 | 0.020 | 0.028 |
| b1 | 0.700 | 0.900 | 0.028 | 0.035 |
| c | 0.430 | 0.580 | 0.017 | 0.023 |
| c1 | 0.430 | 0.580 | 0.017 | 0.023 |
| D | 6.350 | 6.650 | 0.250 | 0.262 |
| D1 | 5.200 | 5.400 | 0.205 | 0.213 |
| E | 5.400 | 5.700 | 0.213 | 0.224 |
| e | 2.300 TYP | | 0.091 TYP | |
| e1 | 4.500 | 4.700 | 0.177 | 0.185 |
| L | 7.500 | 7.900 | 0.295 | 0.311 |

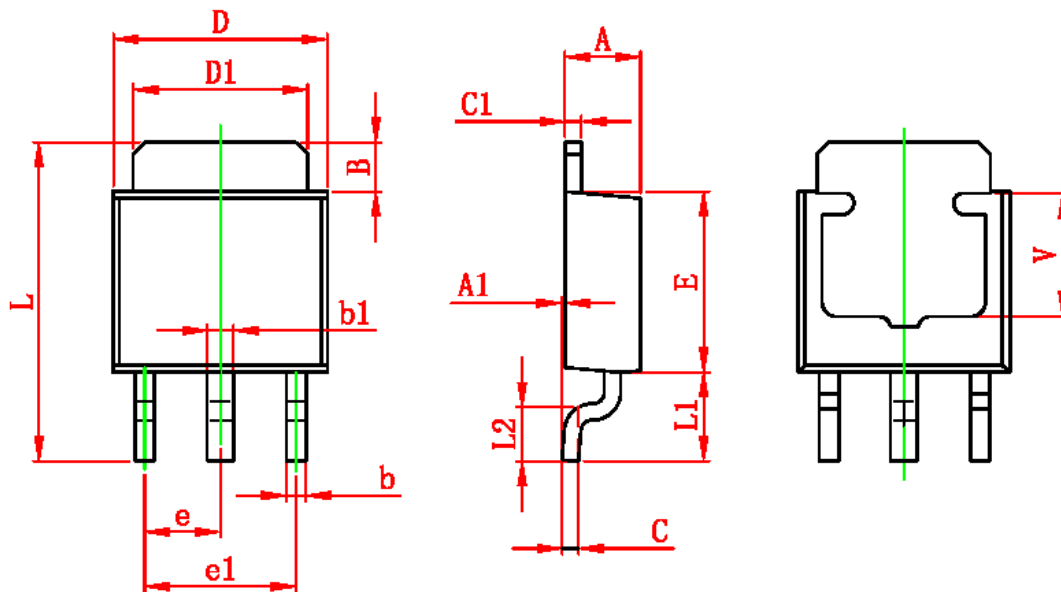
PACKAGE DIMENSION
TO-252

| Symbol | Dimensions In Millimeters | | Dimensions In Inches | |
|--------|---------------------------|-------|----------------------|-------|
| | Min | Max | Min | Max |
| A | 2.200 | 2.400 | 0.087 | 0.094 |
| A1 | 0.000 | 0.127 | 0.000 | 0.005 |
| B | 1.350 | 1.650 | 0.053 | 0.065 |
| b | 0.500 | 0.700 | 0.020 | 0.028 |
| b1 | 0.700 | 0.900 | 0.028 | 0.035 |
| c | 0.430 | 0.580 | 0.017 | 0.023 |
| c1 | 0.430 | 0.580 | 0.017 | 0.023 |
| D | 6.350 | 6.650 | 0.250 | 0.262 |
| D1 | 5.200 | 5.400 | 0.205 | 0.213 |
| E | 5.400 | 5.700 | 0.213 | 0.224 |
| e | 2.300 TYP | | 0.091 TYP | |
| e1 | 4.500 | 4.700 | 0.177 | 0.185 |
| L | 9.500 | 9.900 | 0.374 | 0.390 |
| L1 | 2.550 | 2.900 | 0.100 | 0.114 |
| L2 | 1.400 | 1.780 | 0.055 | 0.070 |
| V | 3.80 REF | | 0.150 REF | |

IMPORTANT NOTICE

Champion Microelectronic Corporation (CMC) reserves the right to make changes to its products or to discontinue any integrated circuit product or service without notice, and advises its customers to obtain the latest version of relevant information to verify, before placing orders, that the information being relied on is current.

A few applications using integrated circuit products may involve potential risks of death, personal injury, or severe property or environmental damage. CMC integrated circuit products are not designed, intended, authorized, or warranted to be suitable for use in life-support applications, devices or systems or other critical applications. Use of CMC products in such applications is understood to be fully at the risk of the customer. In order to minimize risks associated with the customer's applications, the customer should provide adequate design and operating safeguards.

HsinChu Headquarter

5F, No. 11, Park Avenue II,
Science-Based Industrial Park,
HsinChu City, Taiwan
TEL: +886-3-567 9979
FAX: +886-3-567 9909

Sales & Marketing

11F, No. 306-3, SEC. 1, Ta Tung Road,
Hsichih, Taipei Hsien 221, Taiwan
TEL: +886-2-8692 1591
FAX: +886-2-8692 1596
