

Versatile power entry module

FN 370

- Up to 6A current ratings
- IEC 950-compliant (twin fuse configurations only)
- For one or two fuses (Ø5 x 20 or Ø6.3 x 32mm)
- General-purpose application
- Nennstrom bis 6A
- IEC 950 konform (nur Konfigurationen mit zwei Sicherungen)
- Für eine oder zwei Sicherungen (Ø5 x 20mm oder Ø6,3 x 32mm)
- Universeller Einsatz
- Courants de service pouvant atteindre 6A
- Conforme à CEI 950 (uniquement pour les configurations à deux fusibles)
- Pour un ou deux fusibles (Ø5 x 20mm ou Ø6,3 x 32mm)
- Applications universelles



Filter selection table

Choose the family FN xxx with the required body style and features, and add -?? to determine current rating. Example: FN 378-2 is a horizontal screw-mounting filter for twin fuses, rated for 2A, with mini fast-on outputs.

Approvals



| Family | Current ratings A at 40°C (25°) | | | Housing style | | For fuse(s) | Weight |
|----------------|------------------------------------|---------|---------|---------------|--|-------------|--------|
| | 2 (2.4) | 4 (4.8) | 6 (7.2) | | | Nbr. | g |
| FN 370 -?? /.. | -2 | -4 | -6 | | | 1 | 55 |
| FN 372 -?? /.. | -2 | -4 | -6 | | | 2 | 55 |
| FN 376 -?? /.. | -2 | -4 | -6 | | | 1 | 55 |
| FN 378 -?? /.. | -2 | -4 | -6 | | | 2 | 60 |

| Inductance L | | | mH |
|--------------|-----|------|----|
| 0.7 | 0.3 | 0.18 | |

| Family | Current ratings A at 40°C (25°) | | | Housing style | | For fuse(s) | Weight |
|----------------|------------------------------------|---------|---------|---------------|--|-------------|--------|
| | 2 (2.4) | 4 (4.8) | 6 (7.2) | | | Nbr. | g |
| FN 375 -?? /.. | -2 | -4 | -6 | | | 2 | 65 |
| FN 379 -?? /.. | -2 | -4 | -6 | | | 2 | 70 |

| Inductance L | | | mH |
|--------------|-----|-----|----|
| 2 | 0.8 | 0.5 | |

Additional specifications

| Filter type | Capacitance | | Maximum leakage µA/phase | Res. R MΩ | Maximum operating volt. | | Operating frequency Hz | Hipot test voltage | |
|------------------------------|-------------|----------|-----------------------------|-----------------|-------------------------|-------|---------------------------|--------------------|------------|
| | Cx nF | Cy nF | | | VAC | Hz | | PN→E VAC | P→N VDC |
| All standard types | 47 | 2.2 | 190 | | 250 | 50/60 | DC to 400 | 2000 | 1700 |
| FN 375B/379B types (medical) | 47 | | 2 | 1 | 250 | 50/60 | DC to 400 | 2500 | 1700 |

MTBF at 40°C, 230V, per Mil-HB-217F: 550,000 hours

B types are optional

Filter selection: additional specifications

Ordering information:

The filters of this family can be ordered as standard, fully mounted products (excluding the fuse) as follows:

FN 379 & - 2 / x y

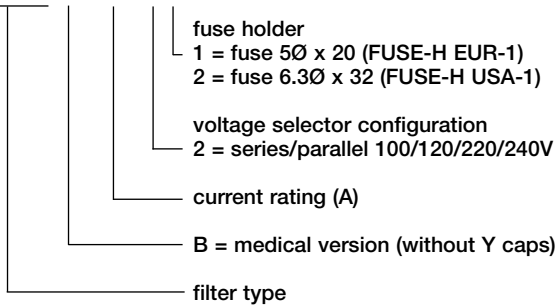

Fuse holder description

| Fuse Holder | Part no. | Size |
|-------------|--------------|------------|
| 1 | FUSE-H-EUR-1 | 5 x 20mm |
| 2 | FUSE-H-USA-1 | 6.3 x 32mm |

Voltage selector description

| Voltage Selector | Part no. | Function | Voltage marking | | | | Closed internal contacts corresponding to: | | | |
|------------------|--------------|-----------------|-----------------|-----|-----|-----|--|---------|------|------|
| | | | 1st | 2nd | 3rd | 4th | 1st | 2nd | 3rd | 4th |
| 2 | VOL-SE 4SP-1 | series/parallel | 100 | 120 | 220 | 240 | a, c, e | b, c, e | a, d | b, d |

Other selected voltage/markings on request

Mechanical data / electrical connection summary

| | FN 370/72 | FN 375 | FN 376/78 | FN 379 | Tol. mm |
|----------|-----------|---|-----------|--------|------------|
| A | 32 | | 50 | | ± 0.3 |
| B | | 58 | | | ± 0.3 |
| C | | | 40 | | ± 0.1 |
| D | 56.5 | 66.5 | 56.5 | 66.5 | - |
| F | | 5.5 | | | - |
| H | | | Ø3.3 | | - |
| M | | R<2 | | | ± 0.1 |
| N | | 55.9 ⁽¹⁾ - 56.2 ⁽²⁾ | | | +0.2 -0 |
| P | | 28.5 | | | +0.2 -0 |
| R | | | M3 | | - |
| S | | | 90° | | - |

⁽¹⁾ Wall thickness 0.8mm to 2.0mm ⁽²⁾ Wall thickness 2.1mm to 3.2mm

Thickness of mounting panels

| | |
|----------------|------------------------------------|
| 1) 0.8 - 2.0mm | 55.9 ^{+0.2} ₋₀ |
| 2) 2.1 - 3.2mm | 56.2 ^{+0.2} ₋₀ |

FN 370, FN 372, FN 375

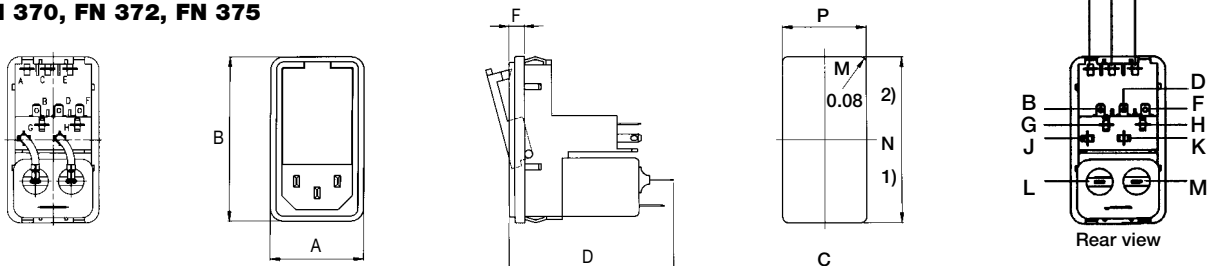

FN 376, FN 378, FN 379

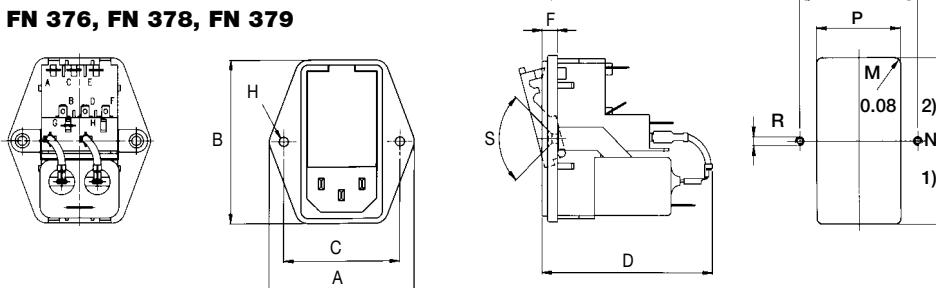

All dimensions in mm; 1 inch = 25.4mm

FN 370 insertion loss

Per CISPR 17; A = 50Ω/50Ω sym, B = 50Ω/50Ω asym, C = 0.1Ω/100Ω sym, D = 100Ω/0.1Ω sym

2 amp types (FN 370/372/376/378)

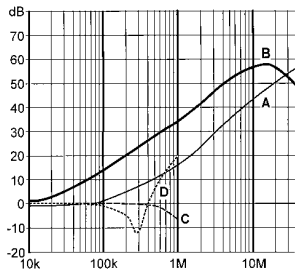

4 amp types (FN 370/372/376/378)

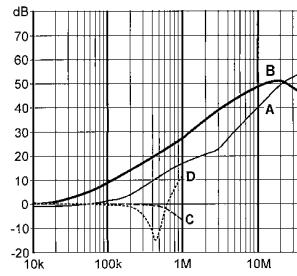

6 amp types (FN 370/372/376/378)

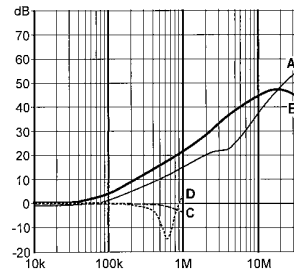

2 amp types (FN 375/379)

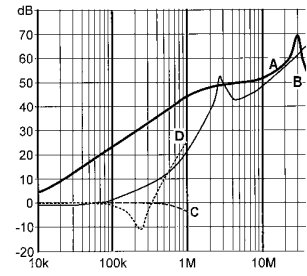

4 amp types (FN 375/379)

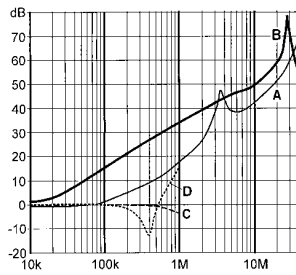

6 amp types (FN 375/379)

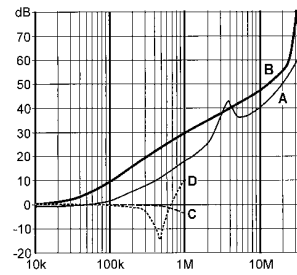

Electrical schematics

FN 370, FN 376

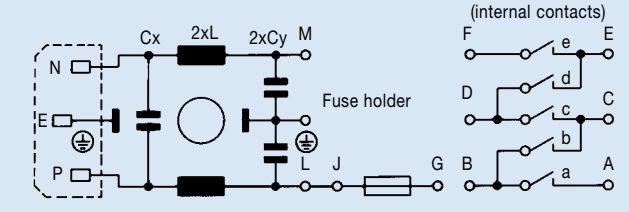

FN 372, FN 375, FN 378, FN 379

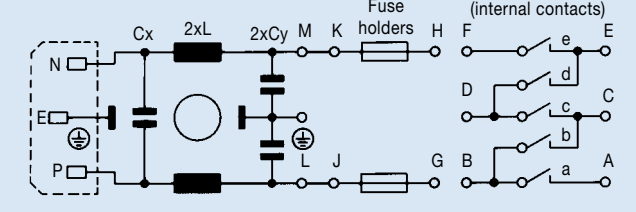

See tables for component values