



AAT9055

30V N-Channel Power MOSFET

PWMSwitch™

General Description

The AAT9055 30 V N-Channel Power MOSFET is a member of AnalogicTech™'s TrenchDMOS™ product family. Using the ultra-high density proprietary TrenchDMOS technology, this product demonstrates high power handling and small size.

Features

- $V_{DS(MAX)} = 30V$
- $I_{D(MAX)}^1 = 12 A @ T_C = 25^\circ C$
- $I_{APP(MAX)} = 6A$ in typical computer application
- LOW $R_{DS(ON)}$:
 - $56 m\Omega @ V_{GS} = 10V$
 - $90 m\Omega @ V_{GS} = 4.5V$

Applications

- DC-DC converters
- High current load switches
- LDO output

DPAK Package

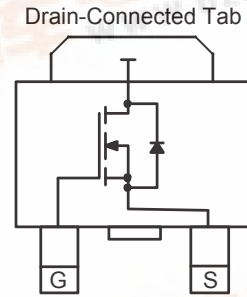

Absolute Maximum Ratings ($T_C=25^\circ C$ unless otherwise noted)

Symbol	Description	Value	Units
V_{DS}	Drain-Source Voltage	30	V
V_{GS}	Gate-Source Voltage	± 20	
I_D	Continuous Drain Current @ $T_J=150^\circ C$ ¹	$T_C = 25^\circ C$	± 12
		$T_C = 70^\circ C$	± 10
I_{DM}	Pulsed Drain Current ³	± 16	A
I_S	Continuous Source Current (Source-Drain Diode) ¹	12	
P_D	Maximum Power Dissipation ¹	$T_C = 25^\circ C$	22
		$T_C = 70^\circ C$	14
T_J, T_{STG}	Operating Junction and Storage Temperature Range	-55 to 150	$^\circ C$

Thermal Characteristics

Symbol	Description	Value	Units
$R_{\theta JA}$	Maximum Junction-to-Ambient	100	$^\circ C/W$
R_{TYP}	Typical Junction to ambient on PC board ²	28	$^\circ C/W$
$R_{\theta JC}$	Maximum Junction-to-Case	5.5	$^\circ C/W$

Preliminary Information

Electrical Characteristics (T_J=25°C unless otherwise noted)

Symbol	Description	Conditions	Min	Typ	Max	Units
DC Characteristics						
BV _{DSS}	Drain-Source Breakdown Voltage	V _{GS} =0V, I _D =250μA	30			V
R _{DS(ON)}	Drain-Source ON-Resistance ³	V _{GS} =10V, I _D =12A		44	56	mΩ
		V _{GS} =4.5V, I _D =10A		68	90	
I _{D(ON)}	On-State Drain Current ³	V _{GS} =10V, V _{DS} =5V (Pulsed)	16			A
V _{GS(th)}	Gate Threshold Voltage	V _{GS} =V _{DS} , I _D =250μA	1.0			V
I _{GSS}	Gate-Body Leakage Current	V _{GS} =±20V, V _{DS} =0V			±100	nA
I _{DSS}	Drain Source Leakage Current	V _{GS} =0V, V _{DS} =30V			1	μA
		V _{GS} =0V, V _{DS} =30V, T _J =70°C			25	
g _{fs}	Forward Transconductance ³	V _{DS} =5V, I _D =4A		6		S
Dynamic Characteristics ⁴						
Q _G	Total Gate Charge	V _{DS} =15V, R _D =2.5Ω, V _{GS} =5V		4.2		nC
Q _{GT}	Total Gate Charge	V _{DS} =15V, R _D =2.5Ω, V _{GS} =10V		7.7		
Q _{GS}	Gate-Source Charge	V _{DS} =15V, R _D =2.5Ω, V _{GS} =10V		1.35		
Q _{GD}	Gate-Drain Charge	V _{DS} =15V, R _D =2.5Ω, V _{GS} =10V		1.2		
t _{D(ON)}	Turn-ON Delay	V _{DD} =15V, R _D =2.5Ω, V _{GS} =10V, R _G =6Ω		2.5		ns
t _R	Turn-ON Rise Time	V _{DD} =15V, R _D =2.5Ω, V _{GS} =10V, R _G =6Ω		2.6		
t _{D(OFF)}	Turn-OFF Delay	V _{DD} =15V, R _D =2.5Ω, V _{GS} =10V, R _G =6Ω		12		
t _F	Turn-OFF Fall Time	V _{DD} =15V, R _D =2.5Ω, V _{GS} =10V, R _G =6Ω		5.7		
Source-Drain Diode Characteristics						
V _{SD}	Source-Drain Forward Voltage ³	V _{GS} =0, I _S =12A		1.2	1.5	V
I _S	Continuous Diode Current ¹				12	A

Notes:

- Based on thermal dissipation from junction to case. $R_{\theta JC} + R_{\theta CA} = R_{\theta JA}$ where the case thermal reference is defined as the solder mounting surface of the drain tab. $R_{\theta JC}$ is guaranteed by design, however $R_{\theta CA}$ is determined by the PCB design. Package current is limited to 8A DC and 16A pulsed.
- Mounted on typical computer main board.
- Pulse measurement 300 μs.
- Guaranteed by design. Not subject to production testing.

Typical Characteristics

Output Characteristics

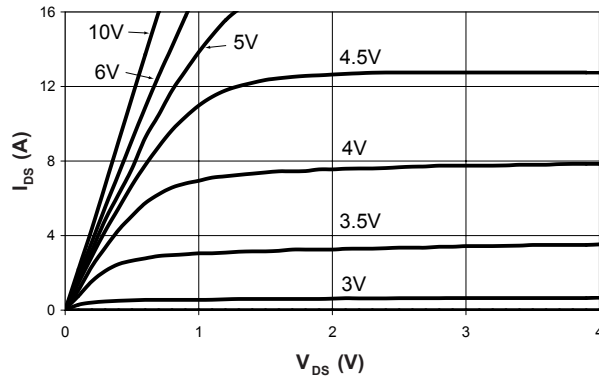

Transfer Characteristics

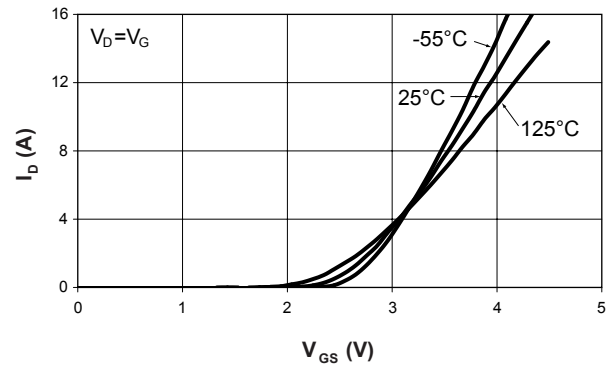

On-Resistance vs. Drain Current

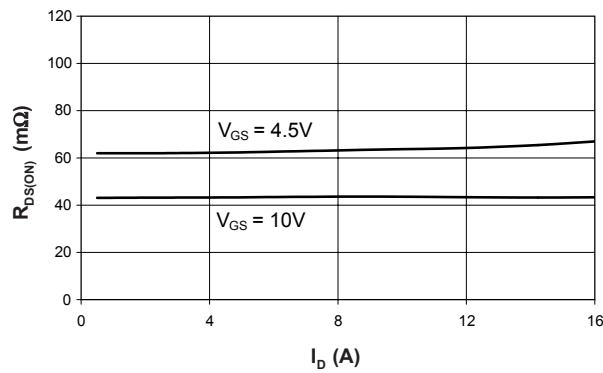

On-Resistance vs. Gate to Source Voltage

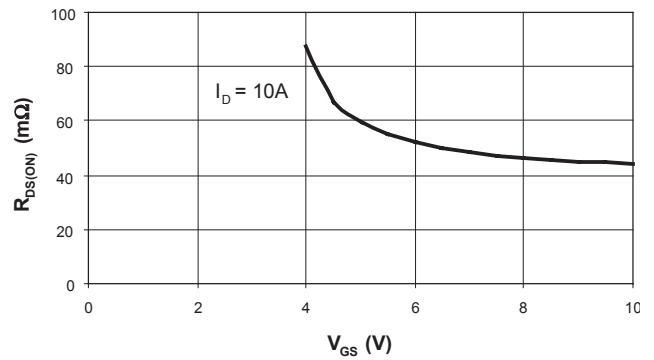

Gate Charge

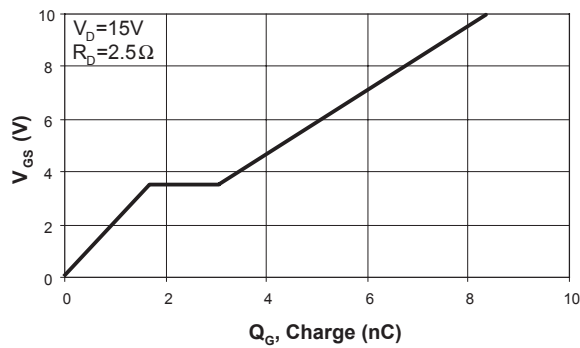

Source-Drain Diode Forward Voltage

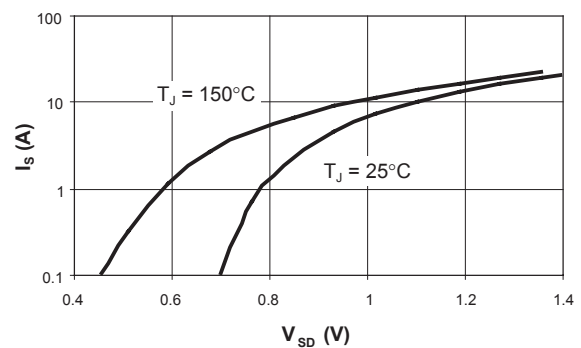

Ordering Information

Package	Marking	Part Number (Tape and Reel)
TO-252 (DPAK)	9055	AAT9055INY-T1

Note: Sample stock is generally held on all part numbers listed in **BOLD**.

Package Information

TO-252 (DPAK)

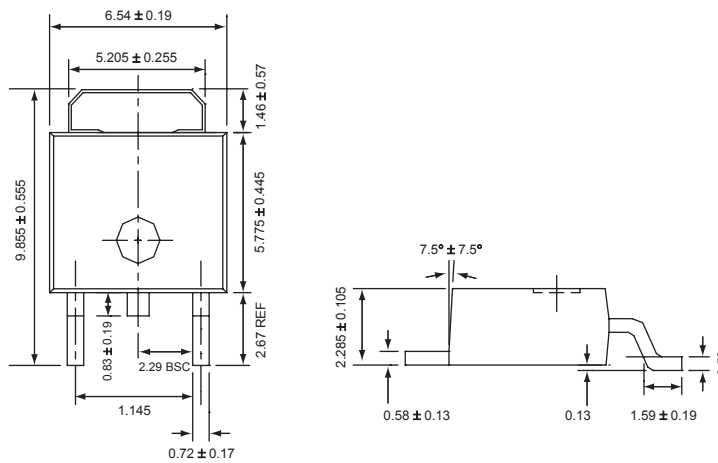

All measurements in millimeters.

AnalogicTech cannot assume responsibility for use of any circuitry other than circuitry entirely embodied in an AnalogicTech product. No circuit patent licenses, copyrights, mask work rights, or other intellectual property rights are implied.

AnalogicTech reserves the right to make changes to their products or specifications or to discontinue any product or service without notice, and advise customers to obtain the latest version of relevant information to verify, before placing orders, that information being relied on is current and complete. All products are sold subject to the terms and conditions of sale supplied at the time of order acknowledgement, including those pertaining to warranty, patent infringement, and limitation of liability.

AnalogicTech warrants performance of its semiconductor products to the specifications applicable at the time of sale in accordance with AnalogicTech's standard warranty. Testing and other quality control techniques are utilized to the extent AnalogicTech deems necessary to support this warranty. Specific testing of all parameters of each device is not necessarily performed.