



TK11044

**ADVANCED INFORMATION**

**TEMPERATURE SENSOR IC**

**FEATURES**

- Linear Output Voltage 10 mV/°C Output
- 2.4 to 8.0 Volt Supply Range
- Miniature Package (SOT-23L)
- Minimum External Parts Count
- Low Power Consumption

**APPLICATIONS**

- Home and Industrial Thermostats
- Automotive Climate Control
- Battery Charger Temperature Monitor
- Notebook Computer Temperature Monitor
- Electronic Thermometers
- Fish Finder Water Temperature
- Industrial Process Controllers
- Home Appliance Temperature Control

**DESCRIPTION**

The TK11044 is a temperature sensor IC with a linear output of 10 mV/°C over the range of -25 to + 105 °C. Its wide operating voltage range of 2.4 to 8.0 volts makes it suitable for a number of applications requiring accurate temperature control, such as electronic thermostats for climate control, refrigerators, and industrial process controls.

A typical application is to make a digital representation of temperature with an A/D converter, or to make a thermal detector with a comparator.

The TK11044 has a compensation pin for a 0.1 μF capacitor that insures stability over the IC's operating temperature range.

The TK11044 is available in a miniature SOT 23L-6 surface mount package.

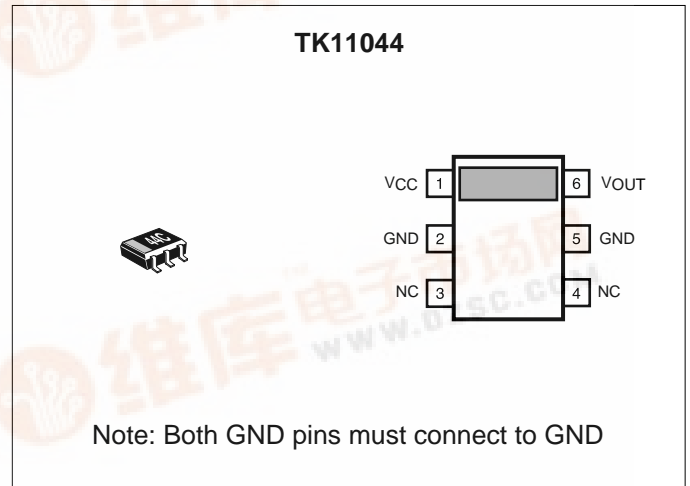

**ORDERING INFORMATION**

TK11044M-1 Tape/Reel Code

TAPE/REEL CODE  
TL: Tape Left

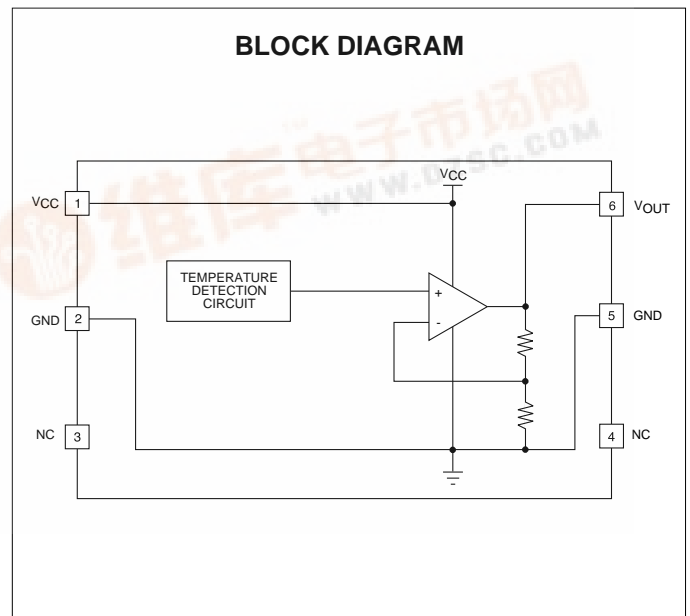

**ABSOLUTE MAXIMUM RATINGS**

Supply Voltage .....	12 V	Storage Temperature Range .....	-55 to +150 °C
Operating Voltage .....	2.4 to 8 V	Operating Temperature Range .....	-25 to +105 °C
Power Dissipation (Note 1) .....	200 mW	Lead Soldering Temp. (10 s).....	235 °C
Junction Temperature .....	150 °C		

**TK11044 ELECTRICAL CHARACTERISTICS**

Test Conditions:  $V_{CC} = 3.0\text{ V}$ ,  $I_{OUT} = 0\ \mu\text{A}$ ,  $T_A = 25\ ^\circ\text{C}$ , unless otherwise specified.

SYMBOL	PARAMETER	TEST CONDITIONS	MIN	TYP	MAX	UNITS
$V_{OUT}$	Output Voltage	$T_A = 25\ ^\circ\text{C}$	965	995	1025	mV
		$T_A = 85\ ^\circ\text{C}$	1573	1613	1653	mV
		$T_A = -25\ ^\circ\text{C}$		480		mV
$T_C$	Temperature Coefficient	$T_A = 25\ ^\circ\text{C}$ to $85\ ^\circ\text{C}$	9.5	10.3	11.1	mV/ °C
Line Reg	Line Regulation	$V_{CC} = 3\text{ V}$ to $5\text{ V}$	-20	-5	20	mV
Load Reg	Load Regulation	$I_{OUT} = 0\ \mu\text{A}$ to $400\ \mu\text{A}$		3	20	mV
$I_{CC}$	Supply Current	$T_A = 25\ ^\circ\text{C}$		160	200	$\mu\text{A}$
$I_{OUT}$	Output Current	$\Delta V_{OUT} \leq 20\text{ mV}$			400	$\mu\text{A}$

Note 1: Power dissipation is 200 mW when mounted as recommended. Derate at 1.6 mW/°C for operation above 25 °C.

TEST CIRCUIT

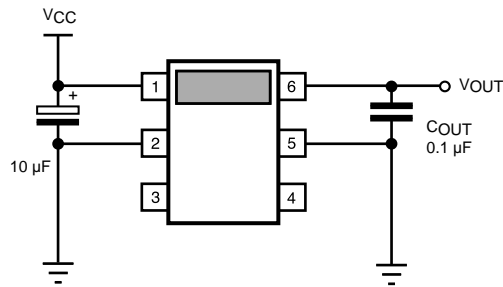

TYPICAL PERFORMANCE CHARACTERISTICS

$V_{CC} = 3\text{ V}$ ,  $I_{OUT} = 0\ \mu\text{A}$ ,  $T_A = 25\ ^\circ\text{C}$ , unless otherwise specified.

OUTPUT VOLTAGE vs. TEMPERATURE

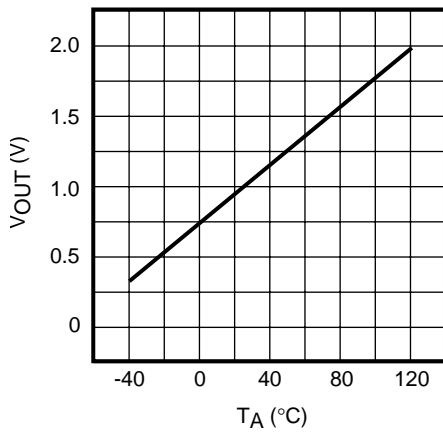

LINEARITY ERROR vs. TEMPERATURE

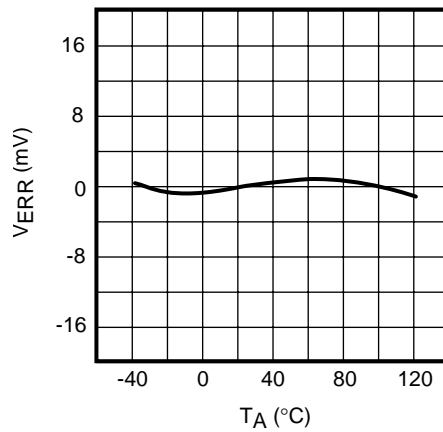

INPUT CURRENT vs. TEMPERATURE

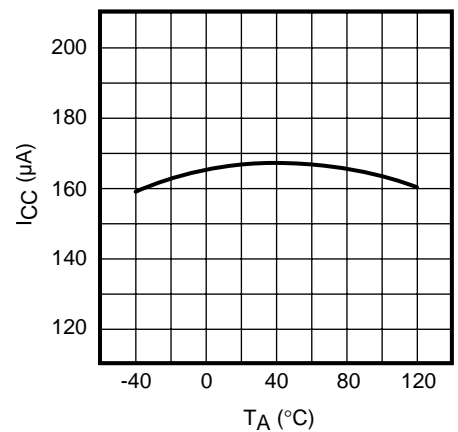

INPUT CURRENT vs. INPUT VOLTAGE

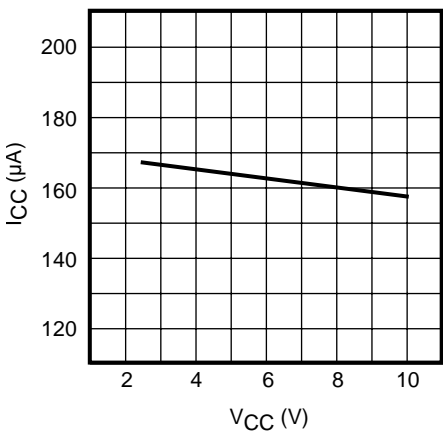

LINE REGULATION

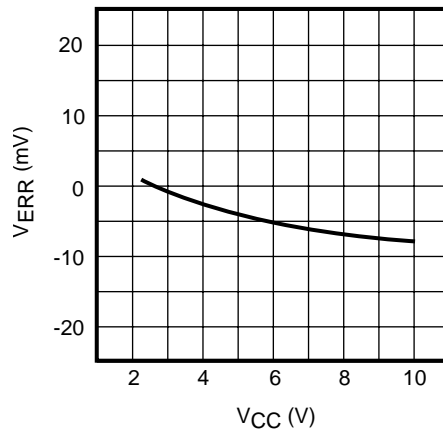

LOAD REGULATION

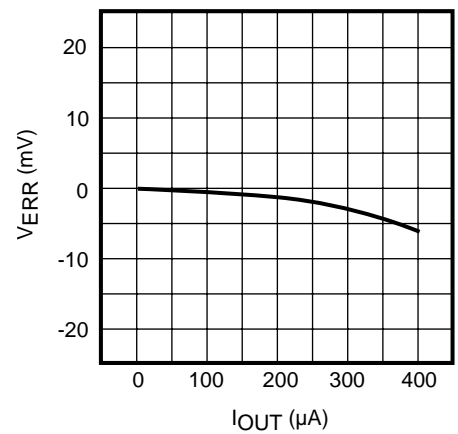

TYPICAL PERFORMANCE CHARACTERISTICS

$V_{CC} = 3\text{ V}$ ,  $I_{OUT} = 0\ \mu\text{A}$ ,  $T_A = 25\ ^\circ\text{C}$ , unless otherwise specified.

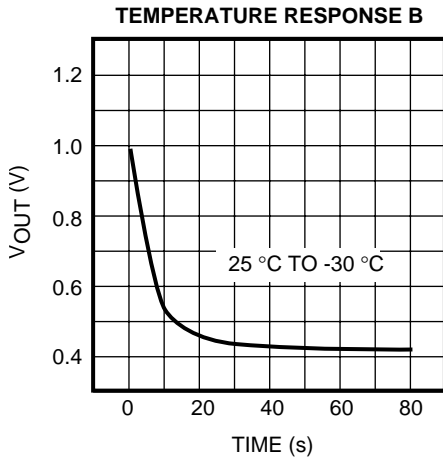
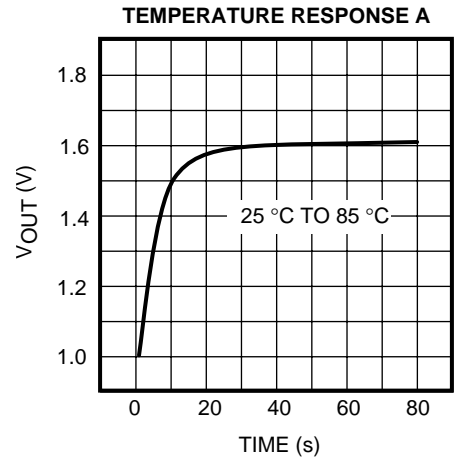
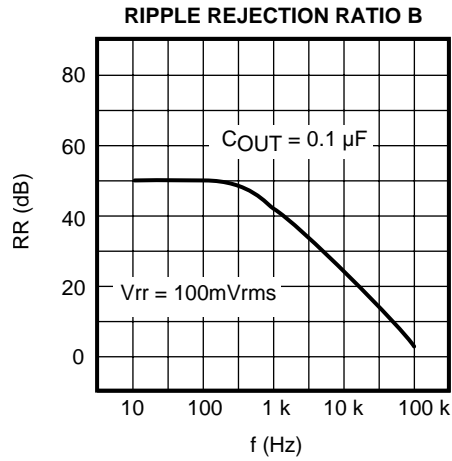
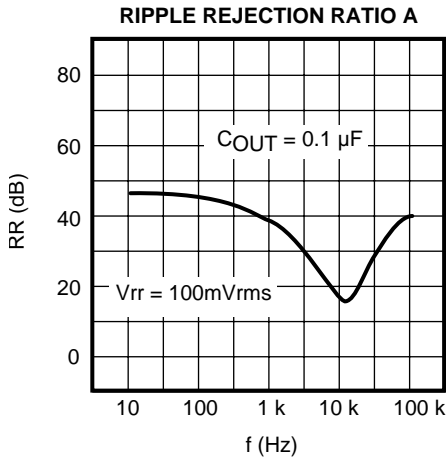

PACKAGE OUTLINE

SOT 23L-6

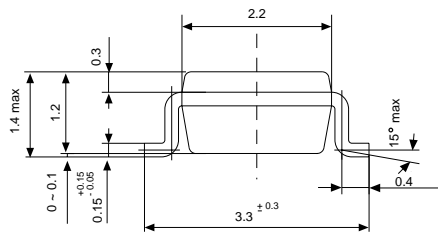
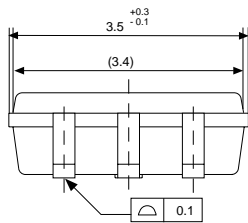
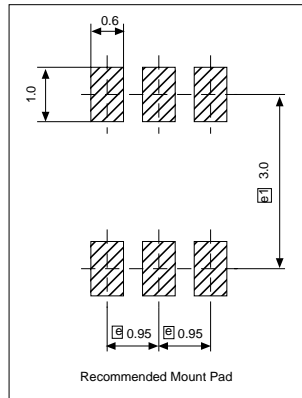
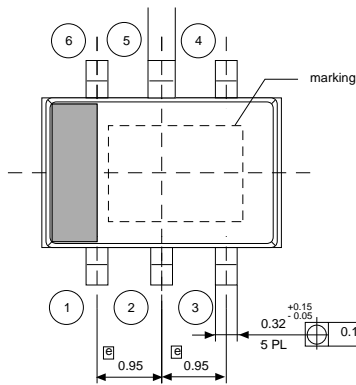

Dimensions are shown in millimeters  
Tolerance: x.x ± 0.2 mm (unless otherwise specified)

Marking Information

TK11044

Marking  
44C

The information furnished by TOKO, Inc. is believed to be accurate and reliable. However, TOKO reserves the right to make changes or improvements in the design, specification or manufacture of its products without further notice. TOKO does not assume any liability arising from the application or use of any product or circuit described herein, nor for any infringements of patents or other rights of third parties which may result from the use of its products. No license is granted by implication or otherwise under any patent or patent rights of TOKO, Inc.



TOKO AMERICA REGIONAL OFFICES

**Midwest Regional Office**  
Toko America, Inc.  
1250 Feehanville Drive  
Mount Prospect, IL 60056  
Tel: (847) 297-0070  
Fax: (847) 699-7864

**Western Regional Office**  
Toko America, Inc.  
2480 North First Street, Suite 260  
San Jose, CA 95131  
Tel: (408) 432-8281  
Fax: (408) 943-9790

**Eastern Regional Office**  
Toko America, Inc.  
107 Mill Plain Road  
Danbury, CT 06811  
Tel: (203) 748-6871  
Fax: (203) 797-1223

**Semiconductor Technical Support**  
Toko Design Center  
4755 Forge Road  
Colorado Springs, CO 80907  
Tel: (719) 528-2200  
Fax: (719) 528-2375