

SMD POWER INDUCTORS

MODEL NO. : SPC-1207P SERIES (CDRH127 COMPATIBLE)

FEATURES:

- * SUPERIOR QUALITY FROM AN AUTOMATED PRODUCTION LINE.
- * PICK AND PLACE COMPATIBLE.
- * TAPE AND REEL PACKING.

APPLICATION :

- * NOTEBOOK COMPUTERS.
- * DC-DC CONVERTORS.
- * DC-AC INVERTER.



ELECTRICAL SPECIFICATION:

PHYSICAL DIMENSION :

(UNIT:mm)

PART NO.	INDUCTANCE (uH)	D.C.R. MAX (Ω)	RATED CURRENT (ADC)
SPC-1207P-1R2	1.2	0.007	9.80
SPC-1207P-2R4	2.4	0.0115	8.00
SPC-1207P-3R5	3.5	0.0135	7.50
SPC-1207P-4R7	4.7	0.0158	6.80
SPC-1207P-6R1	6.1	0.0176	6.60
SPC-1207P-8R2	8.2	0.0210	5.40
SPC-1207P-100	10	0.0216	5.40
SPC-1207P-120	12	0.0243	4.90
SPC-1207P-150	15	0.0270	4.50
SPC-1207P-180	18	0.0392	3.90
SPC-1207P-220	22	0.0432	3.60
SPC-1207P-270	27	0.0459	3.40
SPC-1207P-330	33	0.0648	3.00
SPC-1207P-390	39	0.0729	2.75
SPC-1207P-470	47	0.10	2.50
SPC-1207P-560	56	0.11	2.35
SPC-1207P-680	68	0.14	2.10
SPC-1207P-820	82	0.16	1.95
SPC-1207P-101	100	0.22	1.70
SPC-1207P-121	120	0.25	1.60
SPC-1207P-151	150	0.28	1.42
SPC-1207P-181	180	0.35	1.30
SPC-1207P-221	220	0.39	1.16
SPC-1207P-271	270	0.56	1.06
SPC-1207P-331	330	0.64	0.95
SPC-1207P-391	390	0.70	0.88
SPC-1207P-471	470	0.98	0.79
SPC-1207P-561	560	1.07	0.73
SPC-1207P-681	680	1.46	0.67
SPC-1207P-821	820	1.64	0.60
SPC-1207P-102	1000	1.82	0.55

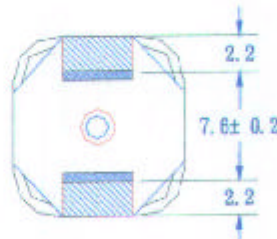
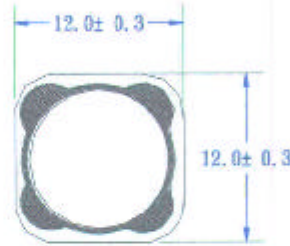

TOLERANCE : ± 0.3

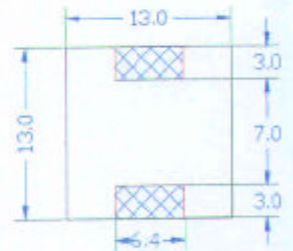

PCB PATTERN

NOTE(1): TEST FREQUENCY: 1.2uH~ 8.2uH:100KHZ, 1 VRMS. 10uH~1mH :1 KHZ, 1VRMS.

NOTE(2): 1.2uH~8.2uH: +40%/-20%, 10uH~1000uH ± 20%

NOTE (3): THIS INDICATES THE VALUE OF DC CURRENT WHICH THE INDUCTANCE IS 10% LOWER THAN ITS INITIAL VALUE AND/OR ΔT=40°C UNDER THIS DC CURRENT BIAS.

Copyright © Each Manufacturing Company.

All Datasheets cannot be modified without permission.

This datasheet has been download from :

www.AllDataSheet.com

100% Free DataSheet Search Site.

Free Download.

No Register.

Fast Search System.

www.AllDataSheet.com