

POWERLINE - DC/DC-Converter

E-Series, 30 Watt, 1.6 kV Isolation & Wide Input Range (Single Output)

RECOM

Specifications (typical at nominal input and 25°C unless otherwise noted)

Input Voltage Range	24V nominal 48V nominal	18-36VDC 36-75VDC
Input Filter		LC Type
Voltage Accuracy		±1%
Ripple and Noise, 20MHz BW		See Table
Line Regulation, HL-LL		±0.2%
Load Regulation, 100% to 10% Full Load		±0.5%
Efficiency		See Table
Temperature Coefficient		±0.02%/°C
Short Circuit Protection		Continuous
Transient Response Recovery Time, 25% Load Step Change		400msec
Transit voltage peak deviation		150mV max.
Control voltage referenced to negativ(-)input Compatibility		CMOS, TTL
On-control		4.8V min. or open
Off-control		0.4V max. or short
Switching frequency		300kHz, typ.
Isolation Voltage		1600VDC min.
Isolation Resistance		10 ⁹ Ω, min
Maximum Case Temperature		+100°C
Operating Temperature Range		-25°C to +71°C
Storage temperature range		-55°C to +105°C
Cooling		Free-air convection
EMI/RFI		Six-sided Continuous Shield
Case Material		Nickel-Coated Copper with Non-Conductive Base
Dimensions		50.8 x 40.6 x 10.2 mm
MTBF (MIL-HDBK-217F TA = 25°C full load)		2 x 10 ⁶ Hours

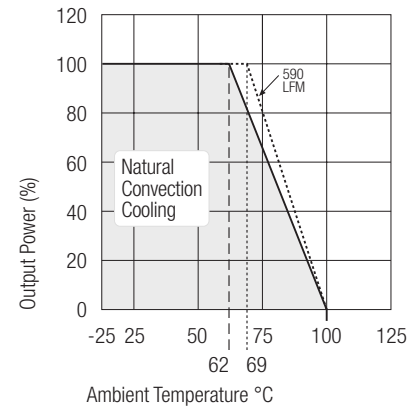

Package Style and Pinning (mm)

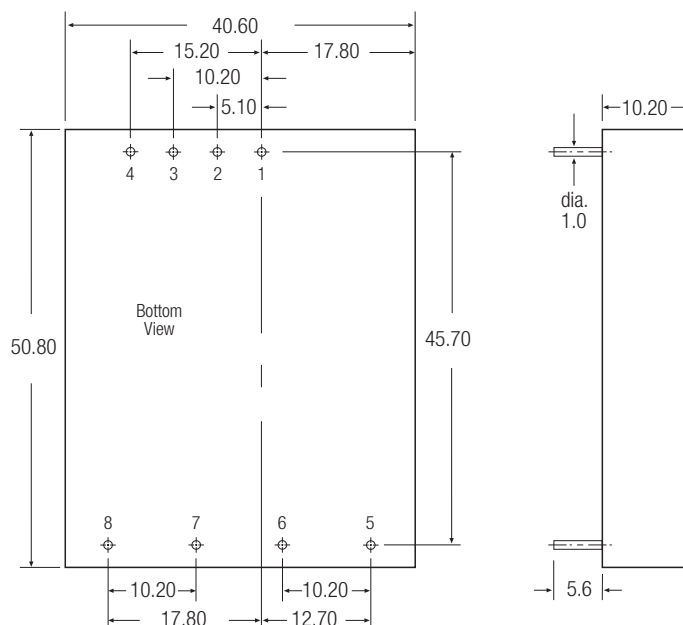

Pin Connections

Pin #	Single
1	+Vin
2	-Vin
3	No Pin
4	Ctrl
5	No Pin
6	+Vout
7	-Vout
8	Trim

Pin Pitch Tolerance ±0.5 mm