

# SKa 3

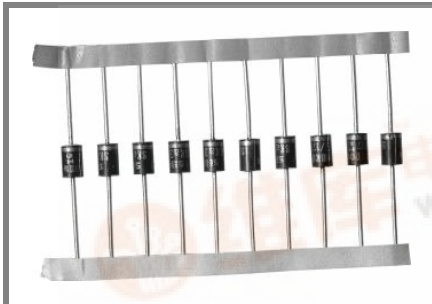

Axial Lead Diode

## Avalanche Diode

SKa 3

### Features

- Avalanche type reverse characteristic
- Transient voltage proof within specified limits
- Taped for automatic insertion
- Available with formed leads on request
- Plastic material used carries Underwriter Laboratories flammability classification 94V-0

### Typical Applications

- DC supply for magnetes or solenoids (brakes, valves etc.)
- Series connections for high voltage applications (dust precipitators)

$V_{(BR)min}$	$I_{FRMS} = 6,7 A$ (maximum value for continuous operation)	$C_{max}$	$R_{min}$
V	$I_{FAV} = 3 A$ (sin. 180; $T_r = 90 ^\circ C$ )	$\mu F$	$\Omega$
1300	SKa 3/13	1600	2
1700	SKa 3/17	800	4

Symbol	Conditions	Values	Units
$I_{FAV}$	$T_r = 85 ^\circ C$ ; L = 10 mm; sin. 180	3,3	A
$I_{FAV}$	$T_a = 45 ^\circ C$ ; PCB 50 x 50 mm	1,8	A
$I_{FSM}$	$T_{vj} = 25 ^\circ C$ ; 10 ms	180	A
	$T_{vj} = 150 ^\circ C$ ; 10 ms	150	A
$i^2t$	$T_{vj} = 25 ^\circ C$ ; 8,3 ... 10 ms	162	A <sup>2</sup> s
	$T_{vj} = 150 ^\circ C$ ; 8,3 ... 10 ms	112,5	A <sup>2</sup> s
$V_F$	$T_{vj} = 25 ^\circ C$ ; $I_F = 10 A$	max. 1,2	V
$V_{(TO)}$	$T_{vj} = 150 ^\circ C$	max. 0,85	V
$r_T$	$T_{vj} = 150 ^\circ C$	max. 30	m $\Omega$
$I_{RD}$	$T_{vj} = 150 ^\circ C$ ; $V_{RD} = V_{(BR)min}$	max. 600	$\mu A$
$P_{RSM}$	$T_{vj} = 150 ^\circ C$ ; $t_p = 10 \mu s$	1,8	kW
$R_{th(j-r)}$	L = 10 mm	18	K/W
$R_{th(j-a)}$	PCB 50 x 50 mm	60	K/W
$T_{vj}$		- 40 ... + 150	$^\circ C$
$T_{stg}$		- 40 ... + 150	$^\circ C$
$T_{sold}$	max. 10 s; L > 9 mm	250	$^\circ C$
$V_{isol}$		-	V~
a		5 * 9,81	m/s <sup>2</sup>
m	approx.	1	g
Case	1500 diodes per reel	E 34	



# SKa 3

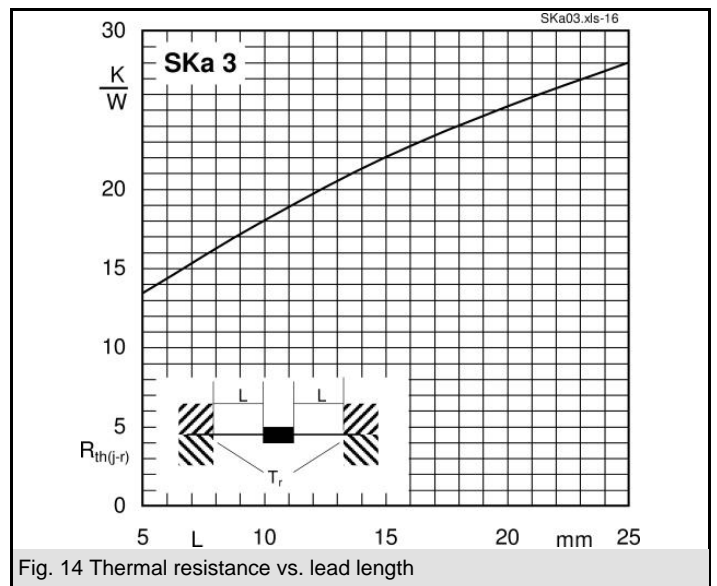
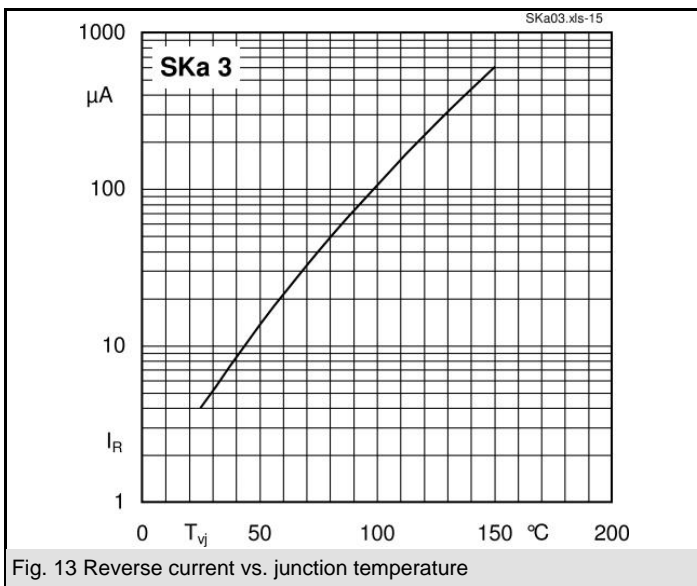
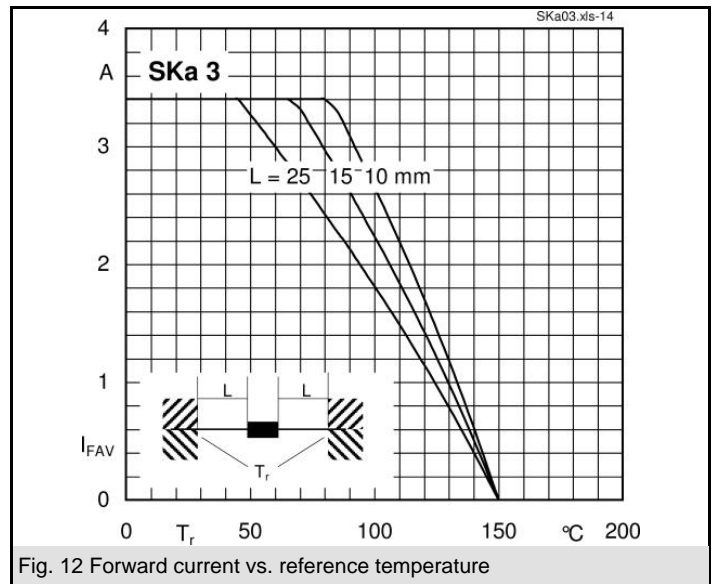
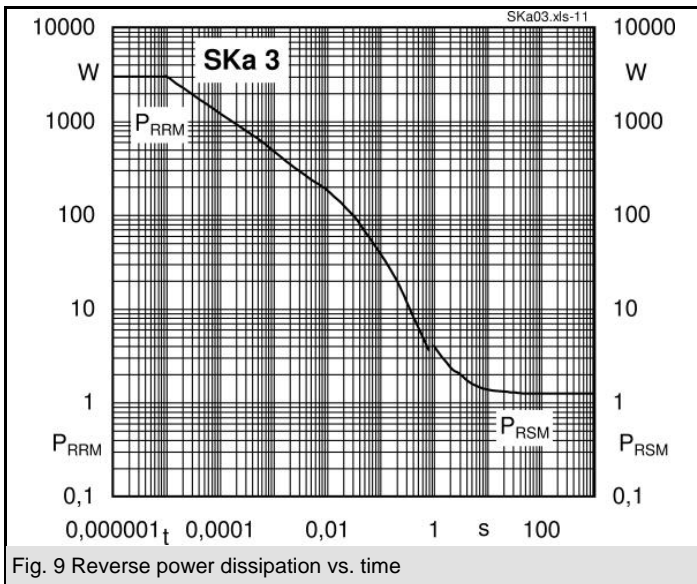
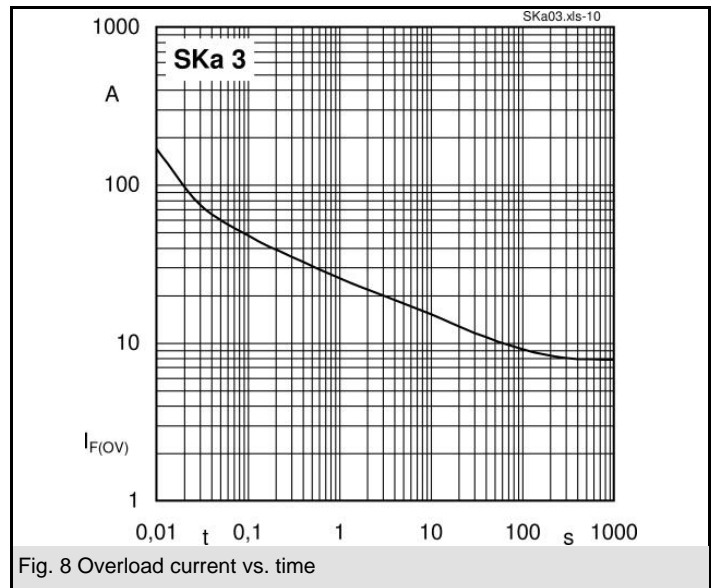
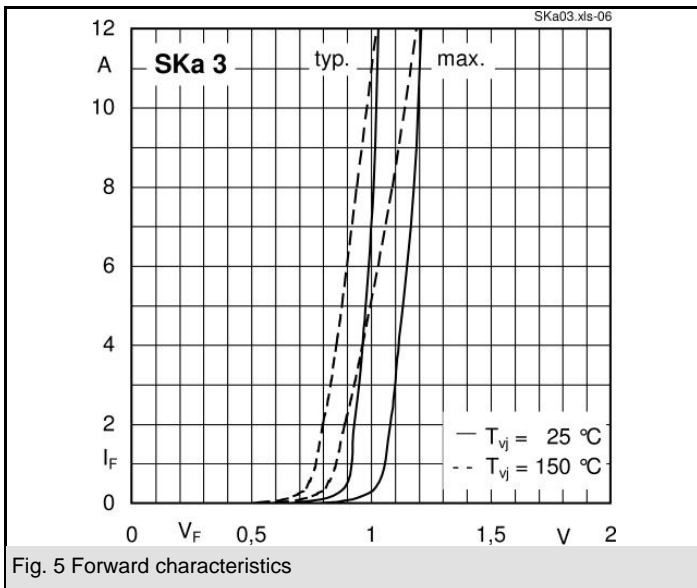

# SKa 3

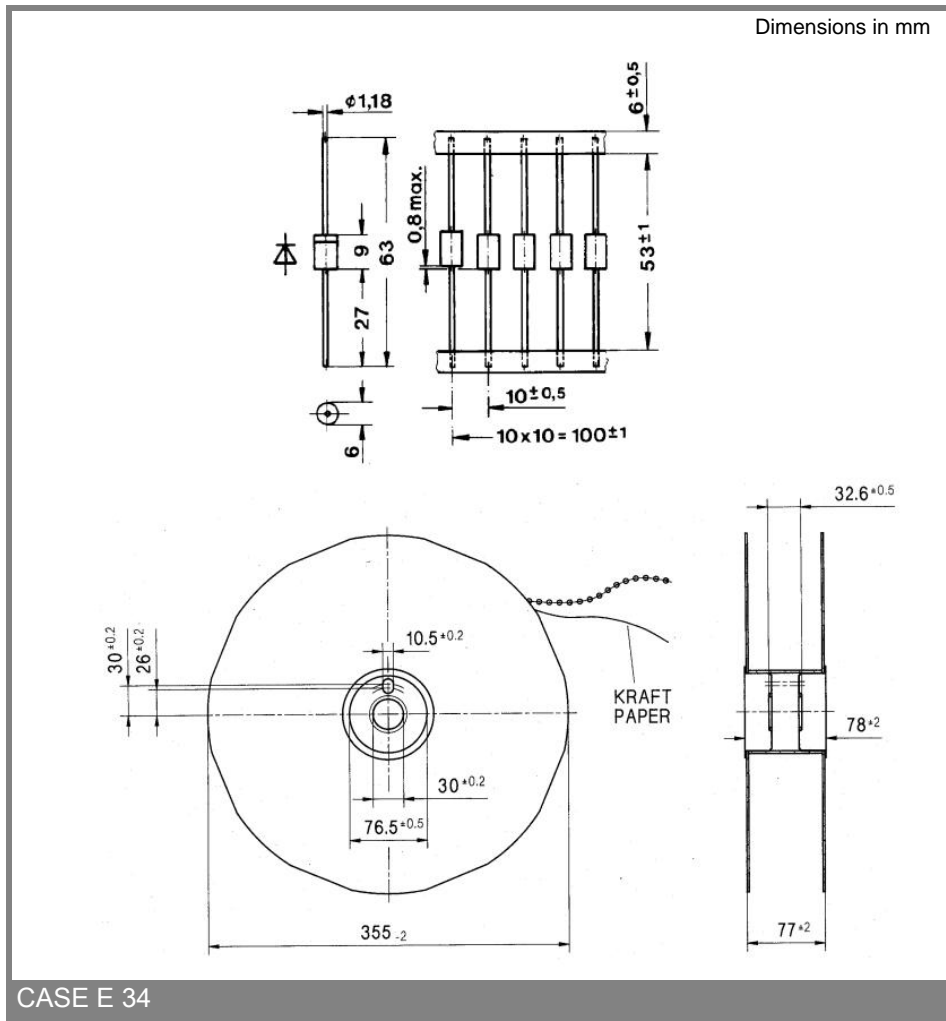

This technical information specifies semiconductor devices but promises no characteristics. No warranty or guarantee expressed or implied is made regarding delivery, performance or suitability.

Copyright © Each Manufacturing Company.

All Datasheets cannot be modified without permission.

This datasheet has been download from :

[www.AllDataSheet.com](http://www.AllDataSheet.com)

100% Free DataSheet Search Site.

Free Download.

No Register.

Fast Search System.

[www.AllDataSheet.com](http://www.AllDataSheet.com)