

**Specification Status: RELEASED**

**Max Electrical Rating at 20°C**

**Operating Voltage: 250V<sub>DC</sub>**  
**Interrupt Current: 3A<sub>RMS</sub>**

**Fault Voltage: 600V<sub>RMS</sub>**

**Lead Material: 22 AWG Sn plated copper**  
 (0.65 mm [0.026"] nominal diameter)

**Marking:**

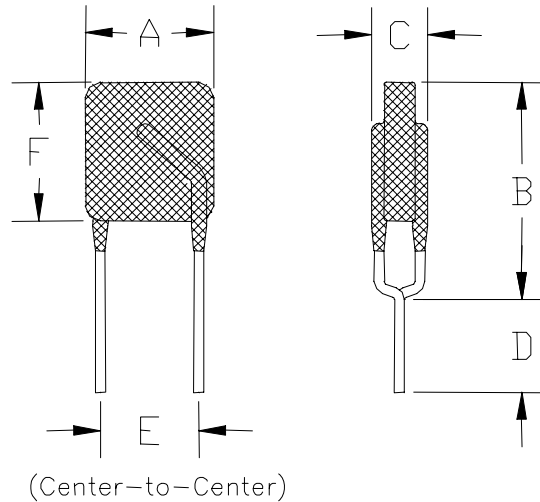
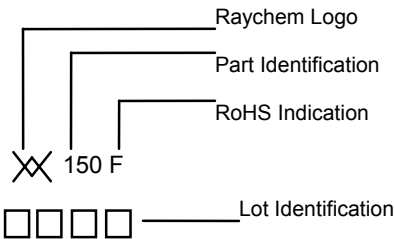

**TABLE I. DIMENSIONS**

	A		B		C		D		E	F	
	Min	Max	Min	Max	Min	Max	Min	Max	Nom	Min	Max
mm:	--	9.0	--	12.5	--	4.6	4.7	--	5.0	--	9.0
in:	--	(0.354)	--	(0.492)	--	(0.180)	(0.185)	--	(0.197)	--	(0.354)

**TABLE II. PERFORMANCE RATINGS @ 20°C (unless otherwise noted):**

I HOLD (A)**	I TRIP (A)	RESISTANCE (Ω)			TIME TO TRIP (s) @ 1A		OPERATING TEMPERATURE (°C)	
		R MIN	R MAX	R <sub>1 MAX</sub> *	TYP	MAX	MIN	MAX
0.130	0.300	9.0	12.0	22.0	1.0	3.0	-40	85

\* Maximum device resistance at 20°C measured 1 hour post trip.

\*\*Dependant on heat sinking.

Designed to assist equipment meet UL60950

Agency Recognitions: UL, CSA, TUV  
 Reference Documents: PS300  
 Precedence: This specification takes precedence over documents referenced herein.  
 Effectivity: Reference documents shall be the issue in effect on the date of invitation for bid.  
 CAUTION: Operation beyond the rated voltage or current may result in rupture, electrical arcing or flame.

**ROHS Compliant**



**ELV Compliant**



**Pb-Free**

