

查询"48116-000"供应商

PRODUCT NUMBER  
SEE SHEET 2

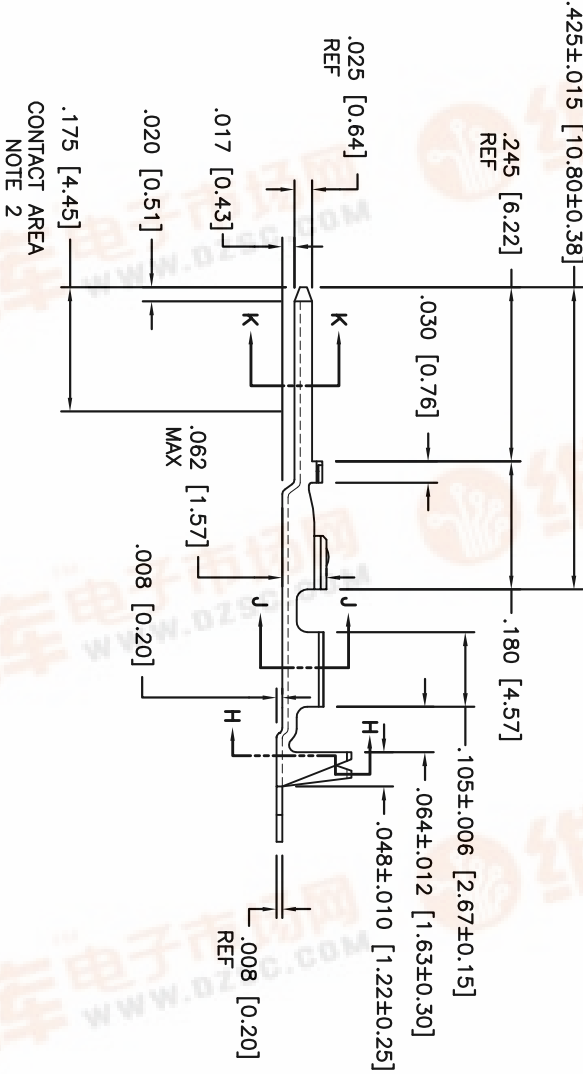
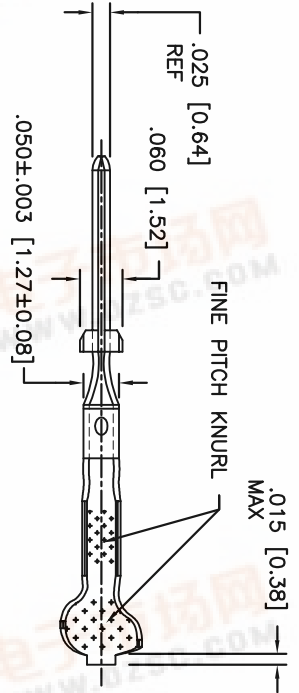

mat'l. code		NOTE 1		tolerances unless otherwise specified		CUSTOMER COPY		title	
ltr	ecn no	dr	dtde	xxx ±.01/.X±.3	xxx ±.005/.XXX±.13	projection	scale	product family	code
F	V41701	LSS	11/22/94	.XXX ±.005/.XXX±.13	.XXX ±.005/.XXX±.13	4:1	INCH/MM	C.T.W. MALE PIN	213
G	M05-0254	HTB	3/18/05	.XXX ±.0020/.XXX±.051	.XXX ±.0020/.XXX±.051	4:1	INCH/MM	LOOSE PIECE	1 of 2
sheet		revision	G	G	dr	L. SANDERS	11/28/94	product family	code
index		sheet	1	2	engr	T. HANNA	11/28/94	PV TERMINALS	213
					chr	T. BREWAKER	11/28/94	size	dwg no
					oppl	T. HANNA	11/28/94	1 of 2	48115

ACAD

1 2

3

4

code code  
22526

PDM: Rev:G

STATUS: Released

Printed: Mar 23, 2005





Tous droits strictement reserves. Reproduction ou communication a des tiers interdite sous quelque forme que ce soit sans autorisation ecrite du proprietaire. Propriete de c FCI. Droits de reproduction FCI.

All rights strictly reserved. Reproduction or issue to third parties in any form whatever is not permitted without written authority from the proprietor. Property of FCI. Copyright FCI.

PRODUCT NUMBER NOTE 5	AWG	DIM A	DIM B	DIM C	DIM D	DIM E	DIM F
48115-000	28-32	.054 [1.37]	.058 [1.47]	.011 [0.28]	.115 [2.92]	.105 [2.67]	.040 [1.02]
48115-000LF	28-32	.054 [1.37]	.058 [1.47]	.011 [0.28]	.115 [2.92]	.105 [2.67]	.040 [1.02]
48116-000	22-26	.070 [1.78]	.065 [1.65]	.017 [0.43]	.139 [3.53]	.120 [3.05]	.050 [1.27]
48116-000LF	22-26	.070 [1.78]	.065 [1.65]	.017 [0.43]	.139 [3.53]	.120 [3.05]	.050 [1.27]
48117-000	18-20	.104 [2.64]	.104 [2.64]	.021 [0.53]	.139 [3.53]	.120 [3.05]	.050 [1.27]
48117-000LF	18-20	.104 [2.64]	.104 [2.64]	.021 [0.53]	.139 [3.53]	.120 [3.05]	.050 [1.27]

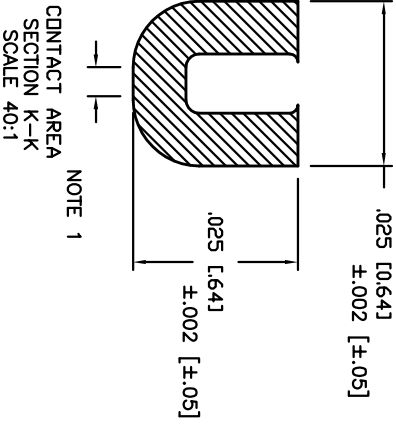
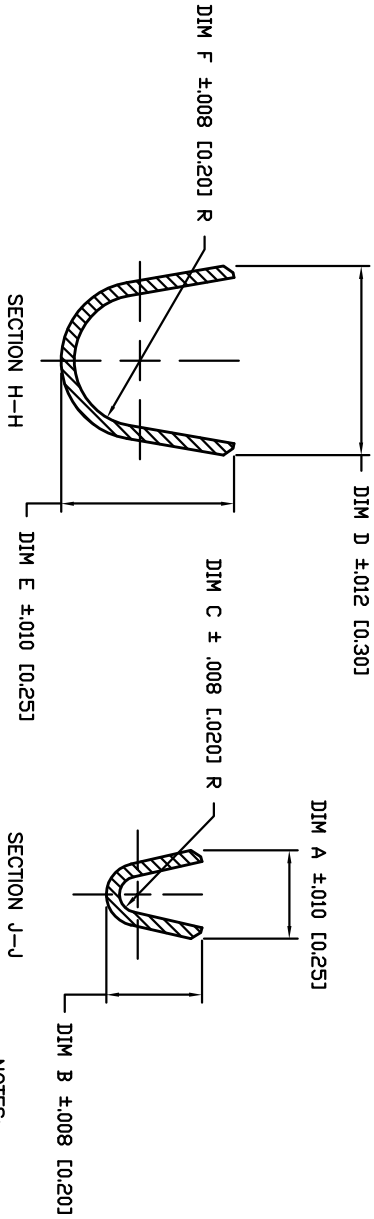

NOTES:

- MATERIAL: 3/4 HD. BRASS ALLOY 260.
- PLATING: ELECTRODEPOSITED GOLD 50u"/1.27u IN CONTACT AREA, REMAINDER GOLD FLASH. UNDERPLATE 50u"/1.27u NICKEL.
- TERMINAL MAY BE USED WITH MINI LATCH HOUSING.
- APPLICABLE SPECIFICATION:
  - A. BUS-12-098 PRODUCT SPECIFICATION.
  - B. TA-211 CRIMP SPECIFICATION.
- PART NUMBERS WITH AN LF SUFFIX MEET EUROPEAN UNION DIRECTIVES AND OTHER COUNTRY REGULATIONS AS DESCRIBED IN GS-22-008.
- THIS PRODUCT IS NOT INTENDED TO BE EXPOSED TO MANUFACTURING SOLDER PROCESSES.

mat'l. code	NOTE 1	tolerances unless otherwise specified	CUSTOMER COPY	title	code
ltr	ecr no	dr	date		
G					
linear		.xxx ±.005/.xxx±.13	projection	C.T.W. MALE PIN LOOSE PIECE	48115
angles		0° ±.2°	INCH/MM		
dr		L. SANDERS 11/28/94	scale	product family PV TERMINALS	size
engr		T. HANNA 11/28/94	10:1	product family PV TERMINALS	sheet
chr		T. BREWSTER 11/28/94		product family PV TERMINALS	2 of 2
oprd		T. HANNA 11/28/94		product family PV TERMINALS	
sheet	revision			code	
index	sheet			22526	

ACAD

查询"48116-000"供应商

PDM: Rev:G

STATUS: Released

Printed: Mar 23, 2005