

multimec® 3F+1N

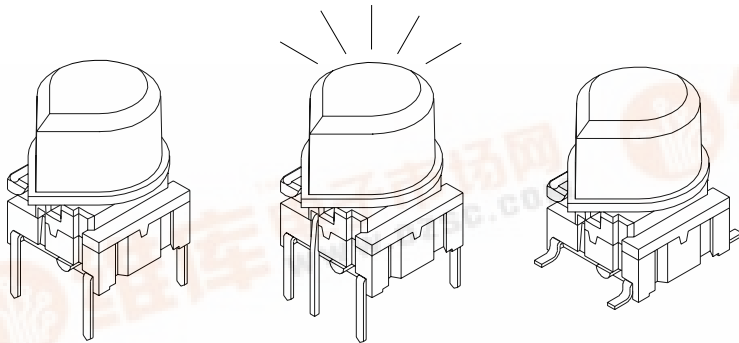

Technical Data:

- through-hole or SMD
- 50mA/24VDC
- single pole/momentary
- 10.000.000 operations life time
- IP67 sealing
- temperature range:
low temp: -40/+115°C
high temp: -40/+160°C

Dimensions (through-hole)

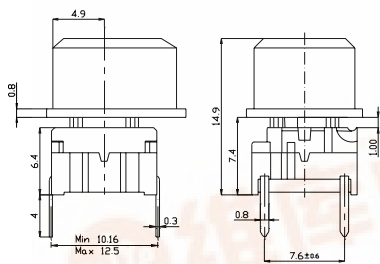

PCB layout

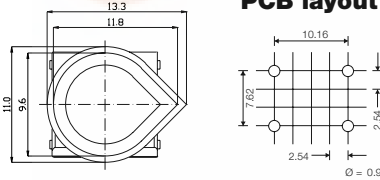

Dimensions (w/LED)

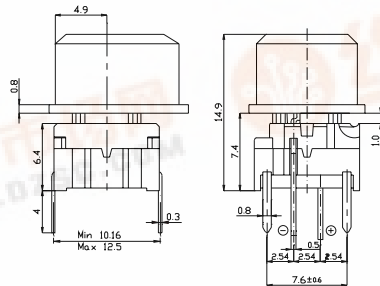

PCB layout (solder side)

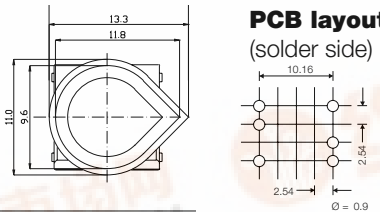

Dimensions (SMD)

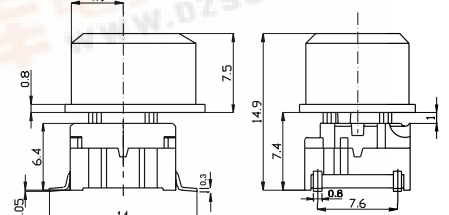

PCB layout

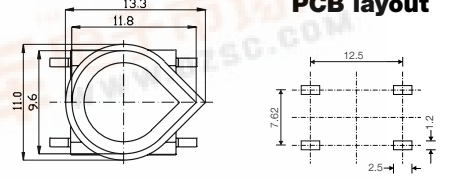

8 different position options

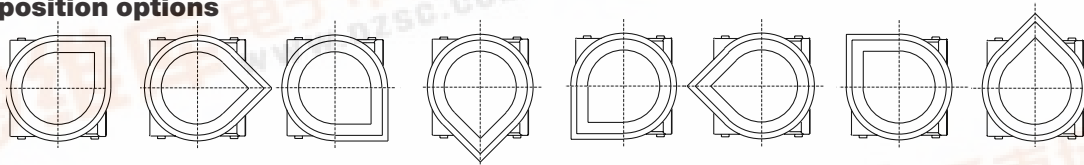

HOW TO ORDER

3 F	<input type="checkbox"/>	<input type="checkbox"/>	+	<input type="checkbox"/>	<input type="checkbox"/>
Switch	Mounting	L 6 low temp. H 9 high temp.		Cap	00 blue 03 grey 04 yellow 08 red 09 black custom colours on request
	T through-hole S surface mount			1N	

Standard versions:
3FTL6, 3FTH9, 3FSH9

3 F	<input type="checkbox"/>	<input type="checkbox"/>	+	<input type="checkbox"/>	<input type="checkbox"/>
Switch	Mounting	L 6 low temp. H 9 high temp.		Cap	10 transparent blue 12 transparent green 14 transparent yellow 16 transparent white 18 transparent red
	T through-hole			1N	

LED
00 blue
20 green
40 yellow
80 red
2040 green/yellow
8020 red/green
8040 red/yellow

Standard versions:
3FTL600, 3FTL620, 3FTL640, 3FTL680
3FTL62040, 3FTL68020, 3FTL68040

Combinations of high temperature switches with LEDs will be limited by the temperature capability of the LED.

Ordering example: 3FTL6 +1N09 or 3FTL680 +1N18

