

1. Test conditions

| | | |
|------------------------------------|----|-----|
| RF power | 0 | dBm |
| Room Temperature | 25 | °C |
| Terminating source impedance (ZS): | 50 | |
| Terminating load impedance (ZL): | 50 | |

2. Specifications

| | Minimum | Typical | Maximum | Unit |
|--|---------|---------|---------|--------|
| Centre frequency | | 452.4 | | MHz |
| Pass Band | 450 | | 454.8 | MHz |
| Insertion Loss in Pass Band | | 2.0 | 2.8 | dB |
| VSWR in Pass Band | | 1.2:1 | 1.4:1 | |
| Absolute Rejection 0.3 MHz – 440MHz | 30 | 32 | | dB |
| RX Rejection 460 MHz – 464.8 MHz | 35 | 45 | | dB |
| 460 MHz – 464.8 MHz *) | 40 | 45 | | dB |
| Rejection 900 MHz Cellular 464.8 MHz – 1565 MHz | 30 | 34 | | dB |
| Rejection GPS Band 1565 MHz – 1585 MHz | 30 | 37 | | dB |
| Rejection PCS DCS UMTS 1585 MHz – 1800 MHz | 30 | 37 | | dB |
| Operating temperature range | -30 | | +85 | °C |
| Temperature coefficient of frequency | | -30 | | ppm/°C |
| Maximum Power | | | 27 | dBm |

*) Temperature Range: -10 ... +60°C

3. Matching Network

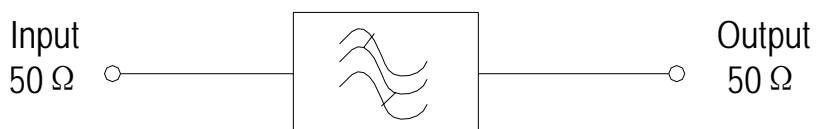

| | | | | |
|--|---|-------------|------------|------|
|  | SIPAT Co., Ltd. (CETC No. 26 Research Institute) Nanping Huayuan Road No. 14 Chongqing, China, 400060 | Part Number | SF453A | |
| | | Rev. Date | 2005-12-15 | |
| | | Rev. | PR6.0 | Page |

4. Package Dimension

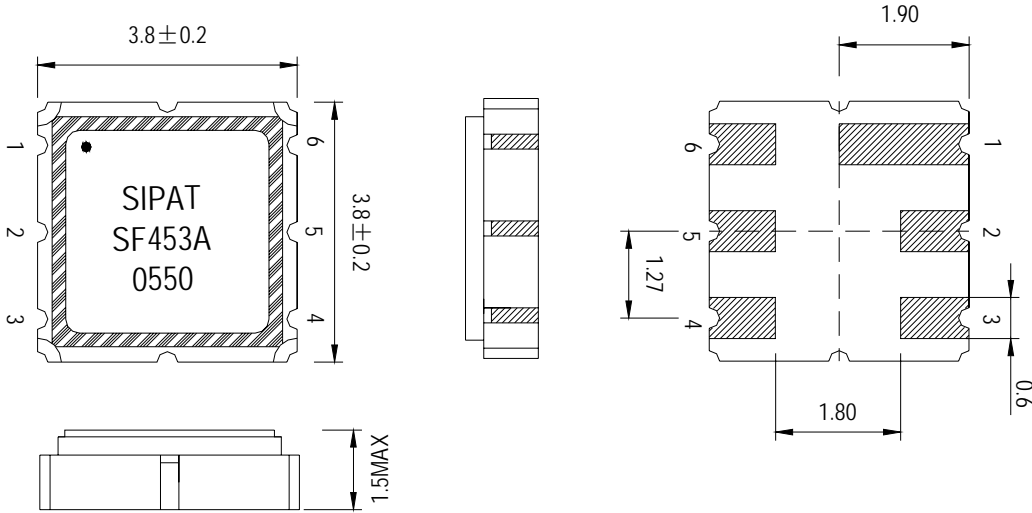

| Pin No. | Function |
|---------|----------|
| 2. | Input |
| 5. | Output |
| Other | Ground |

*Dimensions shown are nominal in millimeters

Body : Al₂O₃ Ceramic / Lid : Kovar, Ni Plated

Terminations : Au plating 0.3 ~ 1.0 um, Over a 1.27 ~ 8.89 um

Ni Plating

5. Marking Configuration

- 1) *
- 2) SIPAT
- 3) SF453A
- 4) 0550

- 1) Pad Number 1 Index
- 2) Manufacturer name
- 3) Part Number
- 4) Date Code

| | | | |
|--|---|-------------|------------|
|  | SIPAT Co., Ltd. (CETC No. 26 Research Institute) Nanping Huayuan Road No. 14 Chongqing, China, 400060 | Part Number | SF453A |
| | | Rev. Date | 2005-12-15 |
| | | Rev. | PR6.0 |

6. Typical performance

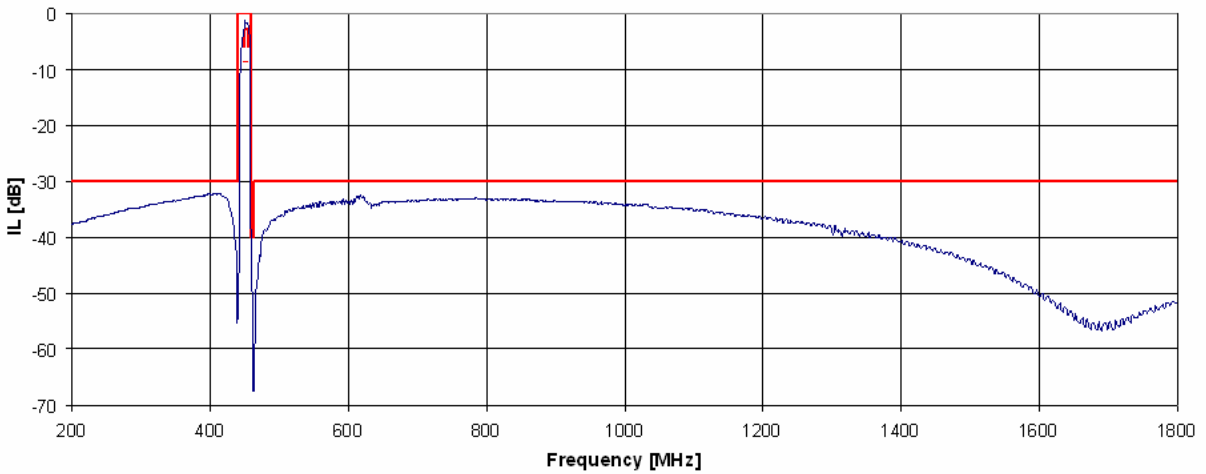
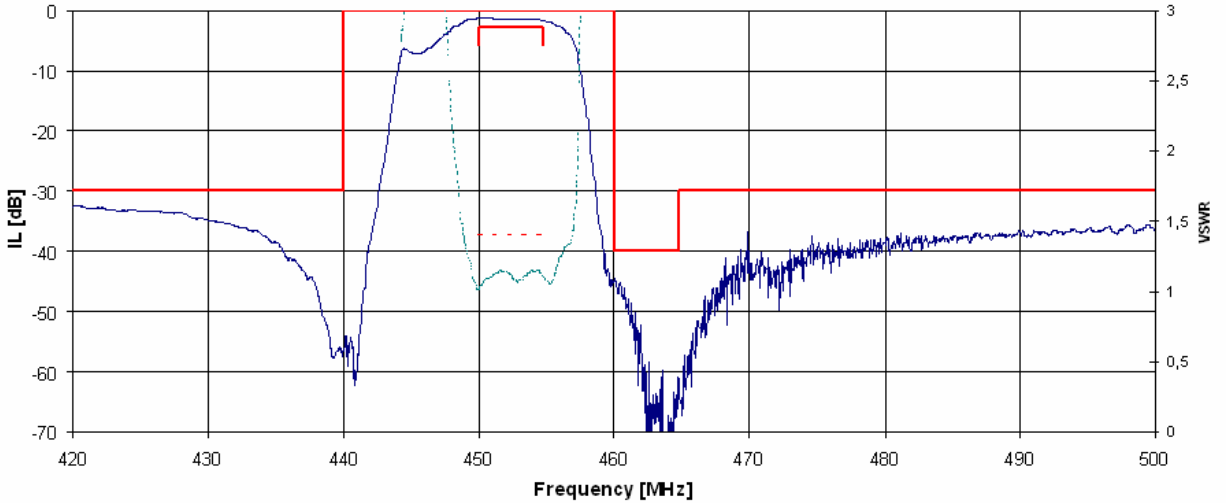

| | | | | |
|--|---|-------------|------------|----------|
|  | SIPAT Co., Ltd. (CETC No. 26 Research Institute) Nanping Huayuan Road No. 14 Chongqing, China, 400060 | Part Number | SF453A | |
| | | Rev. Date | 2005-12-15 | |
| | | Rev. | PR6.0 | Page 3/6 |

7. Packing

1. Reeling Quantity : 3000 pcs / 13" reel (or 1000 pcs / 7" reel)
2. Taping Structure : The tape shall be wound around the reel in the direction shown below.

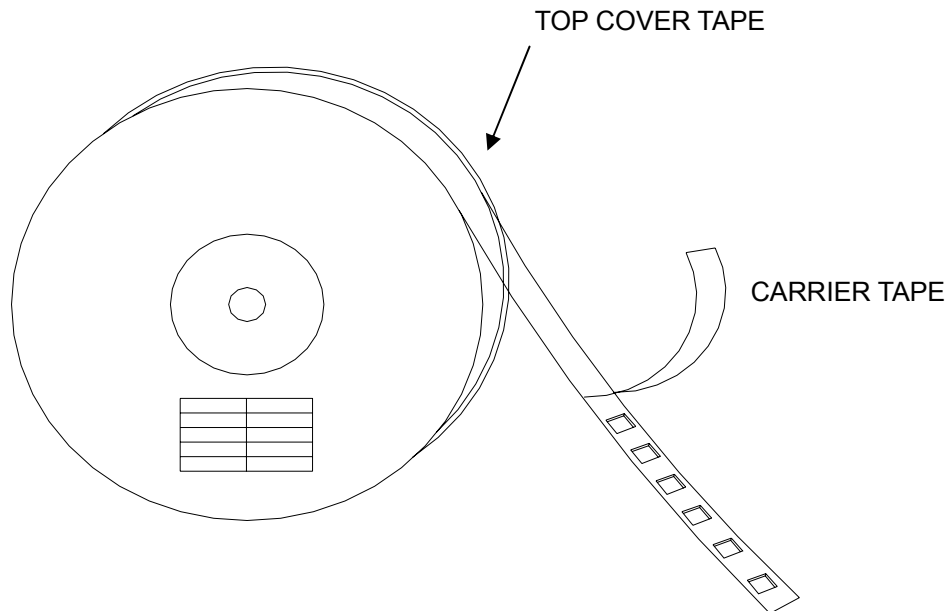
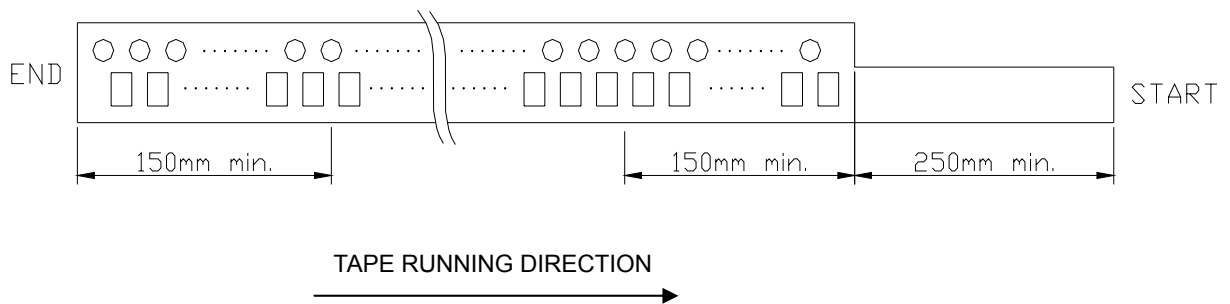

| | | | | |
|--|---|-------------|------------|----------|
|  | SIPAT Co., Ltd. (CETC No. 26 Research Institute) Nanping Huayuan Road No. 14 Chongqing, China, 400060 | Part Number | SF453A | |
| | | Rev. Date | 2005-12-15 | |
| | | Rev. | PR6.0 | Page 4/6 |

3. Top Cover Tape Adhesion (See the below figure)

- (1) pull off angle: 0~15°
- (2) speed: 300mm/min.
- (3) force: 20~70g

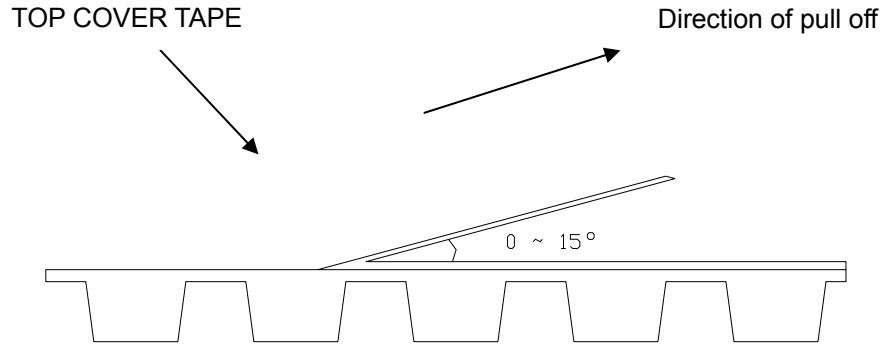

[Unit: mm]

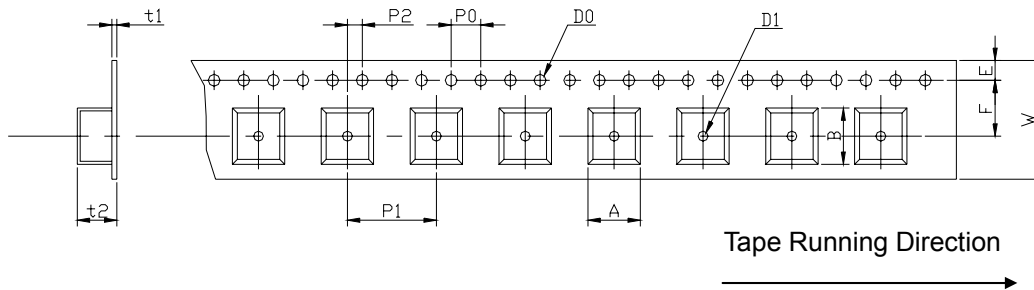

| W | F | E | P0 | P1 | P2 | D0 | D1 | t1 | t2 | A | B |
|------|------|------|------|------|------|------|-------|------|------|------|------|
| 12.0 | 5.5 | 1.75 | 4.0 | 8.0 | 2.0 | Φ1.5 | Φ1.5 | 0.31 | 1.95 | 4.1 | 4.1 |
| ±0.3 | ±0.1 | ±0.1 | ±0.2 | ±0.1 | ±0.2 | ±0.1 | ±0.25 | max. | max. | max. | max. |

| | | | | |
|--|---|-------------|------------|----------|
|  | SIPAT Co., Ltd. (CETC No. 26 Research Institute) Nanping Huayuan Road No. 14 Chongqing, China, 400060 | Part Number | SF453A | |
| | | Rev. Date | 2005-12-15 | |
| | | Rev. | PR6.0 | Page 5/6 |

4.Reel Dimensions

[Unit: mm]

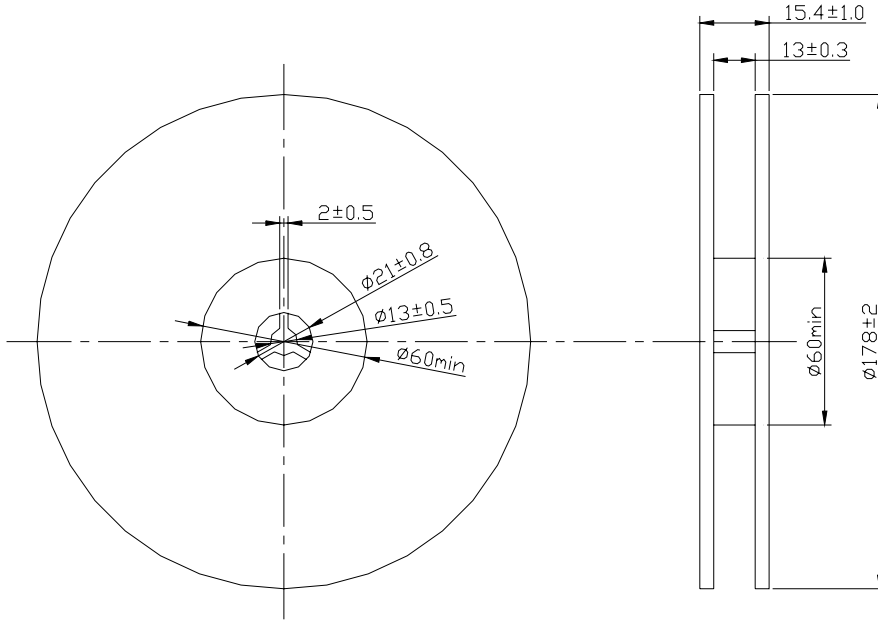

5. Part Direction

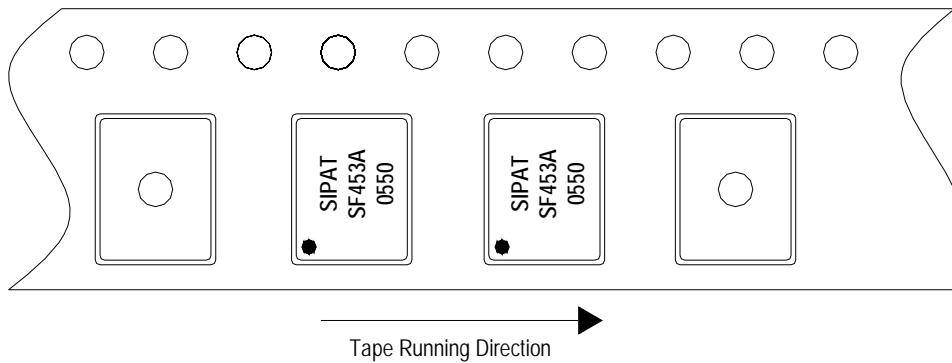

| | | | | |
|--|---|-------------|------------|------|
|  | SIPAT Co., Ltd. (CETC No. 26 Research Institute) Nanping Huayuan Road No. 14 Chongqing, China, 400060 | Part Number | SF453A | |
| | | Rev. Date | 2005-12-15 | |
| | | Rev. | PR6.0 | Page |