

# RB521G-30G

[查询"RB521G-30G"供应商](#)

## Silicon Epitaxial Planar Schottky Barrier Diode

for rectifying small power application

### PINNING

PIN	DESCRIPTION
1	Cathode
2	Anode

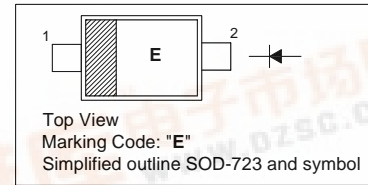

### Absolute Maximum Ratings ( $T_a = 25^\circ\text{C}$ )

Parameter	Symbol	Value	Unit
Reverse Voltage	$V_R$	30	V
Average Rectified Forward Current	$I_O$	100	mA
Peak Forward Surge Current (60 Hz for 1 cyc.)	$I_{FSM}$	1	A
Junction Temperature	$T_j$	125	$^\circ\text{C}$
Storage Temperature Range	$T_{stg}$	- 40 to + 125	$^\circ\text{C}$

### Characteristics at $T_a = 25^\circ\text{C}$

Parameter	Symbol	Max.	Unit
Forward Voltage at $I_F = 10\text{ mA}$	$V_F$	0.35	V
Reverse Current at $V_R = 10\text{ V}$	$I_R$	10	$\mu\text{A}$

Note: Please pay attention to static electricity when handling.

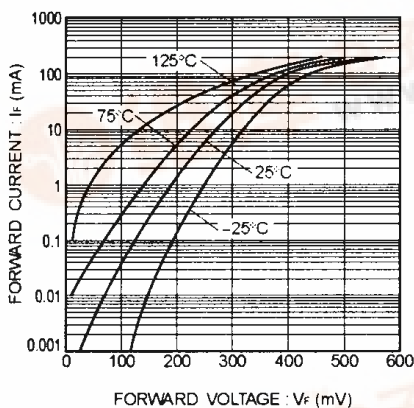

Fig.1 Forward characteristics

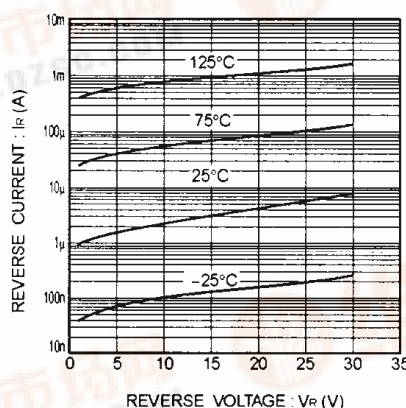

Fig.2 Reverse characteristics

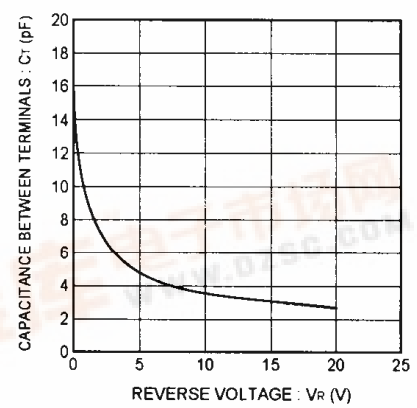

Fig.3 Capacitance between terminals characteristics

## SEMTECH ELECTRONICS LTD.

(Subsidiary of Sino-Tech International Holdings Limited, a company listed on the Hong Kong Stock Exchange, Stock Code: 724)



# RB521G-30G

[查询"RB521G-30G"供应商](#)

## PACKAGE OUTLINE

Plastic surface mounted package; 2 leads

SOD-723

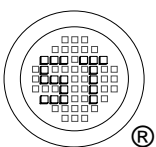
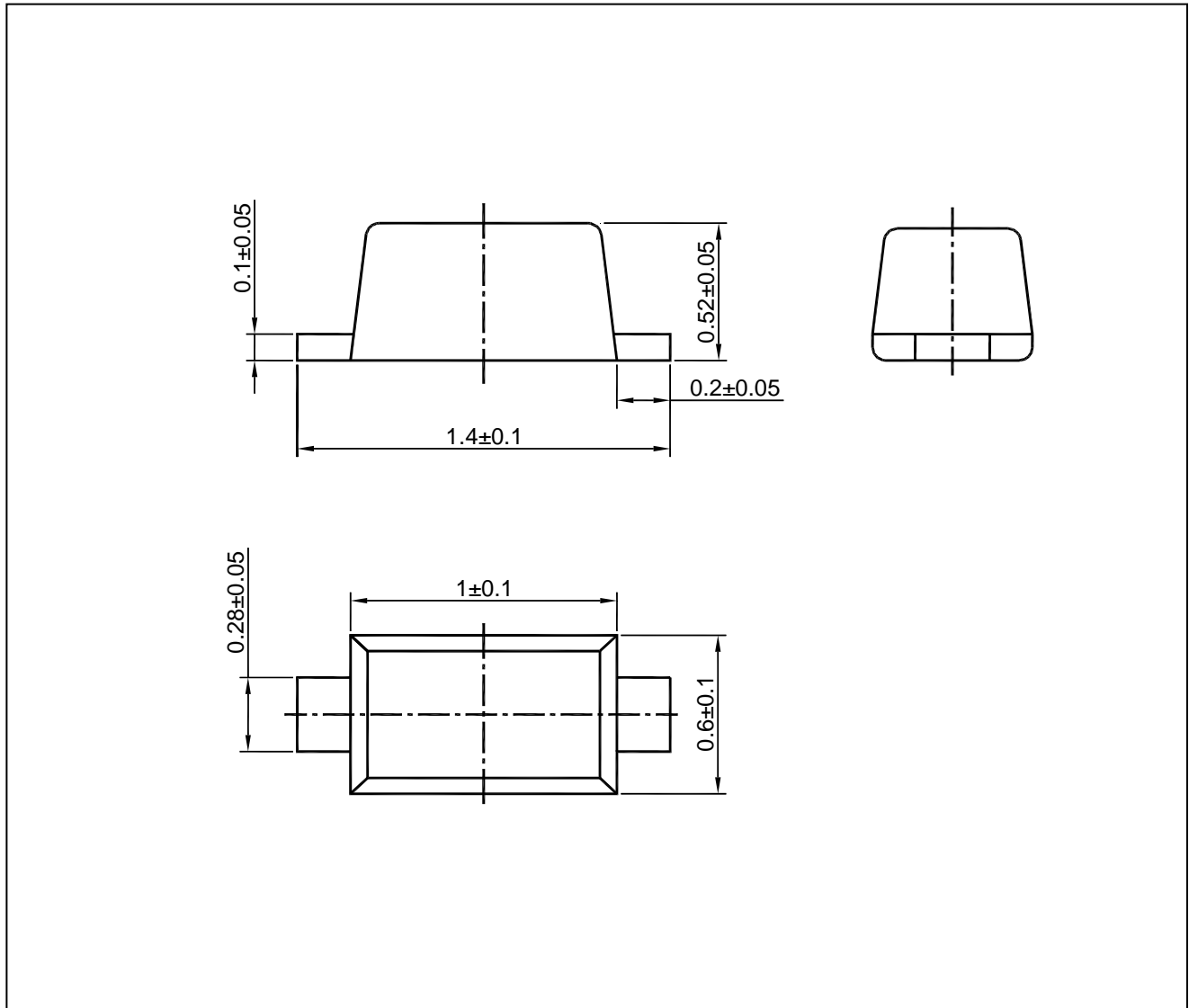

**SEMTECH ELECTRONICS LTD.**  
(Subsidiary of Sino-Tech International Holdings Limited, a company listed on the Hong Kong Stock Exchange, Stock Code: 724)



ISO/TS 16949 : 2002  
Certificate No. 05103

ISO14001 : 2004  
Certificate No. 7116

ISO 9001 : 2008  
Certificate No. 0506098

BS-OHSAS 18001 : 2007  
Certificate No. 7116

IECQ QC 080000  
Certificate No. P16-0296-1051

Dated : 28/07/2010 Rev:01