

#### ADC-007

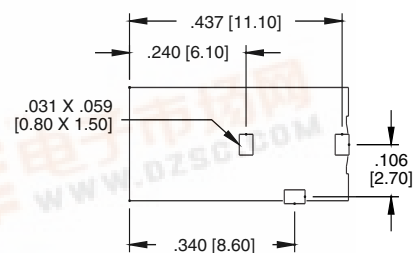

ADC-007-3

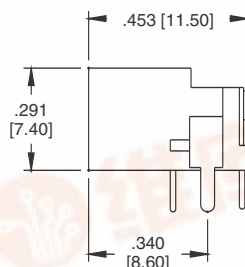
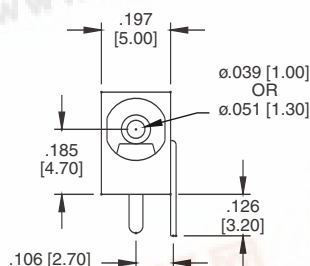

Recommended PCB Layout

#### ADC-009



ADC-009-3

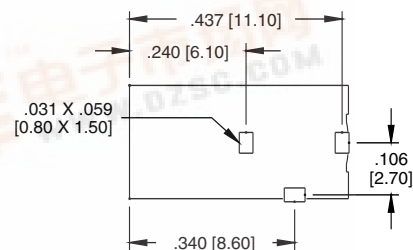
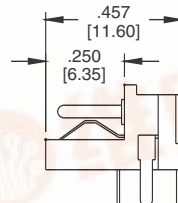
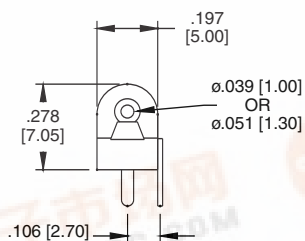

Recommended PCB Layout

#### ADC-011

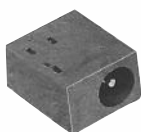

ADC-011-3

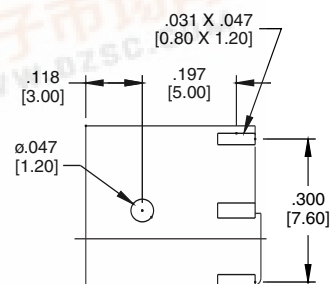
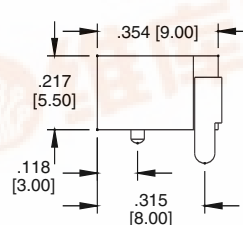
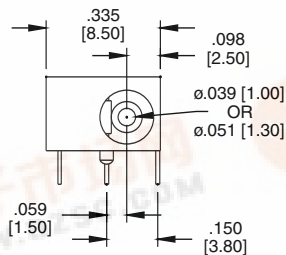

Recommended PCB Layout

#### ADC-021

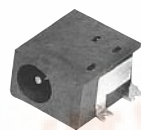

ADC-021-3

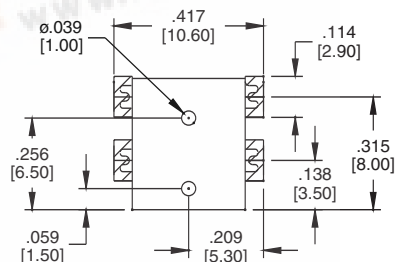
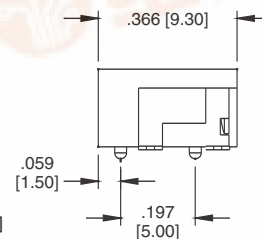
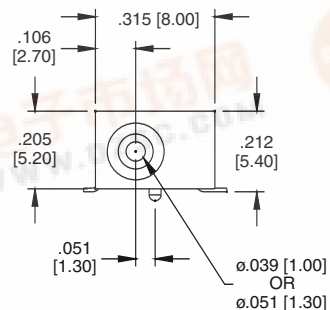

Recommended PCB Layout

#### ADC-029



ADC-029-1

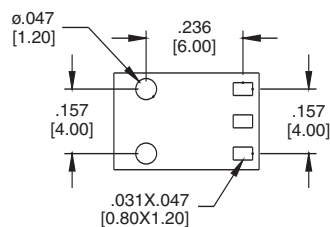
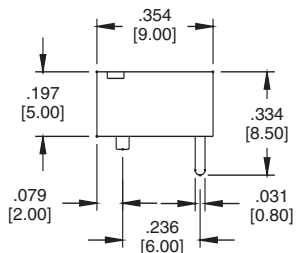
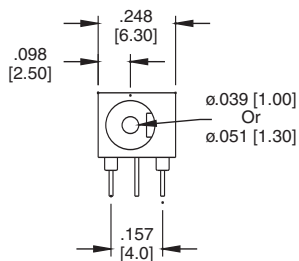

Recommended PCB Layout

#### ADC-002



ADC-002-2

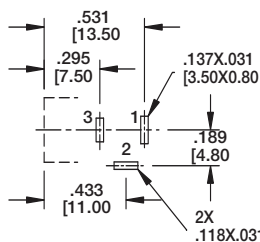
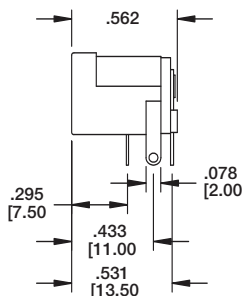
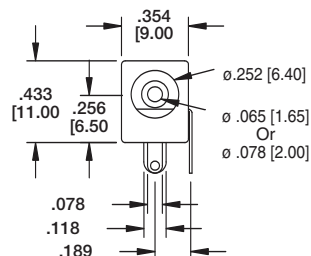

Recommended PCB Layout

#### ADC-024



ADC-024-8

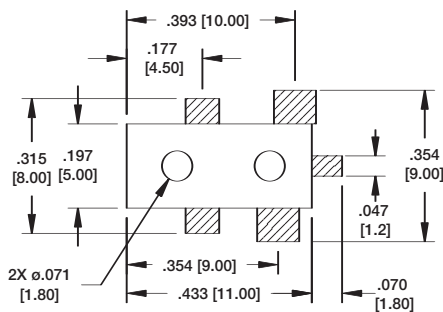
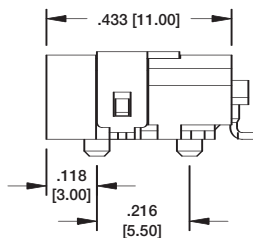
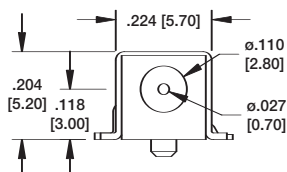

Recommended PCB Layout

#### ADC-028



ADC-028-2

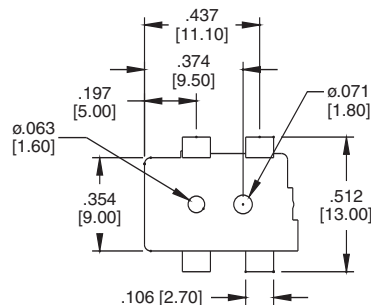
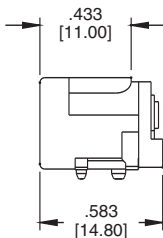
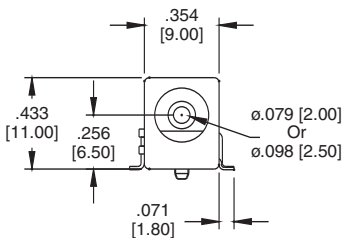

Recommended PCB Layout

#### ADC-010



ADC-010-1

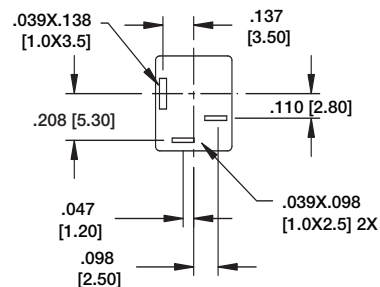
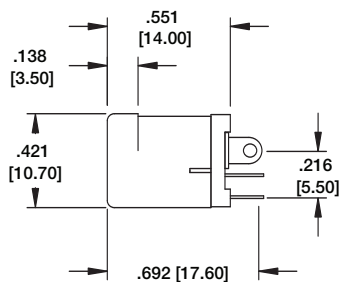
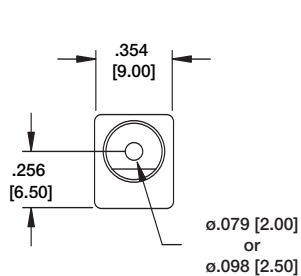

Recommended PCB Layout

#### ADC-015



ADC-015-2

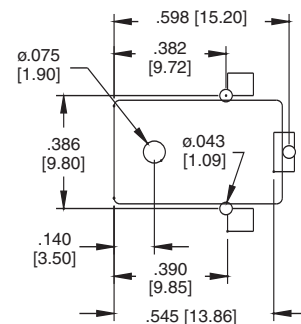
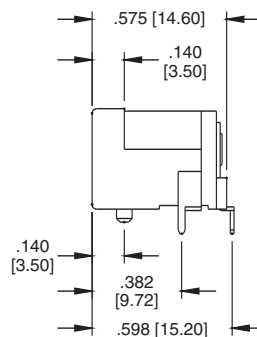
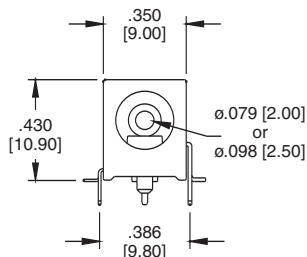

Recommended PCB Layout

#### ADC-045A



ADC-045A-1

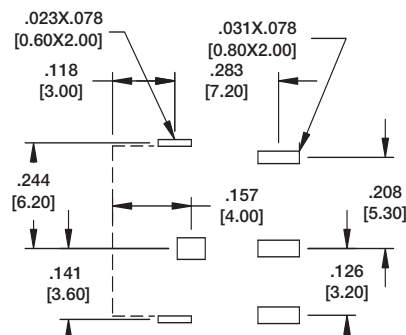
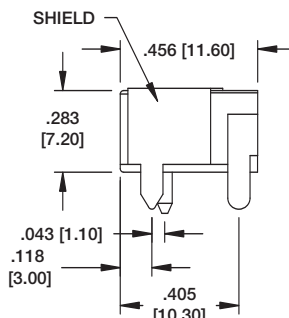
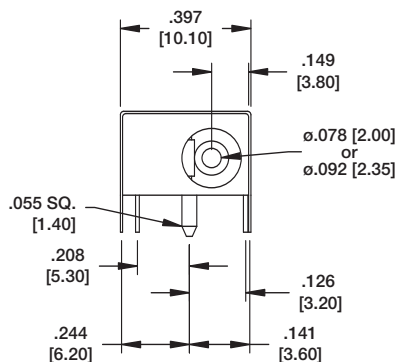

Recommended PCB Layout

#### DC POWER PLUG WITH STRAIN RELIEF

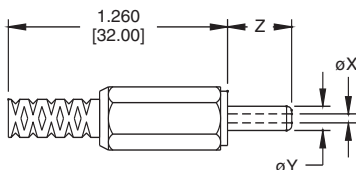

#### DC POWER PLUG WITHOUT STRAIN RELIEF

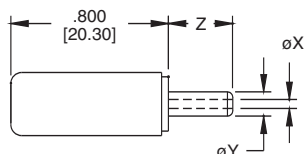

| PLUG WITH STRAIN RELIEF | X            | Y            | Z           |
|-------------------------|--------------|--------------|-------------|
| ADP-X/Y/Z-SR            | ø.039 [1.00] | ø.137 [3.50] | .374 [9.50] |
| ADP-X/Y/Z-SR            | ø.082 [2.10] | ø.216 [5.50] | .374 [9.50] |
| ADP-X/Y/Z-SR            | ø.098 [2.50] | ø.216 [5.50] | .374 [9.50] |

| PLUG WITHOUT STRAIN RELIEF | X            | Y            | Z           |
|----------------------------|--------------|--------------|-------------|
| ADP-X/Y/Z                  | ø.039 [1.00] | ø.137 [3.50] | .374 [9.50] |
| ADP-X/Y/Z                  | ø.082 [2.10] | ø.216 [5.50] | .374 [9.50] |
| ADP-X/Y/Z                  | ø.098 [2.50] | ø.216 [5.50] | .374 [9.50] |