

593-280

DRAWING MADE IN THIS ANGLE PROJECTION  
THIS DRAWING IS UNPUBLISHED. RELEASED FOR PUBLICATION  
© COMPANY IS BY AMP INCORPORATED. ALL INTERNATIONAL RIGHTS RESERVED. 19

CLAMPING INSERT

(2) SELF-TAPPING SCREWS  
SOLID OR SLOTTED SHANK  
MATERIAL: ZINC PLATED STEEL  
LENGTH: SEE TABLE

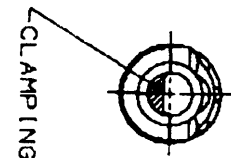
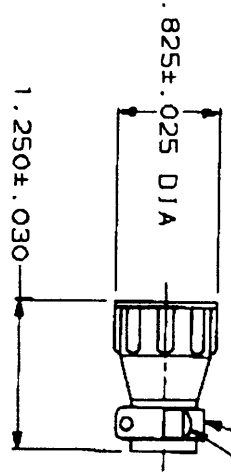

CLAMPING AREA SHADED

REV	DATE	APPRO	DESCRIPTION
1	4/23/91		REORAWN
2	10/16/92	KB	REV PER ECN B06815
3	01/14/93	KB	ADDED -8 AND -9 PER NPR 4477
4	07/07/93	AF	ADDED 1--0 PER NPR 4832
5		TM	OBSELETED -8 & -9 PER EC 0020-559-96

AMP BRAZIL USE ONLY	SMALL PACK
INDIVIDUAL	.375
INDIVIDUAL	12mm
INDIVIDUAL	10mm
BULK	.500
INDIVIDUAL	.500
BULK	.375
INDIVIDUAL	.375

PACKAGING	SCREW LENGTH	SCREW TYPE	PART NUMBER
INDIVIDUAL	.375	#5-20	1-206062-0
INDIVIDUAL	12mm	3mm-20	206062-9
INDIVIDUAL	10mm	3mm-20	206062-8
BULK	.500	#5-20	206062-4
INDIVIDUAL	.500	#5-20	206062-3
BULK	.375	#5-20	206062-2
INDIVIDUAL	.375	#5-20	206062-1

1. PARTS PACKAGED UNASSEMBLED.
2. CABLE CLAMPING AREA ADJUSTABLE FROM .004 TO .055 SQ IN BY REVERSING CLAMPING INSERTS.
3. 329 MAXIMUM CABLE OUTSIDE DIAMETER.
4. BULK PACKAGED KITS TO BE ORDERED IN MULTIPLES OF 400 ONLY.
5. OBSOLETE PART NUMBER.

182658-1 供应商

DO NOT SCALE PRINT. DIMENSIONS SHOWN IN INCHES UNLESS OTHERWISE SPECIFIED. TOLERANCES ON DIMENSIONS: .005 DEC 1; .002 DEC 2; .001 DEC 3.

DATE: 4/23/91  
BY: V. J. LEBLANC  
APP'D: E. BLANK  
MATERIAL: THERMOPLASTIC, BLACK

AMP Incorporated  
Harrisburg, PA 17105-3608

CABLE CLAMP KIT, STANDARD,  
SHELL SIZE 11, CPC

SIZE: 00779  
CASE CODE: 206062

CUSTOMER DRAWING