

[查询"SKM214A"供应商](#)

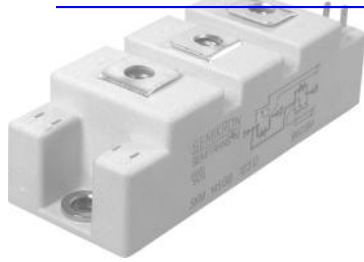

SEMITRANS™ 2

Power MOSFET Modules

SKM 214 A

Features

- N Channel, enhancement mode
- Avalanche characteristic
- Short internal connections avoid oscillations
- Isolated copper baseplate
- All electrical connections on top for easy busbaring
- Large clearances (10 mm) and creepage distances (20 mm)
- UL recognized, file no. E 63 532

Typical Applications

- Switched mode power supplies
- DC servo and robot drives
- DC choppers
- UPS equipment
- Not suitable for linear amplification

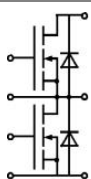

MB

Absolute Maximum Ratings		$T_c = 25\text{ }^\circ\text{C}$, unless otherwise specified	
Symbol	Conditions	Values	Units
V_{DS}		100	V
I_D	$T_s = 25\text{ (80) }^\circ\text{C}$	125 (95)	A
I_{DM}	1 ms	375	A
V_{GS}		± 20	V
T_{vj} (T_{stg})		- 40 ... +150 (125)	$^\circ\text{C}$
V_{isol}	AC, 1 min.	2500	V
Inverse diode			
$I_F = -I_S$		125	A
$I_{FM} = -I_{SM}$		375	A

Characteristics		$T_c = 25\text{ }^\circ\text{C}$, unless otherwise specified			
Symbol	Conditions	min.	typ.	max.	Units
$V_{(BR)DSS}$	$V_{GS} = 0\text{ V}$, $I_D = 0,25\text{ mA}$	100			V
$V_{GS(th)}$	$V_{GS} = V_{DS}$, $I_D = 1\text{ mA}$	2,1	3	4	V
I_{DSS}	$V_{GS} = 0\text{ V}$, $V_{DS} = 100\text{ V}$, $T_j = 25\text{ (125) }^\circ\text{C}$		50 (300)	250 (1000)	μA
I_{GSS}	$V_{GS} = 20\text{ V}$, $V_{DS} = 0\text{ V}$		10	100	nA
$R_{DS(on)}$	$V_{GS} = 10\text{ V}$, $I_D = 78\text{ A}$		10	13	m Ω
g_{fs}	$V_{DS} = 25\text{ V}$, $I_D = 78\text{ A}$	40	60		S
C_{CHC}	$V_{GS} = 0$, $V_{DS} = 25\text{ V}$, $f = 1\text{ MHz}$			100	pF
C_{iss}			9	12	nF
C_{oss}			4	6	nF
C_{rss}			1,6	2,4	nF
L_{DS}				20	nH
$t_{d(on)}$	$V_{DD} = 50\text{ V}$, $I_D = 78\text{ A}$,		50		ns
t_r	$V_{GS} = 10\text{ V}$, $R_G = 3,3\text{ }\Omega$		190		ns
$t_{d(off)}$			190		ns
t_f			50		ns
Inverse diode					
V_{SD}	$I_F = 250\text{ A}$; $V_{GS} = 0\text{ V}$		1,25	1,6	V
t_{rr}	$T_j = 25\text{ (150) }^\circ\text{C}$		320		ns
Q_{rr}	$T_j = 25\text{ }^\circ\text{C}$		3,6		μC
I_{rr}	$T_j = 150\text{ }^\circ\text{C}$				A
Thermal characteristics					
$R_{th(j-c)}$	per MOSFET		0,31		K/W
$R_{th(c-s)}$	M_s , surface, per module		0,07		K/W
Mechanical data					
M_s	to heatsink (M6)	4		5	Nm
M_t	for terminals (M5)	2,5		3,5	Nm
w		160			g

查询"SKM214A"供应高

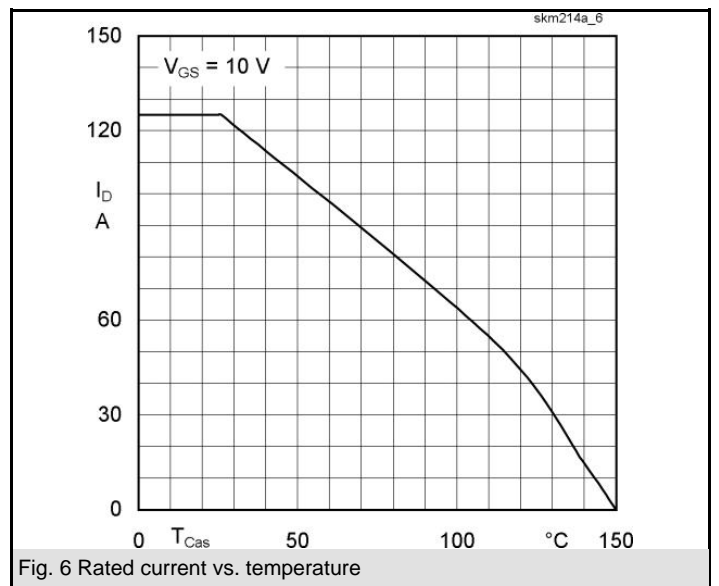
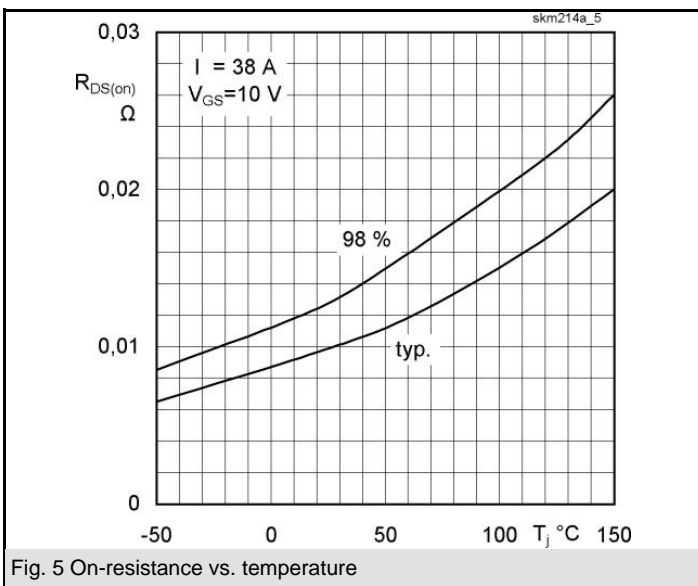
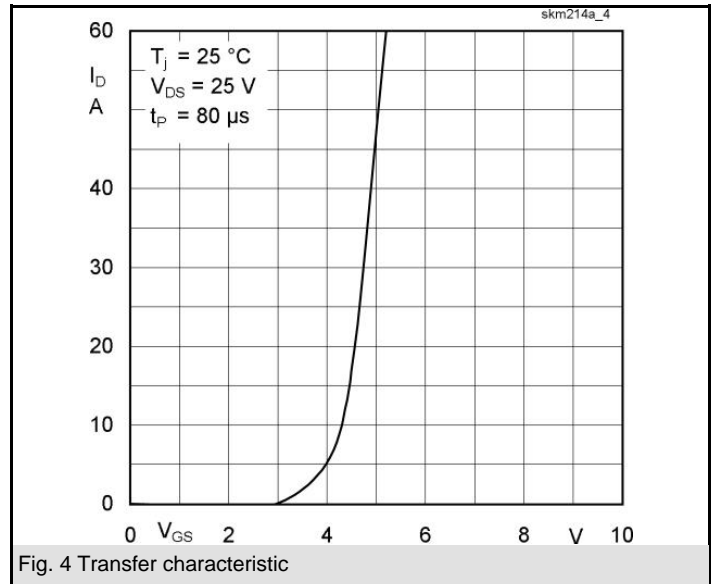
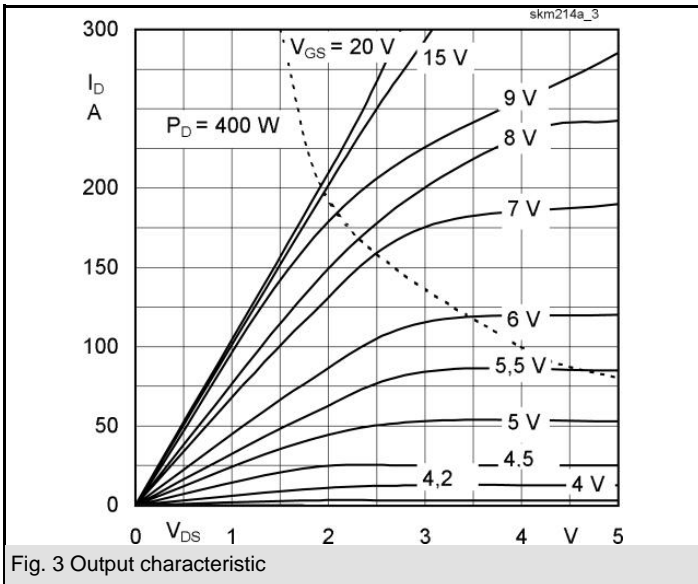
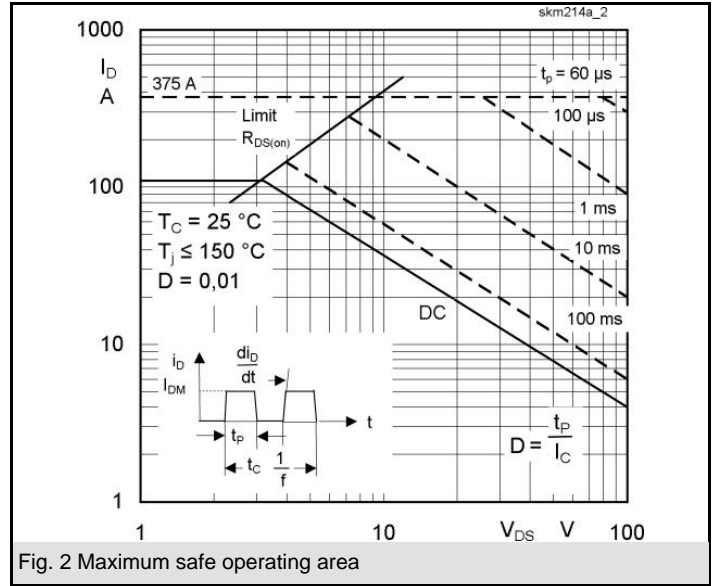
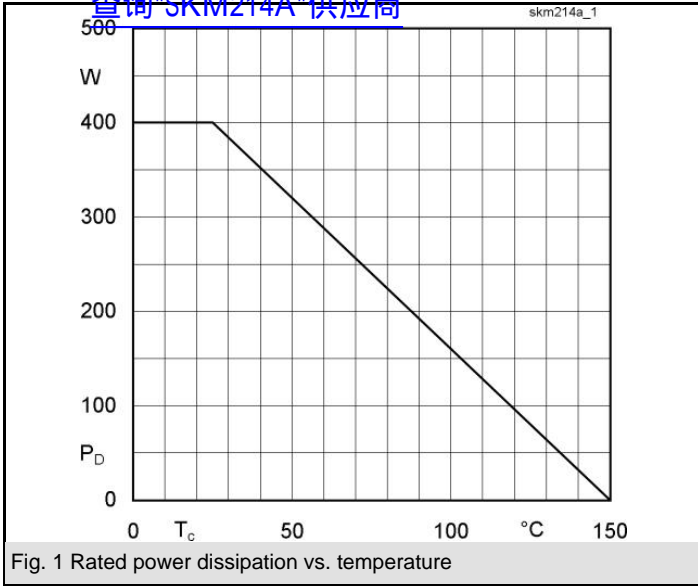

查询"SKM214A"供应商

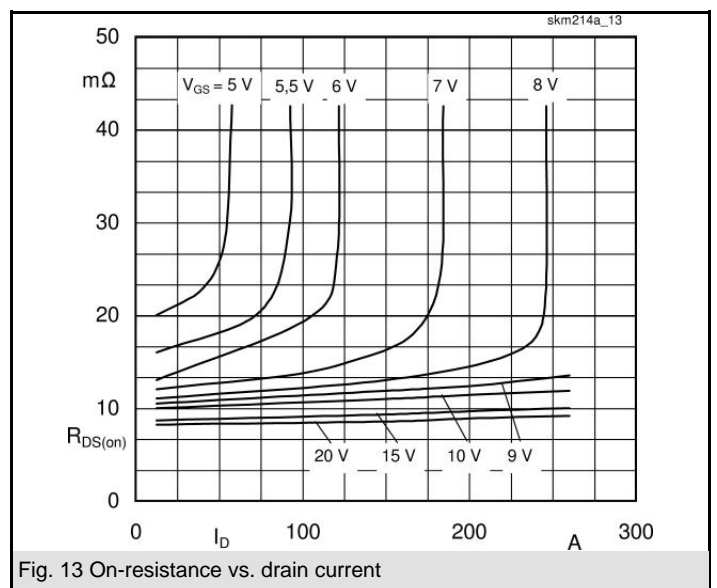
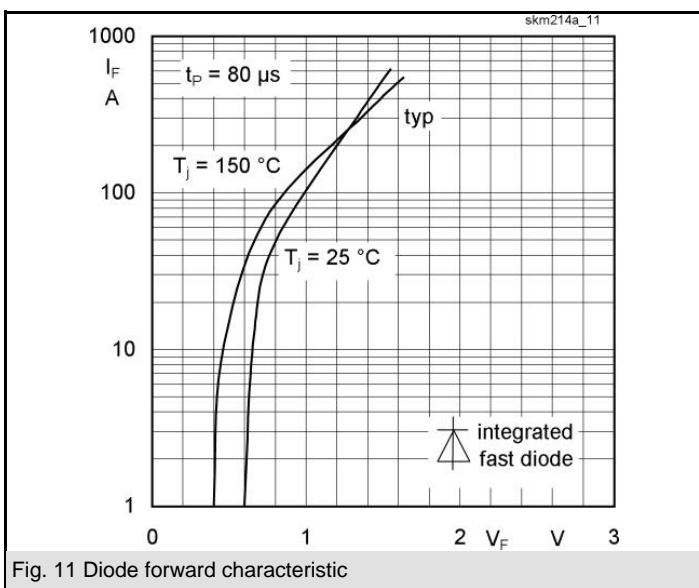
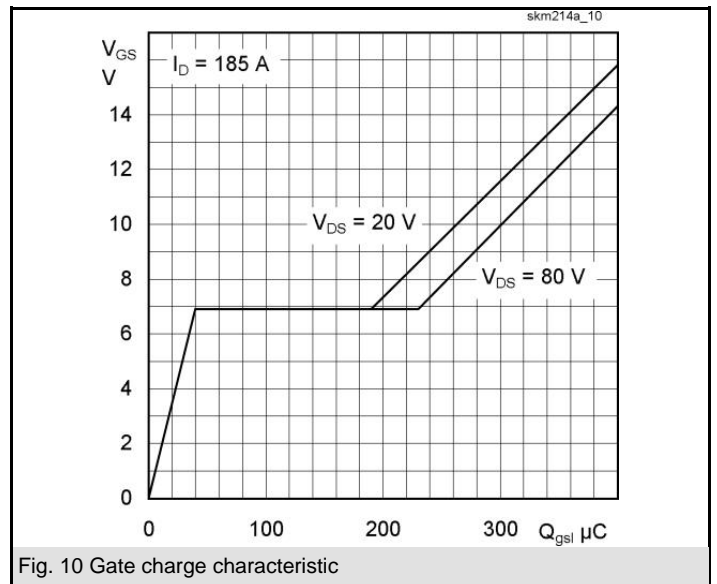
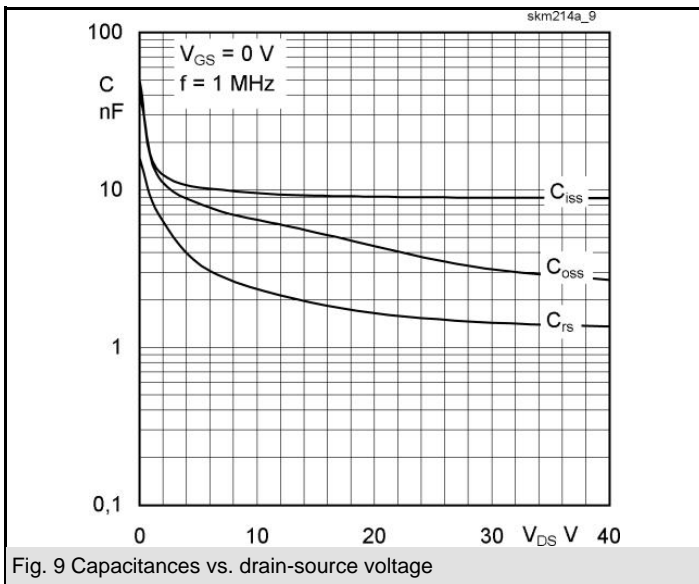
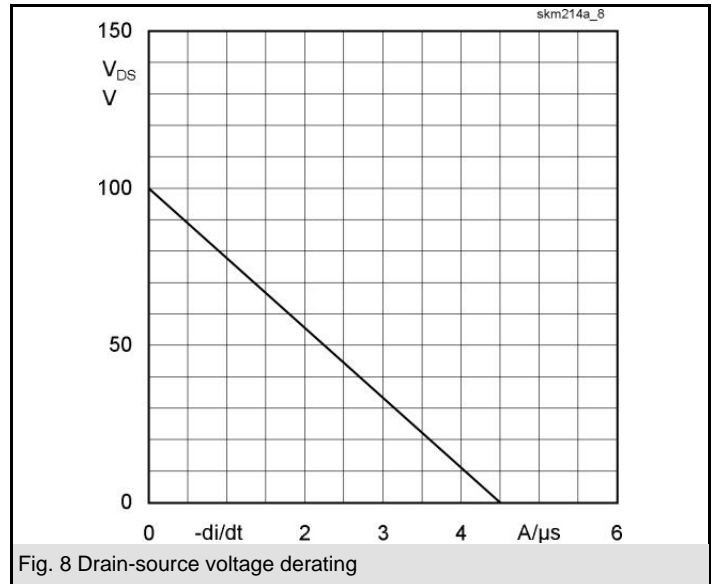
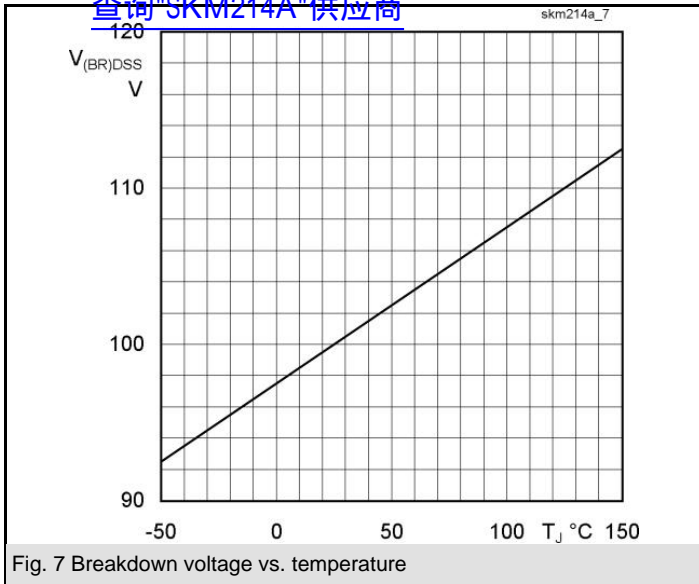

SKM 214A

UL Recognized File no. E-63-532 [查询"SKM214A"供应商](#)

Dimensions in mm

CASED70

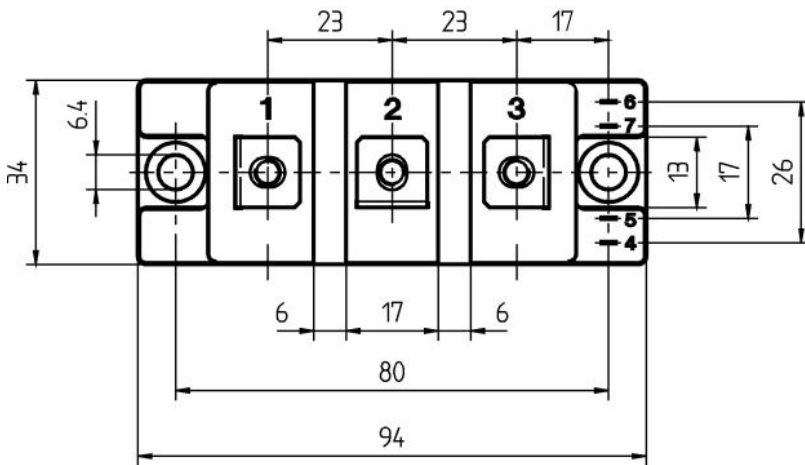
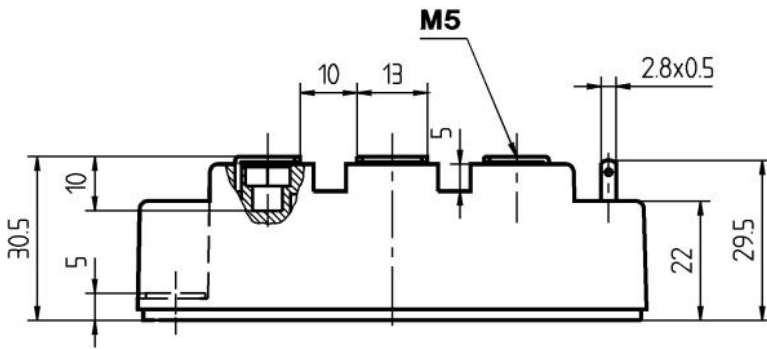

Case D 70

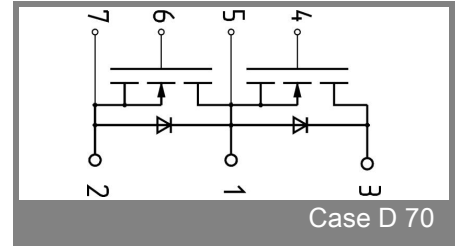

Case D 70

This is an electrostatic discharge sensitive device (ESDS), international standard IEC 60747-1, Chapter IX.

This technical information specifies semiconductor devices but promises no characteristics. No warranty or guarantee expressed or implied is made regarding delivery, performance or suitability.