

LOW VOLTAGE
[查询 29705 供应商](#)

MINI® Fuse Fast-Acting Type

The MINI® Fuse is smaller than its predecessor, the ATO® or AUTOFUSE® fuses, which permit more fuses in the same amount of space. More fuses in the same space satisfy the requirement that more circuits be individually fused in newer automobiles.

ELECTRICAL CHARACTERISTICS:

% of Ampere Rating	Opening Time
110%	100 Hours Minimum
135%	.75 sec., Min. ; 1800 sec. Max.
200%	.015 sec., Min. ; 5 sec., Max.
350%	.080 sec., Min. ; .250 sec., Max.
600%	.030 sec., Min. ; .100 sec., Max.

AGENCY APPROVALS: Listed by Underwriters Laboratories.

PHYSICAL SPECIFICATIONS:

Materials: Body: Plastic
 Terminations: Silver Plated

PATENTED

ORDERING INFORMATION:

Catalog Number	Ampere Rating	Voltage Rating	Color Code	Nominal Resistance Cold Ohms	Nominal Melting I ² t A ² Sec.
297 002	2	32	Grey	0.056	2.8
297 003	3	32	Violet	0.034	9.4
297 004	4	32	Pink	0.024	17
297 005	5	32	Tan	0.018	25
297 07.5	7½	32	Brown	0.011	68
297 010	10	32	Red	0.0073	93
297 015	15	32	Blue	0.0045	270
297 020	20	32	Yellow	0.0032	380
297 025	25	32	Natural	0.0023	625
297 030	30	32	Green	0.0018	1130

Tool for fuse removal or replacement 097024.



Reference Dimensions

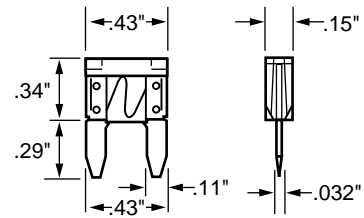

Average Time Current Curves

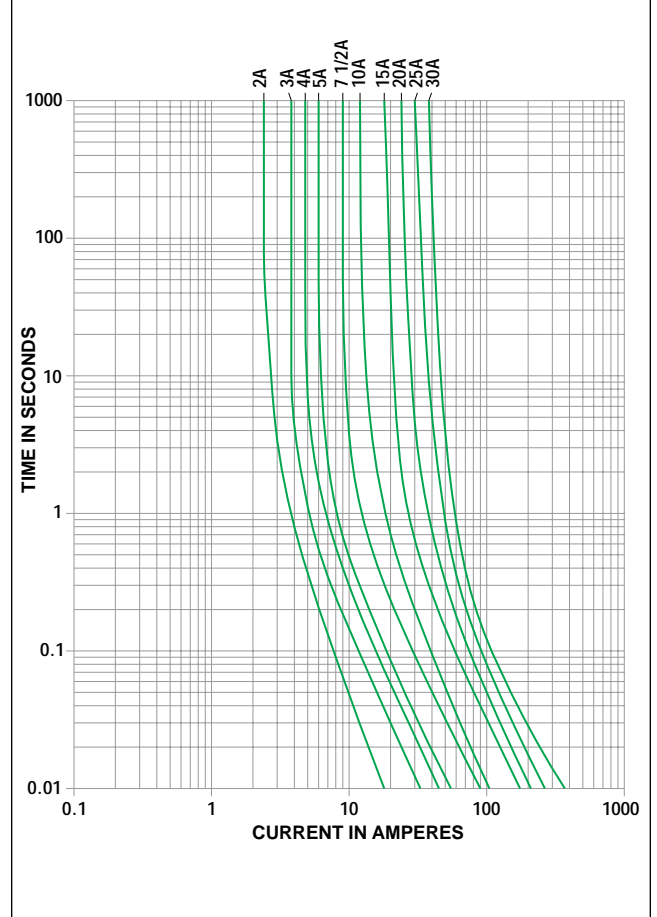

Reference pg. 62 for Mini Fuse P.C. Board fuseholders.