

**Type: LC104**

◆ **Product Description**

- $\phi$  10.7mm Max.(L×W), 5.0mm Max. Height.
- In addition to the typical versions of parameters shown here, custom designs are available to meet your exact requirements.



◆ **Feature**

- Magnetically shielded construction.
- Max. Operating frequency 500kHz. Max. Operating power 1.8W(500kHz)
- Ideally used in Portable equipment, Drive for fluorescent display tube.
- RoHS Compliance

◆ **Dimensions (mm)**

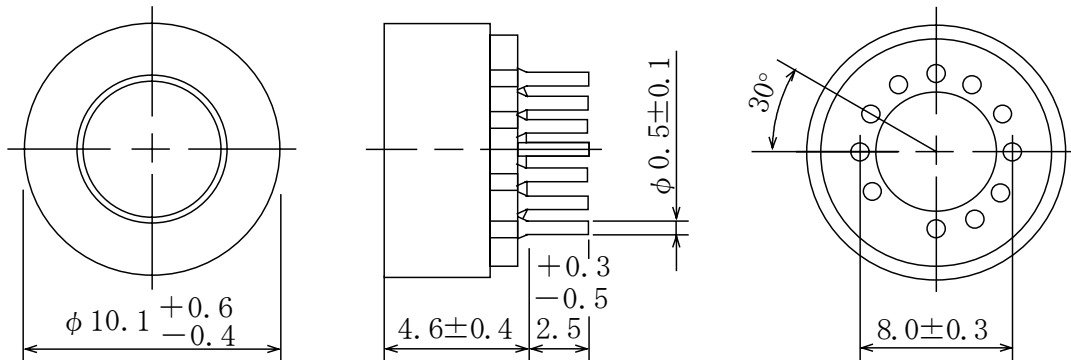

◆ **Schematics (Bottom)**

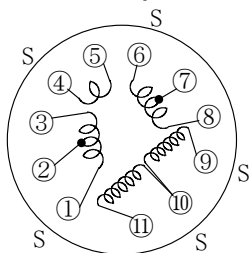

"S" is winding start.

◆ **Specification (LC104)**

Sample No.	Inductance (1-3) 1kHz/1V	Insulation Resistance (Winding-winding) 100Vdc 1min.	Hi-pot Winding-winding 100Vdc 1min./2mA
2362-T011	140 $\mu$ H $\pm$ 30%	100M $\Omega$ Min.	No damage