

TO-3

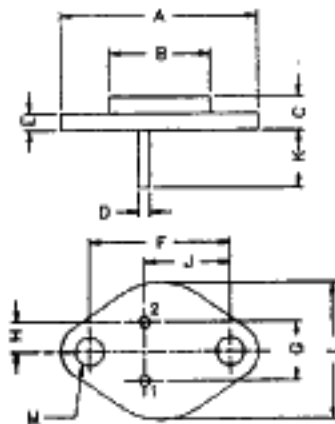

DIM	MIN	MAX
A	—	39,37
B	—	22,22
C	6,35	8,50
D	0,98	1,09
E	—	1,77
F	29,90	30,4
G	10,69	11,18
H	5,20	5,72
J	16,64	17,15
K	11,15	12,25
L	—	26,67
M	3,84	4,19

ALL DIMENSIONS ARE IN M.M.

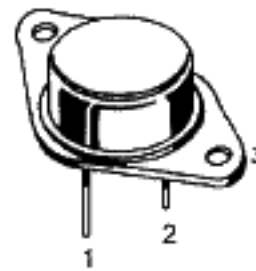

PIN CONFIGURATION
 1. BASE
 2. EMITTER
 3. COLLECTOR

TO-3 Power Package Transistors (NPN)

Type No.	Maximum Ratings						Electrical Characteristics (T _a =25°C, Unless Otherwise Specified)												
	V _{CB0} (V) Min	V _{CE0} (V) Min	V _{EB0} (V) Min	P _D (W) @ T _c =25°C	I _c (A)	I _{CB0} (μA) Max	V _{CB} (V) @	I _{CE0} (μA) Max	V _{CE} (V) @	I _{FE} (A) Min	I _{FE} (A) Max	I _c (A) @ V _{CE} (V)	V _{CE} (V) @ I _c (A)	V _{CE(SAT)} (V) & Max	V _{BE(SAT)} (V) Max	I _c (A) @ V _{CE} (V)	C _{ob} (pF) Max	f _t (MHz) Min	f _t (MHz) Typ
2N3055	100	60	7	117	15			*1000 100		20 70	4 4	4 4	1.1 3		4 10		2.5		500
2N3055HV	100	100	7	90	15			*1000 100	20 100	4 4	4 4	1.1 3		4 10		2.5		500	
2N3055S	100	60	7	90	15			*1000 100	20 100	4 4	4 4	1.1 3		4 10		2.5		500	
2N3773	160	140	7	150	16	2000	140		15 60	8 4	4 4	1.4 4		8 16					
2N4347	140	120	7	100	5			*2000 125	15 60	2 4	4 4	1 2		2 5					500
2N6253	50	45	7	115	15			*2000 55	20 70	3 4	4 4	1.0 4.0		3 15					
2N6257	50	40	5	150	20	4000	50		15 75	8 4	4 4	1.5 4.0		8 20		200			1000
2N6371	50	40	7	117	15				15 60	8 4	4 4	1.5 4.0		8 16		800			1000
2N6371HV	100	100	5	90	15			*2000 45	15 60	8 4	4 4	1.5 4.0		8 16	330	2.5			500
2SC1308	#1500	400	6	50	5			1000 1500	3		4 5	5.0	1.5	4				3	100
2SC1413	1200	500	6	50	5	\$1000	1200					10	2.0	5					
2SC1413A	1500	500	6	50	5	\$1000	1500					10	2.0	5					
2SC1454	300	300	6	50	4	1000	300		20		1 5	1.5 3	1.4 1.6	2.5 4					
2SC1875	150	500	6	50	3.5	20	1000		5 6	35 25	0.5 2	10 10	10 0.8	1.2 1.2	2.5 2.5				
2SC1922	1500	800	6	50	2.5	10	600						5	1.5	2				

#NOTE: V_{CE0}
 *NOTE: I_{CE0}
 \$NOTE: I_{CB0}