

PP3S

SILVER SEAL



9V
IEC 6F22

SECTIONAL PROFILE

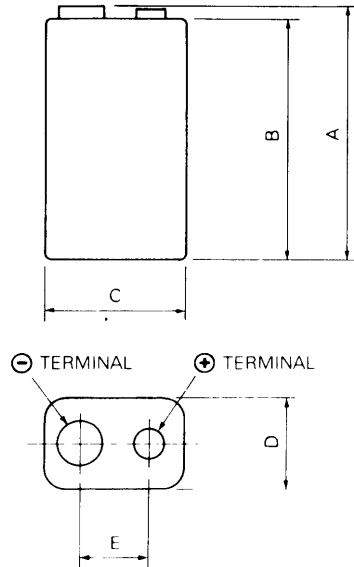

ALL DIMENSIONS IN MILLIMETRES

DIMENSION	IEC		EVER READY	
	MAX	MIN	MAX	MIN
A	48.5	46.5	48.5	46.5
B	46.4		46	
C	26.5	24.5	26.5	24.5
D	17.5	15.5	17.5	15.5
E	12.95	12.45	12.95	12.45

nominal open circuit voltage	9V
maximum open circuit voltage	10.35V
nominal mass	38g
immersed volume	21ml
nominal capacity (at 620 Ω for 2 h/d to 5.4V)	0.40Ah
recommended storage conditions	20° \pm 5°C, not more than 80% R.H.
positive terminal	= miniature snap fastener stud.
negative terminal	= miniature snap fastener socket.
this battery has a metal jacket which is insulated from both terminals.	

TYPICAL SERVICE LIFE AT 20°C

Applications	Test conditions	Standard	Typical service life	
			Initial	1 yr at 20°C
transistor radios	500 Ω for 4 h/d to 5.4V	—	19.0h	17.0h
transistor radios	620 Ω for 2 h/d to 5.4V	IEC	35.0h	31.5h
cassette recorders	180 Ω for 1 h/d to 5.4V	IEC	4.8h	4.3h
calculators	180 Ω for 30 min/d to 4.8V	IEC	10.4h	9.4h
continuous motor	180 Ω continuous to 5.4V	—	2.2h	2.0h

TYPICAL PERFORMANCE DATA AT 20°C
INITIAL DISCHARGE CURVES

The voltage shown is plotted from the on-load voltage obtained at the end of each day's discharge

CONTINUOUS DISCHARGE

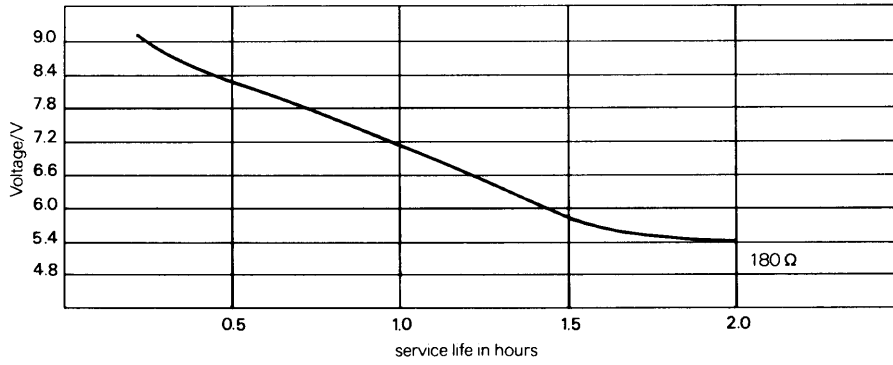

DISCHARGE PERIOD: 4 hours per day

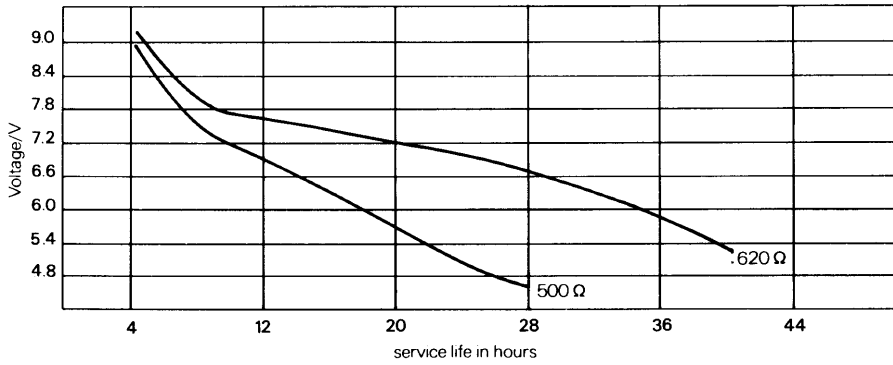

DISCHARGE PERIOD: 30 min/d; 1 hr/d

